

## 15 - AIL /E LED

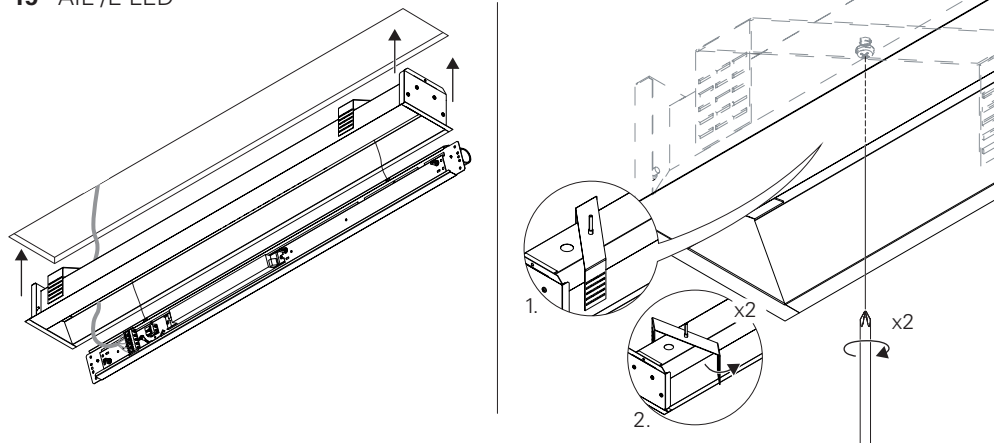

## 16 - AIL /E LED

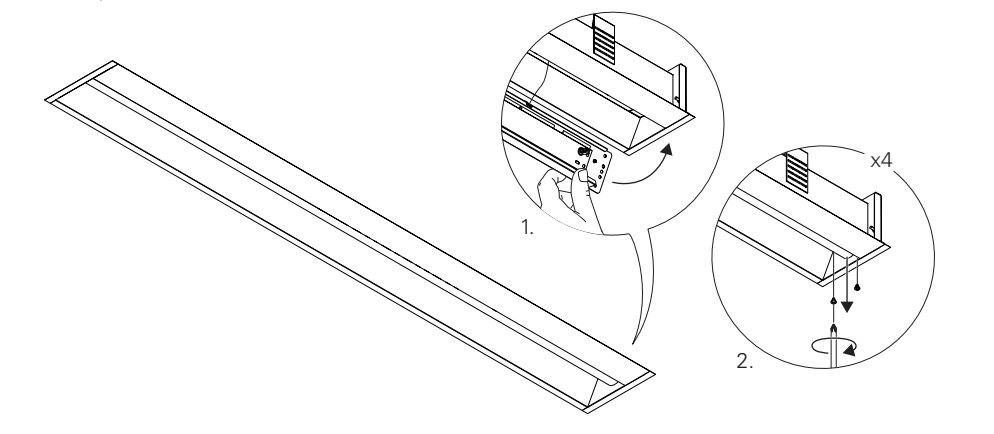

ROXO lighting

MADE IN  
PORTUGAL

## AIL /E LED

**EN** INSTALLATION INSTRUCTIONS  
**FR** INSTRUCTIONS D'INTALLATION  
**DE** INSTALLATIONSANLEITUNG  
**PT** INSTRUÇÕES DE MONTAGEM  
**ES** INSTRUCCIONES DE MONTAJE

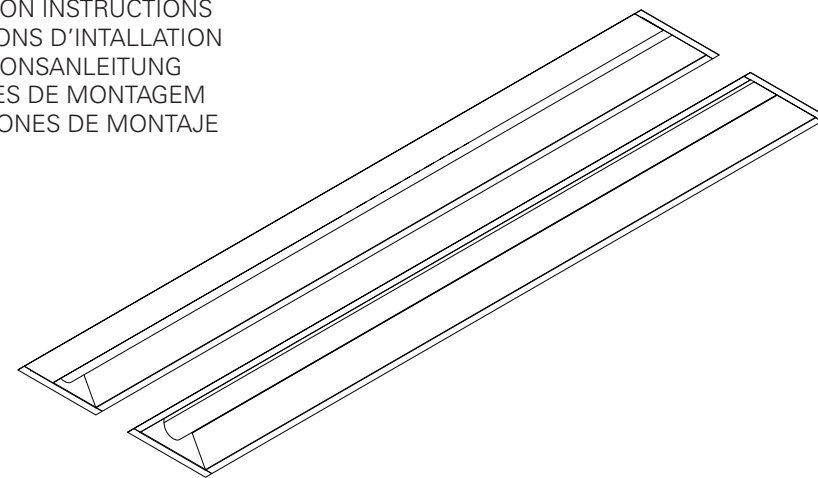

## AIL /E LED



**EN** WARNING: THE LIGHT SOURCE CONTAINED IN THE LUMINAIRE SHOULD BE REPLACED ONLY BY THE MANUFACTURER. DO NOT USE THIS EQUIPMENT IN AREAS CONTAINING CHEMICAL AGENTS: ACIDS, SOLVENTS, PAINTS, SILICONES, COATINGS, ETC.

**FR** AVERTISSEMENT: LA SOURCE DE LUMIÈRE CONTENUE DANS LA LUMINAIRE DOIT ÊTRE REMPLACÉE PAR LE FABRICANT. EN CAS D'ANOMALIE DÉTECTÉE, CONTACTEZ LE FABRICANT. NE PAS UTILISER L'ÉQUIPEMENT DANS LES ZONES QUI CONTIENNENT DES AGENTS CHIMIQUES: ACIDES, SOLVANTS, PEINTURES, SILICONES, VERNIS, ETC.

**DE** WARNUNG: DIE IN DER LEUCHTE ENTHALTEN LICHTQUELLE SOLLTE NUR VOM HERSTELLER ERSETZT WERDEN. VERWENDEN SIE DIESES GERÄT NICHT IN BEREICHEN MIT CHEMISCHEN MITTELN: SÄUREN, LÖSUNGSMITTEL, FARBEN, SILIKONE, BESCHICHTUNGEN ETC.

**PT** ATENÇÃO: A FONTE DE LUZ CONTIDA NA LUMINÁRIA DEVE SER SUBSTITUÍDA UNICAMENTE PELO FABRICANTE. QUALQUER ANOMALIA DETECTADA CONTACTAR O FABRICANTE. NÃO UTILIZAR O EQUIPAMENTO EM ZONAS QUE CONTENHAM AGENTES QUÍMICOS: ÁCIDOS, SOLVENTES, TINTAS, SILICONES, VERNIZES, ETC.

**ES** ATENCIÓN: LA FUENTE DE LUZ CONTENIDA EN LA LUMINARIA DEBE SER SUSTITUIDA ÚNICAMENTE POR EL FABRICANTE. CUALQUIER ANOMALÍA DETECTADA CONTACTAR CON EL FABRICANTE. NO UTILIZAR

LA LUMINARIA EN ZONAS QUE CONTENGAN AGENTES QUÍMICOS: ÁCIDOS, DISOLVENTES, PINTURAS, SILICONAS, BARNICES, ETC."

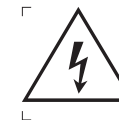

**EN** CAUTION, RISK OF ELECTRIC SHOCK.

**FR** ATTENTION, RISQUE DE CHOC ÉLECTRIQUE.

**DE** ACHTUNG, GEFAHR EINES STROMSCHLAGS.

**PT** CUIDADO, RISCO DE CHOQUE ELÉTRICO.

**ES** PRECAUCIÓN, RIESGO DE DESCARGA ELÉCTRICA.



**EN** LUMINAIRE CAN NOT BE COVERED WITH THERMAL INSULATION.

**FR** LUMINAIRES NE POUVANT PAS ÊTRE RECOUVERTS DE MATÉRIAUX ISOLANT THERMIQUE.

**DE** LEUCHTE DIE NICHT MIT THERMISCH ISOLIERENDEN MATERIAL BEDECKT SEIN KANN.

**PT** LUMINÁRIA QUE NÃO PODE SER COBERTA COM MATERIAL ISOLANTE TÉRMICO.

**ES** LA LUMINARIA NO PUEDE SER CUBIERTA CON MATERIAL AISLANTE TÉRMICO.



**EN** Read carefully the general terms and conditions of use and environmental concern with recycling attached. | **FR** Lire attentivement les conditions générales d'utilisations et de préoccupation environnementales avec les recyclage ci-joint. | **DE** Bitte lesen Sie die Allgemeinen Geschäftsbedingungen und Umweltbewusstsein über Recycling angeschlossen. | **PT** Ler atentamente as condições gerais uso e preocupação ambiental com a reciclagem em anexo. | **ES** Lea atentamente las condiciones generales de uso y preocupación ambiental con el reciclaje adjuntos.

**EN** We reserve the right to make changes on technical specifications, design and installation leaflet without prior notice. | **FR** Sous réserve de modifications au niveau de la conception, des spécifications techniques et de la notice. | **DE** Änderungen von Entwurf, technischen Daten und Bedienungsanleitungen bleiben vorbehalten. | **PT** O fabricante reserva-se no direito de realizar modificações no desenho, especificações técnicas e folheto, sem aviso prévio. | **ES** El fabricante se reserva el derecho de realizar modificaciones en el diseño, las especificaciones técnicas y el folleto.

## AIL /E LED ACM

**EN** VERSION WITH SYMMETRIC REFLECTOR  
**FR** VERSION AVEC REFLECTEUR SYMETRIQUE  
**DE** VERSION MIT SYMMETRISCHEN REFLECTOR  
**PT** VERSÃO COM REFLETOR SIMÉTRICO  
**ES** VERSIÓN CON REFLECTOR SIMÉTRICO

(mm)  
 614x149x107 597x130  
 1174x149x107 1157x130  
 1734x149x107 1717x130

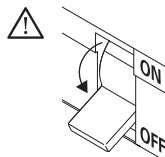

### 1 - AIL /E LED

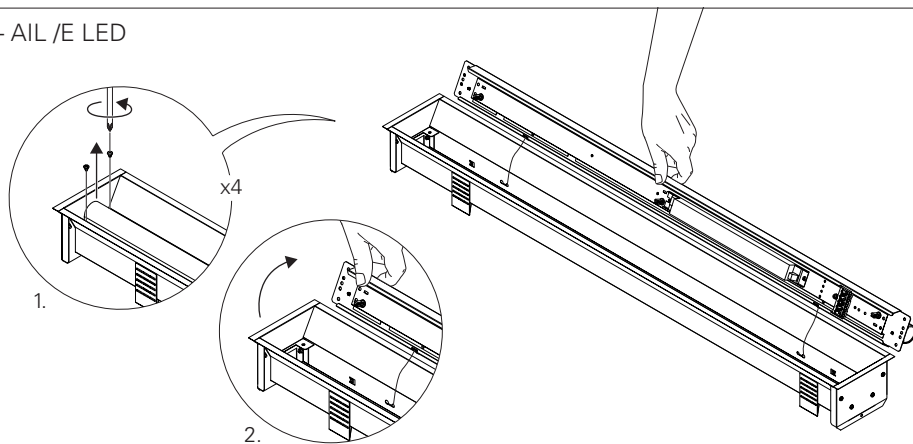

### 2 - AIL /E LED

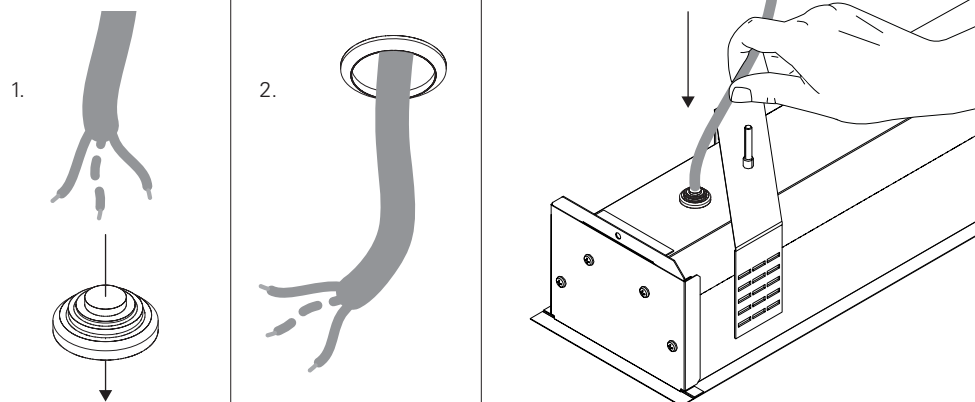

### 13 - AIL /E LED HF + EM + TEL.

POWER SUPPLY HF WITH EMERGENCY KIT AND TELECOMMAND  
 CABLAGE HF AVEC UNITE DE SECOURS ET TELECOMMANDE  
 VERDRAHTUNG FÜR HF MIT NOTLICHTEINSATZ UND TELEKOMMAND  
 ALIMENTAÇÃO ELÉCTRICA HF COM KIT EMERGÊNCIA E TELECOMANDO  
 ELECTRIFICACIÓN HF CON KIT DE EMERGENCIA Y TELEMANDABLE

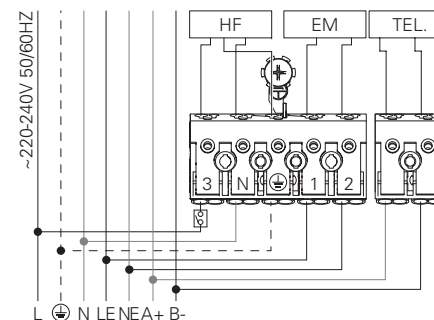

BLUE - N (NEUTRAL)  
 GREEN AND YELLOW - (EARTH)  
 BROWN - L (LIVE)  
 GREY - LE (EMERGENCY LIVE)  
 BLACK - NE (EMERGENCY NEUTRAL)  
 RED - A+  
 BLACK - B-

BLEU - N (NEUTRE)  
 VERT ET JAUNE - (TERRE)  
 MARRON - L (PHASE)  
 GRIS - LE (UNI. SECOURS PHASE)  
 NOIR - NE (UNI. SECOURS NEUTRE)  
 ROUGE - A+  
 NOIR - B-

AZUL - N (NEUTRO)  
 VERDE E AMARELO - (TERRA)  
 CASTANHO - L (FASE)  
 CINZA - LE (EMERGÊNCIA FASE)  
 PRETO - NE (EMERGÊNCIA NEUTRO)  
 VERMELHO - A+  
 PRETO - B-

AZUL - N (NEUTRAL)  
 VERDE Y AMARILLO - (TIERRA)  
 MARRÓN - L (FASE)  
 GRIS - LE (EMERGÊNCIA FASE)  
 NEGRO - NE (EMERGENCIA NEUTRAL)  
 ROJO - A+  
 NEGRO - B-

### 14 - ROFY /E LED DALI + EM + TEL.

POWER SUPPLY HF WITH EMERGENCY KIT AND TELECOMMANDE  
 CABLAGE HF AVEC UNITE DE SECOURS ET TELECOMMANDE  
 VERDRAHTUNG FÜR HF MIT NOTLICHTEINSATZ UND TELEKOMMAND  
 ALIMENTAÇÃO ELÉCTRICA HF COM KIT EMERGÊNCIA E TELECOMANDO  
 ELECTRIFICACIÓN HF CON KIT DE EMERGENCIA Y TELEMANDABLE

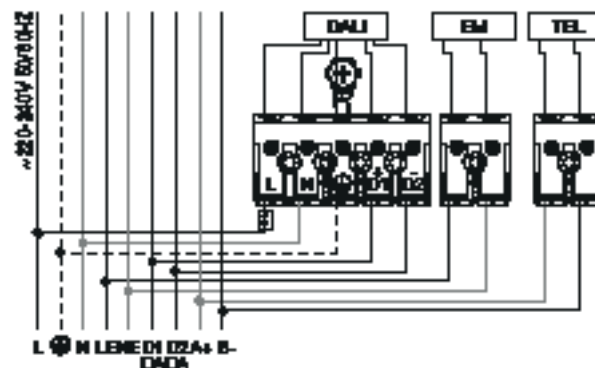

BLUE - N (NEUTRAL)  
 GREEN AND YELLOW - (EARTH)  
 BROWN - L (LIVE)  
 GREY - D1+  
 BLACK - D2-  
 BLUE - NE (EMERGENCY NEUTRAL)  
 BROWN - LE (EMERGENCY LIVE)  
 RED - A+  
 BLACK - B-

BLEU - N (NEUTRE)  
 VERT ET JAUNE - (TERRE)  
 MARRON - L (PHASE)  
 GRIS - D1+  
 NOIR - D2-  
 BLEU - NE (UNI. SECOURS NEUTRE)  
 MARRON - LE (UNI. SECOURS PHASE)  
 ROUGE - A+  
 NOIR - B-

BLAU - N (NEUTRAL)  
 GRÜN UND GELB - (ERDE)  
 BRAUN - L (PHASE)  
 GRAU - D1+  
 SCHWARZ - D2-  
 BLAU - NE (NOTLICHT NEUTRAL)  
 BRAUN - LE (NOTLICHT PHASE)  
 ROT - A+  
 SCHWARZ - B-

AZUL - N (NEUTRO)  
 VERDE E AMARELO - (TERRA)  
 CASTANHO - L (FASE)  
 CINZA - D1+  
 PRETO - D2-  
 AZUL - NE (EMERGÊNCIA NEUTRO)  
 CASTANHO - LE (EMERGÊNCIA FASE)  
 VERMELHO - A+  
 PRETO - B-

AZUL - N (NEUTRAL)  
 VERDE Y AMARILLO - (TIERRA)  
 MARRÓN - L (FASE)  
 GRIS - D1+  
 NEGRO - D2-  
 AZUL - NE (EMERGENCIA NEUTRAL)  
 MARRÓN - LE (EMERGENCIA FASE)  
 ROJO - A+  
 NEGRO - B-

## 10 - AIL /E LED

1.



2.

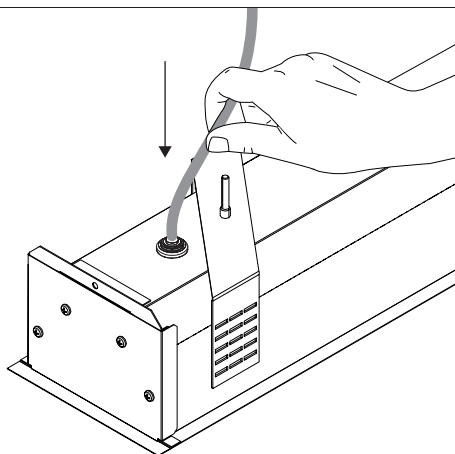
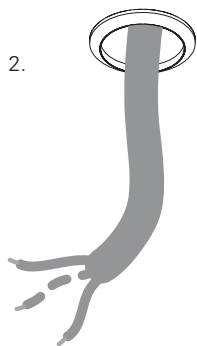

## 11 - AIL /E LED

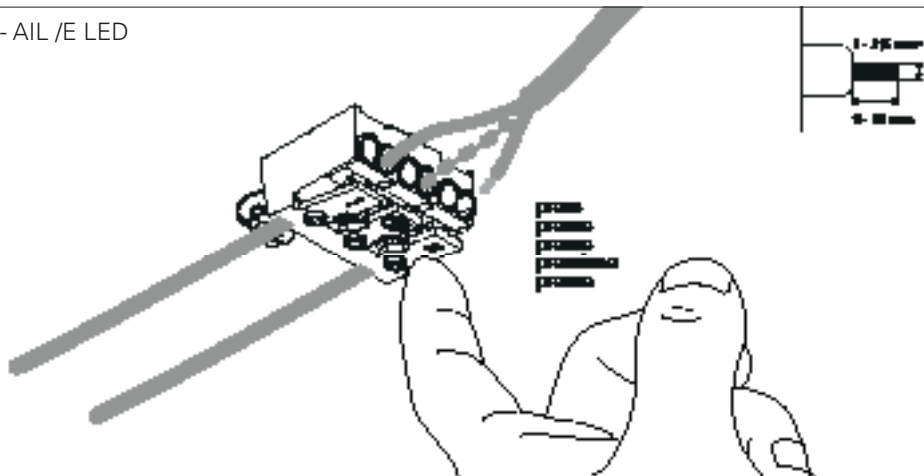

## 12 - AIL /E LED HF

STANDARD POWER SUPPLY  
CÂBLAGE STRANDARD  
STANDARD VERDRAHTUNG  
ALIMENTAÇÃO ELÉCTRICA STANDARD  
ELECTRIFICACIÓN ESTÁNDAR

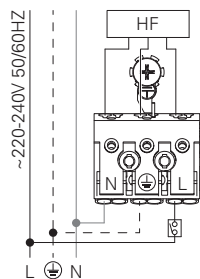

### DALI

DIMMABLE POWER SUPPLY  
CÂBLAGE AVEC GRADATION  
DIMMBARE VERDRAHTUNG  
ALIMENTAÇÃO ELÉCTRICA COM REGULAÇÃO  
ELECTRIFICACIÓN CON REGULACIÓN

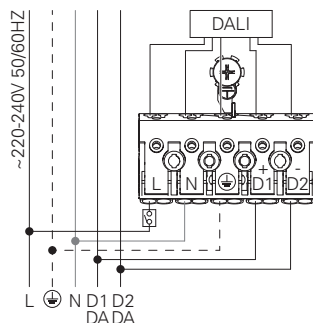

BLUE - N (NEUTRAL)  
GREEN AND YELLOW - ⊕ (EARTH)  
BROWN - L (LIVE)  
GREY - D1+  
BLACK - D2-

BLEU - N (NEUTRE)  
VERT ET JAUNE - ⊕ (TERRE)  
MARRON - L (PHASE)  
GRIS - D1+  
NOIR - D2-

BLAU - N (NEUTRAL)  
GRÜN UND GELB - ⊕ (ERDE)  
BRAUN - L (PHASE)  
GRAU - D1+  
SCHWARZ - D2-

AZUL - N (NEUTRO)  
VERDE E AMARELO - ⊕ (TIERRA)  
CASTANHO - L (FASE)  
CINZA - D1+  
PRETO - D2-

AZUL - N (NEUTRAL)  
VERDE Y AMARILLO - ⊕ (TIERRA)  
MARRÓN - L (FASE)  
GRIS - D1+  
NEGRO - D2-

## 3 - AIL /E LED

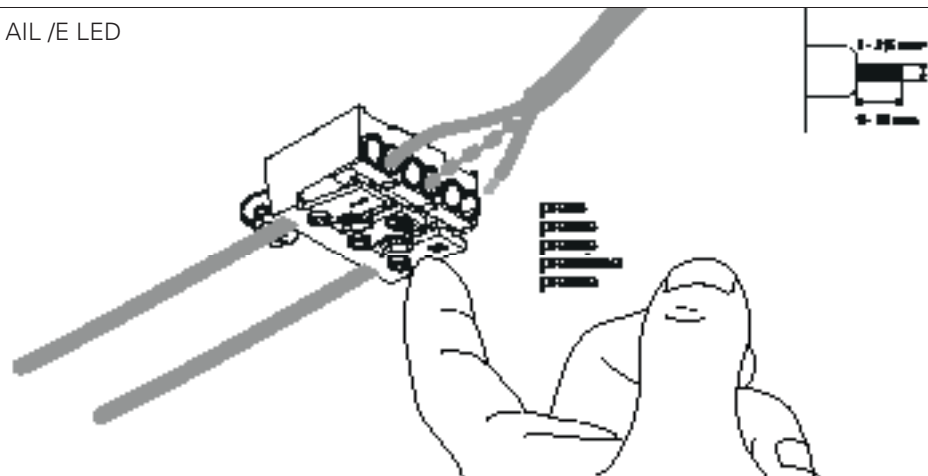

## 4 - AIL /E LED HF

STANDARD POWER SUPPLY  
CÂBLAGE STRANDARD  
STANDARD VERDRAHTUNG  
ALIMENTAÇÃO ELÉCTRICA STANDARD  
ELECTRIFICACIÓN ESTÁNDAR

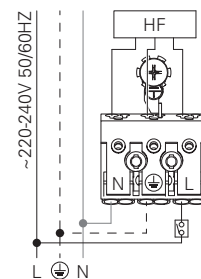

### DALI

DIMMABLE POWER SUPPLY  
CÂBLAGE AVEC GRADATION  
DIMMBARE VERDRAHTUNG  
ALIMENTAÇÃO ELÉCTRICA COM REGULAÇÃO  
ELECTRIFICACIÓN CON REGULACIÓN

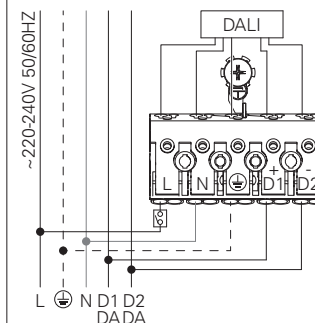

BLUE - N (NEUTRAL)  
GREEN AND YELLOW - ⊕ (EARTH)  
BROWN - L (LIVE)  
GREY - D1+  
BLACK - D2-

BLEU - N (NEUTRE)  
VERT ET JAUNE - ⊕ (TERRE)  
MARRON - L (PHASE)  
GRIS - D1+  
NOIR - D2-

BLAU - N (NEUTRAL)  
GRÜN UND GELB - ⊕ (ERDE)  
BRAUN - L (PHASE)  
GRAU - D1+  
SCHWARZ - D2-

AZUL - N (NEUTRO)  
VERDE E AMARELO - ⊕ (TIERRA)  
CASTANHO - L (FASE)  
CINZA - D1+  
PRETO - D2-

AZUL - N (NEUTRAL)  
VERDE Y AMARILLO - ⊕ (TIERRA)  
MARRÓN - L (FASE)  
GRIS - D1+  
NEGRO - D2-

## 5 - AIL /E LED HF + EM + TEL.

POWER SUPPLY HF WITH EMERGENCY KIT AND TELECOMMAND  
CÂBLAGE HF AVEC UNITE DE SECOURS ET TELECOMMANDE  
VERDRAHTUNG FÜR HF MIT NOTLICHTEINSATZ UND TELEKOMMANDE  
ALIMENTAÇÃO ELÉCTRICA HF COM KIT EMERGENCIA E TELECOMANDO  
ELECTRIFICACIÓN HF CON KIT DE EMERGENCIA Y TELEMANDABLE

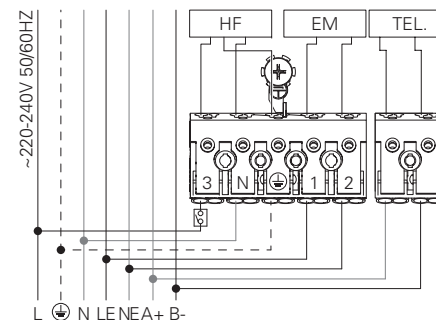

BLUE - N (NEUTRAL)  
GREEN AND YELLOW - ⊕ (EARTH)  
BROWN - L (LIVE)  
GREY - LE (EMERGENCY LIVE)  
BLACK - NE (EMERGENCY NEUTRAL)  
RED - A+  
BLACK - B-

BLEU - N (NEUTRE)  
VERT ET JAUNE - ⊕ (TERRE)  
MARRON - L (PHASE)  
GRIS - LE (UNI. SECOURS PHASE)  
NOIR - NE (UNI. SECOURS NEUTRE)  
ROUGE - A+  
NOIR - B-

BLAU - N (NEUTRAL)  
GRÜN UND GELB - ⊕ (ERDE)  
BRAUN - L (PHASE)  
GRAU - LE (NOTLICHT PHASE)  
SCHWARZ - NE (NOTLICHT NEUTRAL)  
ROT - A+  
SCHWARZ - B-

AZUL - N (NEUTRO)  
VERDE E AMARELO - ⊕ (TIERRA)  
CASTANHO - L (FASE)  
CINZA - LE (EMERGENCIA FASE)  
PRETO - NE (EMERGENCIA NEUTRO)  
VERMELHO - A+  
PRETO - B-

AZUL - N (NEUTRAL)  
VERDE Y AMARILLO - ⊕ (TIERRA)  
MARRÓN - L (FASE)  
GRIS - LE (EMERGENCIA FASE)  
NEGRO - NE (EMERGENCIA NEUTRAL)  
ROJO - A+  
NEGRO - B-

## 6 - AIL /E LED DALI + EM + TEL.

POWER SUPPLY HF WITH EMERGENCY KIT AND TELECOMMAND  
CABLAGE HF AVEC UNITE DE SECOURS ET TELECOMMANDE  
VERDRAHTUNG FÜR HF MIT NOTLICHTEINSATZ UND TELEKOMMAND  
ALIMENTAÇÃO ELÉCTRICA HF COM KIT EMERGÊNCIA E TELECOMANDO  
ELECTRIFICACIÓN HF CON KIT DE EMERGENCIA Y TELEMANDABLE

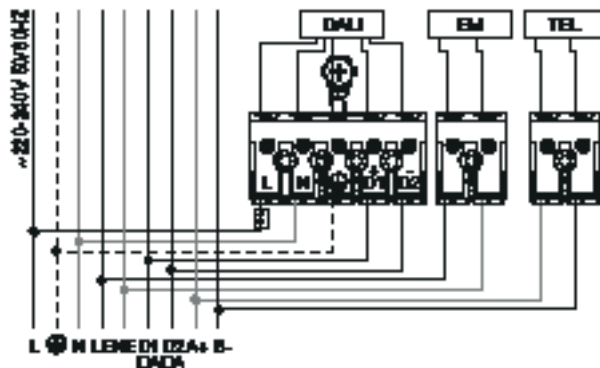

BLUE - N (NEUTRAL)  
GREEN AND YELLOW - ⊕ (EARTH)  
BROWN - L (LIVE)  
GREY - D1+  
BLACK - D2-  
BLUE - NE (EMERGENCY NEUTRAL)  
BROWN - LE (EMERGENCY LIVE)  
RED - A+  
BLACK - B-

BLEU - N (NEUTRE)  
VERT ET JAUNE - ⊕ (TERRE)  
MARRON - L (PHASE)  
GRIS - D1+  
NOIR - D2-  
BLEU - NE (UNI.SECOURS NEUTRE)  
MARRON - LE (UNI. SECOURS PHASE)  
ROUGE - A+  
NOIR - B-

BLAU - N (NEUTRAL)  
GRÜN UND GELB - ⊕ (ERDE)  
BRAUN - L (PHASE)  
GRAU - D1+  
SCHWARZ - D2-  
BLAU - NE (NOTLICHT NEUTRAL)  
BRAUN - LE (NOTLICHT PHASE)  
ROT - A+  
SCHWARZ - B-

AZUL - N (NEUTRO)  
VERDE E AMARELO - ⊕ (TERRA)  
CASTANHO - L (FASE)  
CINZA - D1+  
PRETO - D2-  
AZUL - NE (EMERGÊNCIA NEUTRO)  
CASTANHO - LE (EMERGÊNCIA FASE)  
VERMELHO - A+  
PRETO - B-

AZUL - N (NEUTRAL)  
VERDE Y AMARILLO - ⊕ (TIERRA)  
MARRÓN - L (FASE)  
GRIS - D1+  
NEGRO - D2-  
AZUL - NE (EMERGENCIA NEUTRAL)  
MARRÓN - LE (EMERGENCIA FASE)  
ROJO - A+  
NEGRO - B-

## 7 - AIL /E LED

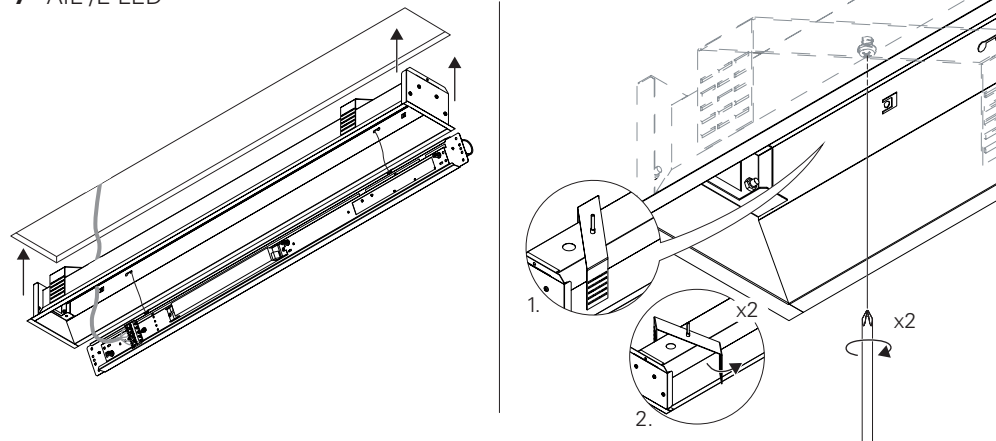

## 8 - AIL /E LED

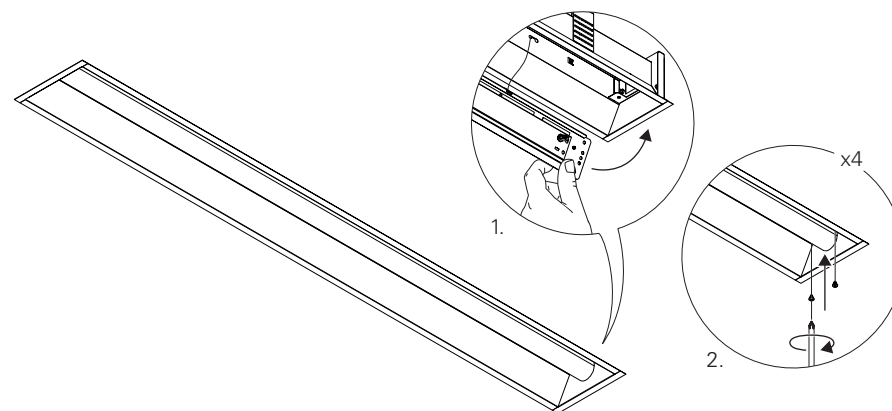

## AIL /E LED AWM

**EN** VERSION WITH ASYMMETRIC REFLECTOR  
**FR** VERSION AVEC REFLECTEUR ASYMETRIQUE  
**DE** VERSION MIT ASYMMETRISCHEM REFLECTOR  
**PT** VERSÃO COM REFLETOR ASSIMÉTRICO  
**ES** VERSIÓN CON REFLECTOR ASIMÉTRICO

(mm)	
614x149x107	597x130
1174x149x107	1157x130
1734x149x107	1717x130

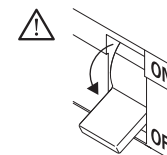

## 9 - AIL /E LED

