

BATU Sq

EN INSTALLATION INSTRUCTIONS
FR INSTRUCTIONS D'INTALLATION
DE INSTALLATIONSANLEITUNG
PT INSTRUÇÕES DE MONTAGEM
ES INSTRUCCIONES DE MONTAJE

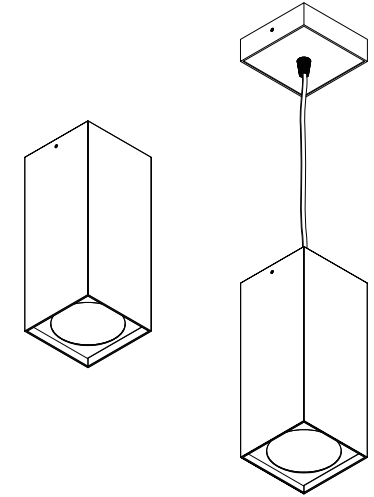

BATU Sq

CE P20 230V/50Hz



EN WARNING: THE LIGHT SOURCE CONTAINED IN THE LUMINAIRE SHOULD BE REPLACED ONLY BY THE MANUFACTURER. DO NOT USE THIS EQUIPMENT IN AREAS CONTAINING CHEMICAL AGENTS: ACIDS, SOLVENTS, PAINTS, SILICONES, COATINGS, ETC.

FR AVERTISSEMENT: LA SOURCE DE LUMIÈRE CONTENUE DANS LA LUMINAIRE DOIT ÊTRE REMPLACÉE PAR LE FABRICANT. EN CAS D'ANOMALIE DÉTECTÉE, CONTACTEZ LE FABRICANT. NE PAS UTILISER L'ÉQUIPEMENT DANS LES ZONES QUI CONTIENNENT DES AGENTS CHIMIQUES: ACIDES, SOLVANTS, PEINTURES, SILICONES, VERNIS, ETC.

DE WARNUNG: DIE IN DER LEUCHTE ENTHALTEN LICHTQUELLE SOLLTE NUR VOM HERSTELLER ERSETZT WERDEN. VERWENDEN SIE DIESES GERÄT NICHT IN BEREICHEN MIT CHEMISCHEN MITTELN: SAUREN, LÖSUNGSMITTEL, FARBEN, SILKONE, BESCHICHTUNGEN ETC.

PT ATENÇÃO: A FONTE DE LUZ CONTIDA NA LUMINÁRIA DEVE SER SUBSTITUÍDA UNICAMENTE PELO FABRICANTE. QUALQUER ANOMALIA DETECTADA CONTACTAR O FABRICANTE. NÃO UTILIZAR O EQUIPAMENTO EM ZONAS QUE CONTENHAM AGENTES QUÍMICOS: ÁCIDOS, SOLVENTES, TINTAS, SILICONES, VERNIZES, ETC.

ES ATENCIÓN: LA FUENTE DE LUZ CONTENIDA EN LA LUMINARIA DEBE SER SUSTITUIDA ÚNICAMENTE POR EL FABRICANTE. CUALQUIER ANOMALÍA DETECTADA CONTACTAR CON EL FABRICANTE. NO UTILIZAR

LA LUMINARIA EN ZONAS QUE CONTENGAN AGENTES QUÍMICOS: ÁCIDOS, DISOLVENTES, PINTURAS, SILICONAS, BARNICES, ETC.”



EN Read carefully the general terms and conditions of use and environmental concern with recycling attached. | **FR** Lire attentivement les conditions générales d'utilisations et de préoccupation environnementales avec les recyclage ci-joint. | **DE** Bitte lesen Sie de Allgemeinen Geschäftsbedingungen und Umweltbewusstsein über Recycling angeschlossen. | **PT** Ler atentamente as condições gerais de uso e preocupação ambiental com a reciclagem, em anexo. | **ES** Lea atentamente las condiciones generales de uso y preocupación ambiental con el reciclaje adjuntos.

EN We reserve the right to make changes on technical specifications, design and installation leaflet without prior notice. | **FR** Sous réserve de modifications au niveau de la conception, des spécifications techniques et de la notice. | **DE** Änderungen von Entwurf, technischen Daten und Bedienungsanleitungen bleiben vorbehalten. | **PT** O fabricante reserva-se no direito de realizar modificações no desenho, especificações técnicas e folheto, sem aviso prévio. | **ES** El fabricante se reserva el derecho de realizar modificaciones en el diseño, las especificaciones técnicas y el folleto.

BATU Sq



EN SURFACE MOUNTED VERSION

FR VERSION SAILLIE

DE AUFBAUVERSION

PT VERSÃO SALIENTE

ES VERSIÓN DE SUPERFICIE

 (mm)
ø95x150
ø95x230
ø95x310

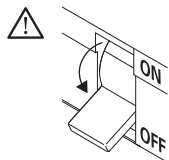

1 - BATU Sq

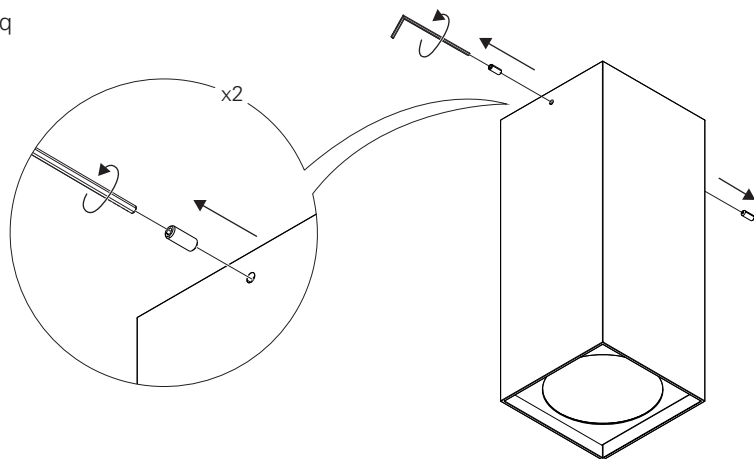

2 - BATU Sq

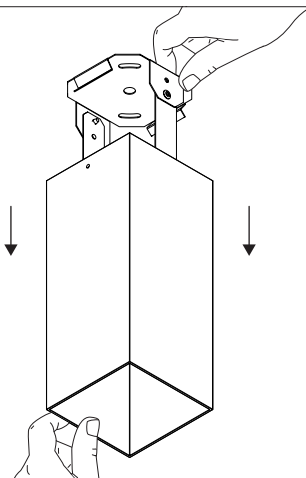

26 - BATU Sq

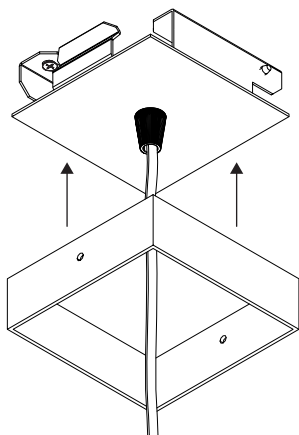

27 - BATU Sq

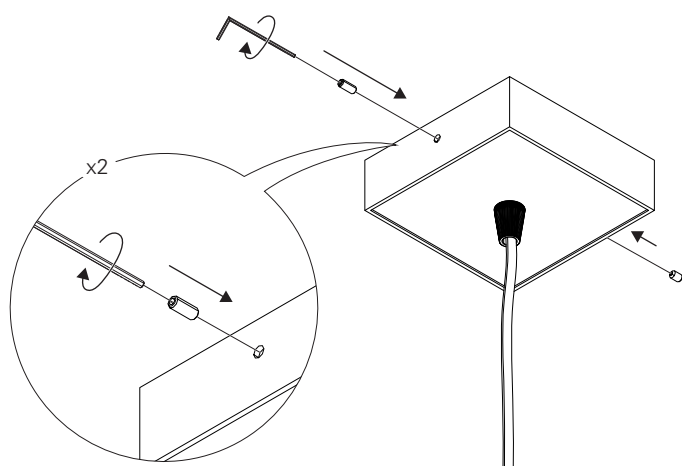

3 - BATU Sq

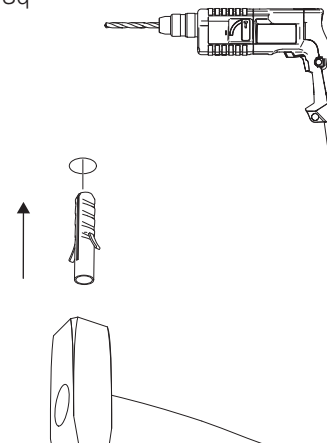

4 - BATU Sq

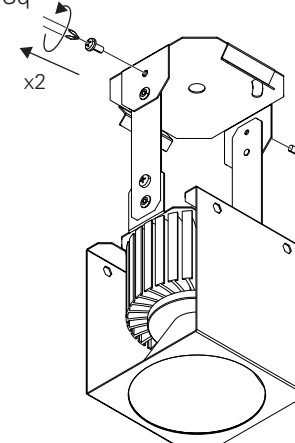

5 - BATU Sq

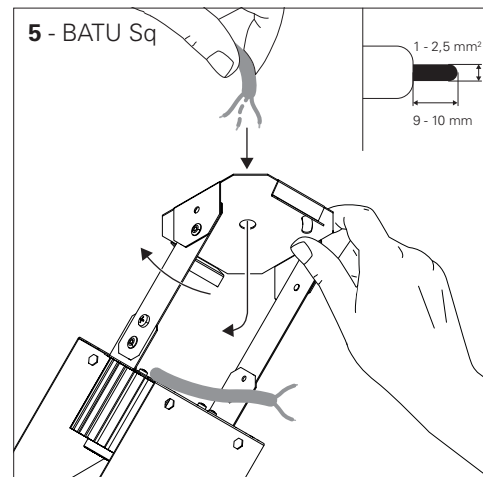

6 - BATU Sq

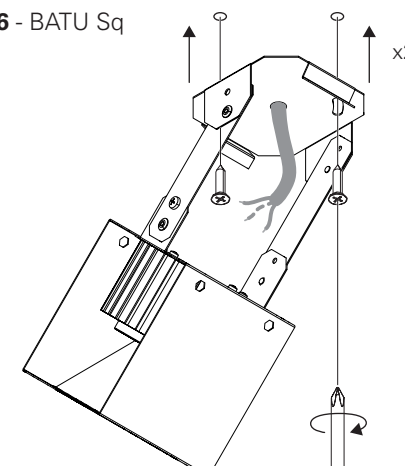

7 - BATU Sq

STANDARD POWER SUPPLY
CÂBLAGE STRANDARD
STANDARD VERDRAHTUNG
ALIMENTAÇÃO ELECTRICA STANDARD
ELECTRIFICACIÓN ESTÁNDAR

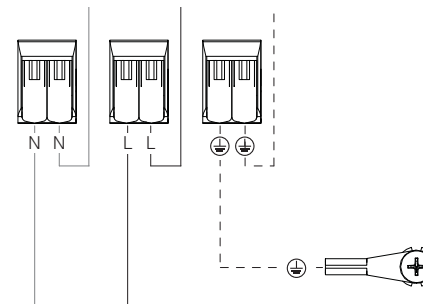

BLUE - N (NEUTRAL)
GREEN AND YELLOW - ⊕ (EARTH)
BROWN - L (LIVE)

BLEU - N (NEUTRE)
VERT ET JAUNE - ⊕ (TERRE)
MARRON - L (PHASE)

BLAU - N (NEUTRAL)
GRÜN UND GELB - ⊕ (ERDE)
BRAUN - L (PHASE)

AZUL - N (NEUTRO)
VERDE E AMARELO - ⊕ (TERRA)
CASTANHO - L (FASE)

AZUL - N (NEUTRAL)
VERDE Y AMARILLO - ⊕ (TIERRA)
MARRÓN - L (FASE)

8 - BATU Sq

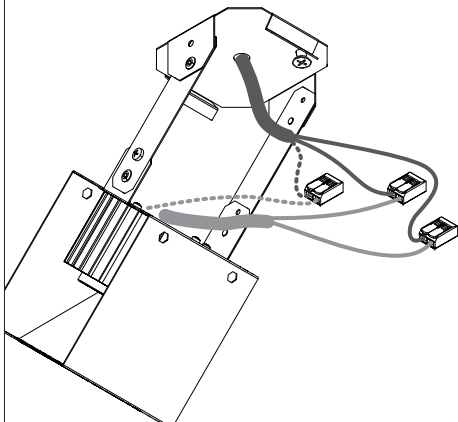

9 - BATU Sq

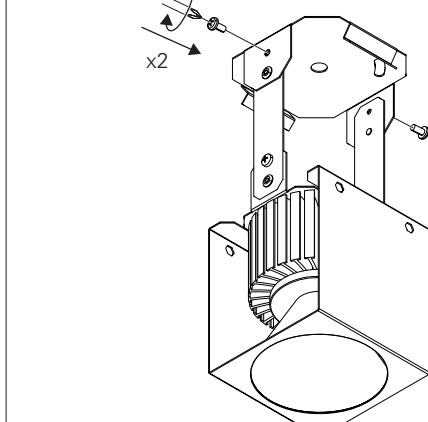

10 - BATU Sq

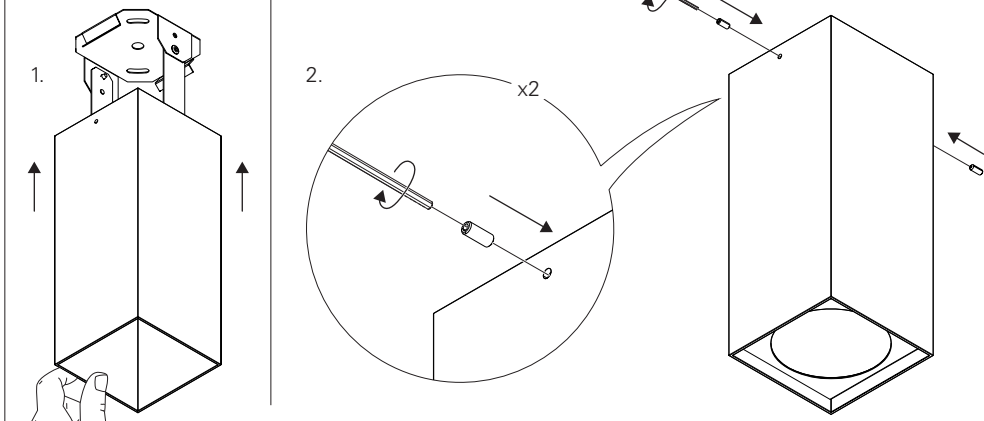

BATU Sq

EN SUSPENDED VERSION
FR VERSION SUSPENDU
DE PENDELVERSION
PT VERSÃO SUSPensa
ES VERSIÓN SUSPENDIDO

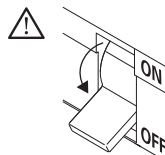

22 - BATU Sq

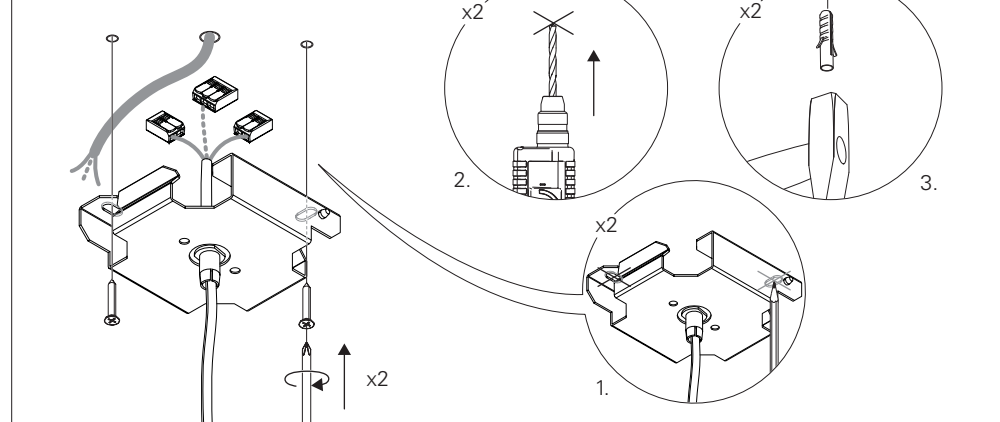

23 - BATU Sq

STANDARD POWER SUPPLY
 CÂBLAGE STANDARD
 STANDARD VERDRAHTUNG
 ALIMENTAÇÃO ELÉCTRICA STANDARD
 ELECTRIFICACIÓN ESTÁNDAR

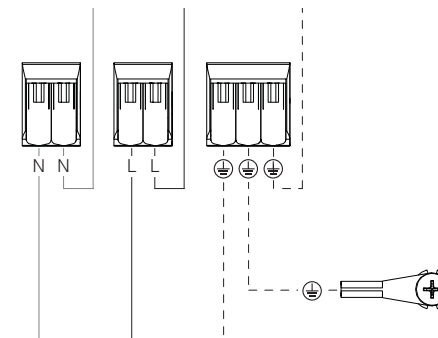

BLUE - N (NEUTRAL)
 GREEN AND YELLOW - ⊕ (EARTH)
 BROWN - L (LIVE)
 BLEU - N (NEUTRE)
 VERT ET JAUNE - ⊕ (TERRE)
 MARRON - L (PHASE)
 BLAU - N (NEUTRAL)
 GRÜN UND GELB - ⊕ (ERDE)
 BRAUN - L (PHASE)
 AZUL - N (NEUTRO)
 VERDE E AMARELO - ⊕ (TERRA)
 CASTANHO - L (FASE)
 AZUL - N (NEUTRAL)
 VERDE Y AMARILLO - ⊕ (TIERRA)
 MARRÓN - L (FASE)

24 - BATU Sq

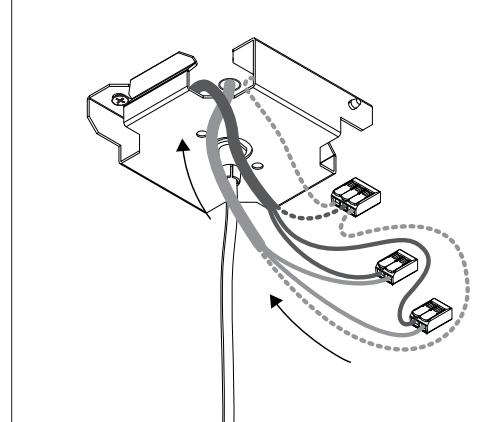

25 - BATU Sq

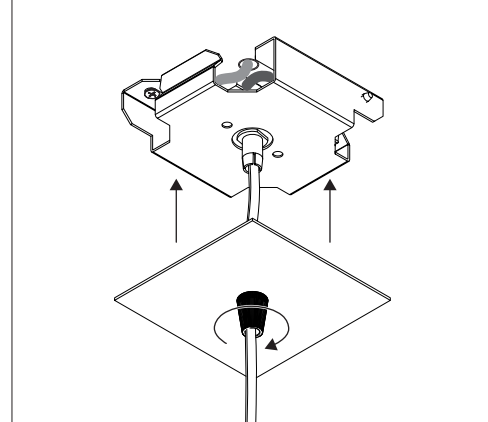

BATU Sq

SURFACE MOUNTED CEILING ROSE OPTION
OPTION PATÈRE DE SUSPENSION SILLIE
OPTIONEN AUFBAU DECKENBALDACHIN
OPÇÃO CAIXA DE ALIMENTAÇÃO SALIENTE
OPCIÓN BASE DE TECHO DE SUPERFICIE

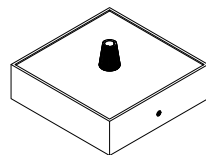

SUSPENDED VERSION OPTION
OPTION VERSION SUSPENDU
OPTIONEN PENDELVERSION
OPÇÃO VERSÃO SUSPensa
OPCIÓN VERSIÓN SUSPENDIDO

CEILING ROSE OPTION
OPTION PATÈRE DE SUSPENSION
OPTIONEN DECKENBALDACHIN
OPÇÃO CAIXA DE ALIMENTAÇÃO
OPCIÓN BASE DE TECHO

CURRENT SUPPLY CABLE
CABLE D'ALIMENTATION
EINSPEISUNGSKABEL
CABO DE ALIMENTAÇÃO
CABLE DE ALIMENTACIÓN

Recessed or surface mounted
Encastré ou en saillie
Vertieft oder hervorstehen
Encastrar ou saliente
Empotrar o superficie

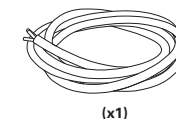
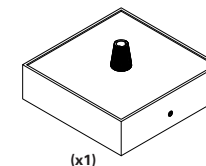
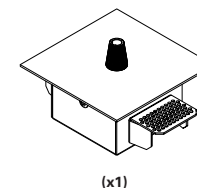

19 - BATU Sq

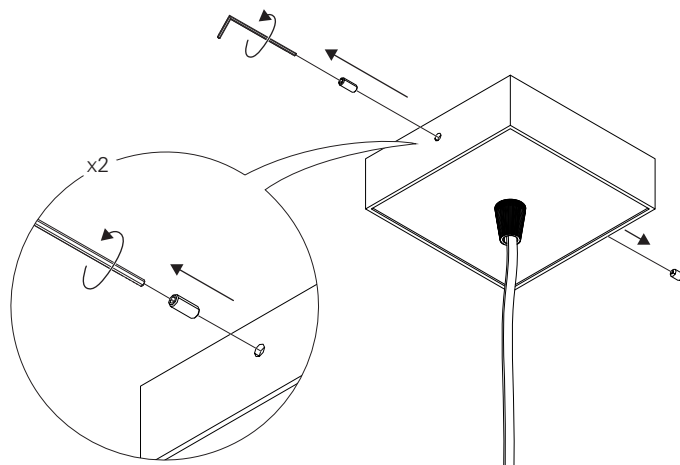

BATU Sq

RECESSED CEILING ROSE OPTION
OPTION PATÈRE DE SUSPENSION ENCASTRÉE
OPTIONEN EINBAU DECKENBALDACHIN
OPÇÃO CAIXA DE ALIMENTAÇÃO DE ENCASTRADA
OPCIÓN BASE DE TECHO DE EMPOTRAR

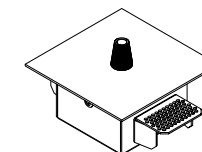

20 - BATU Sq

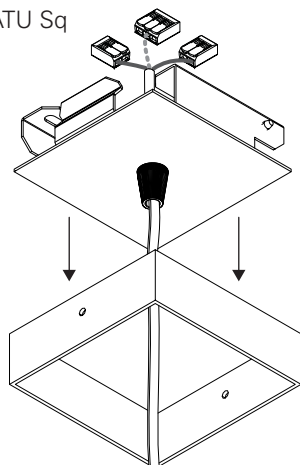

21 - BATU Sq

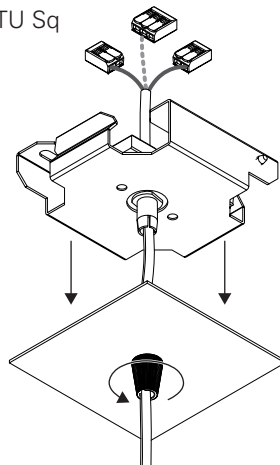

11 - BATU Sq

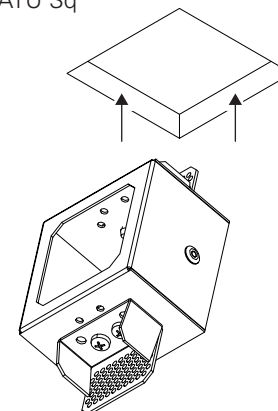

12 - BATU Sq

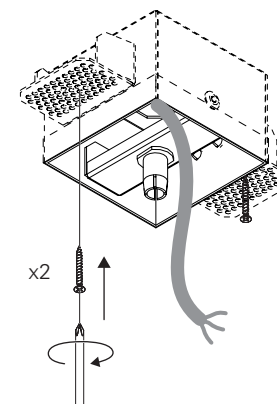

13 - BATU Sq

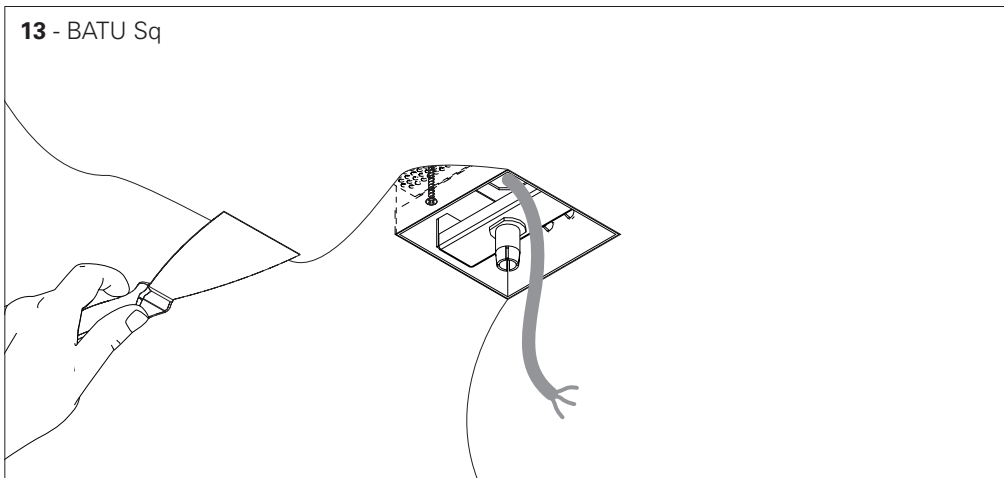

14 - BATU Sq

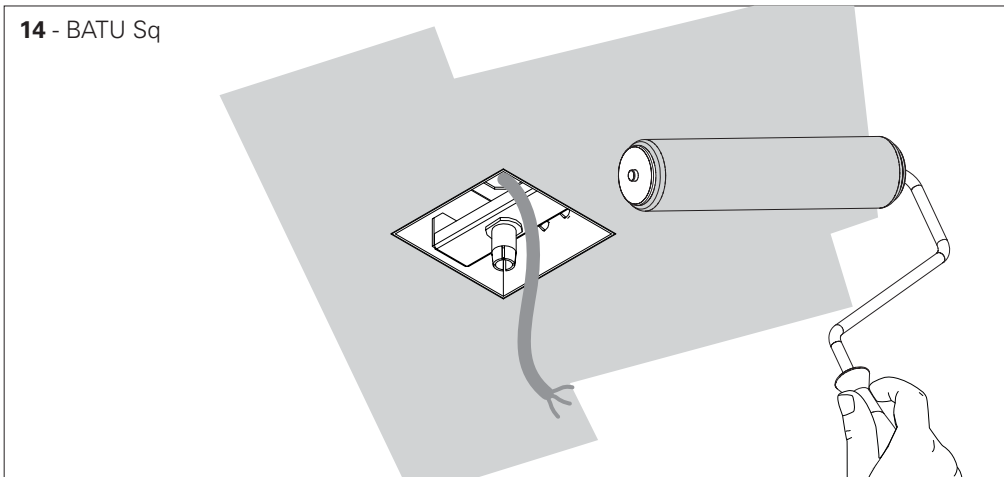

15 - BATU Sq

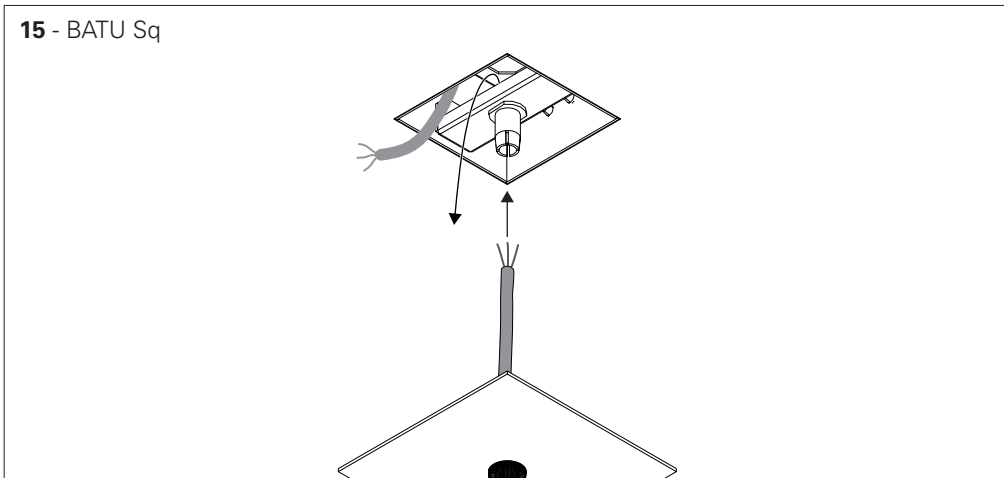

16 - BATU Sq

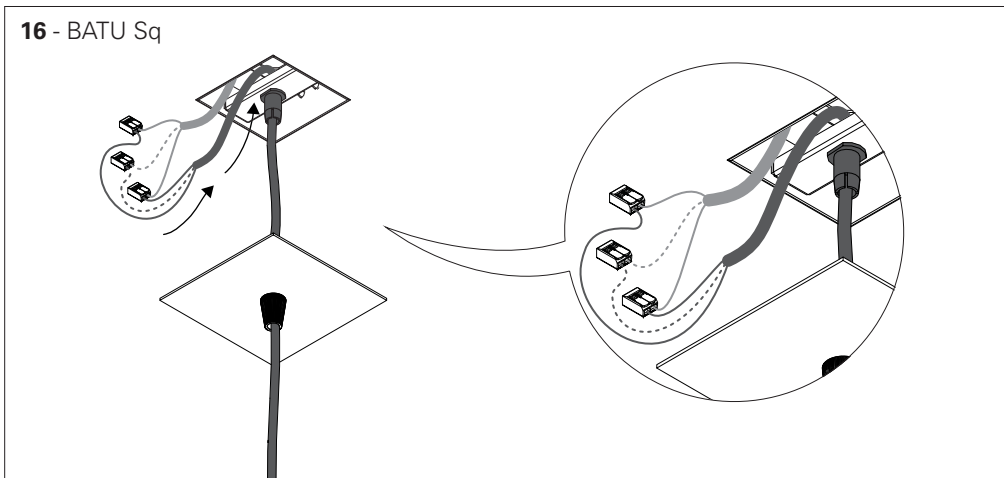

17 - BATU Sq

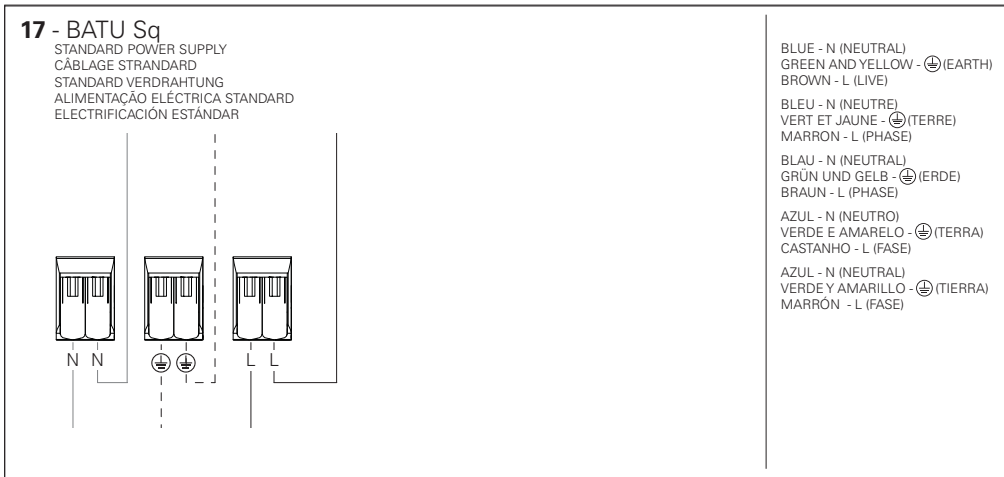

18 - BATU Sq

