

BATU

EN INSTALLATION INSTRUCTIONS
FR INSTRUCTIONS D'INTALLATION
DE INSTALLATIONSANLEITUNG
PT INSTRUÇÕES DE MONTAGEM
ES INSTRUCCIONES DE MONTAJE

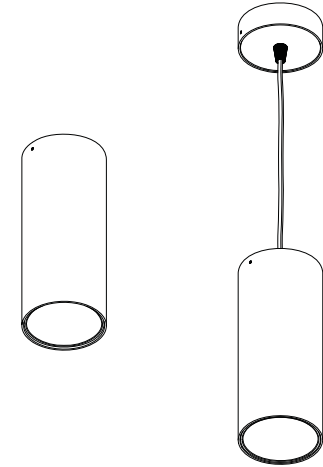

BATU

CE  P20  d0.5m  230V/50Hz



EN WARNING: THE LIGHT SOURCE CONTAINED IN THE LUMINAIRE SHOULD BE REPLACED ONLY BY THE MANUFACTURER. DO NOT USE THIS EQUIPMENT IN AREAS CONTAINING CHEMICAL AGENTS: ACIDS, SOLVENTS, PAINTS, SILICONES, COATINGS, ETC.

FR AVERTISSEMENT: LA SOURCE DE LUMIÈRE CONTENUE DANS LA LUMINAIRE DOIT ÊTRE REMPLACÉE PAR LE FABRICANT. EN CAS D'ANOMALIE DÉTECTÉE, CONTACTEZ LE FABRICANT. NE PAS UTILISER L'ÉQUIPEMENT DANS LES ZONES QUI CONTIENNENT DES AGENTS CHIMIQUES: ACIDES, SOLVANTS, PEINTURES, SILICONES, VERNIS, ETC.

DE WARNUNG: DIE IN DER LEUCHTE ENTHALTEN LICHTQUELLE SOLLTE NUR VOM HERSTELLER ERSETZT WERDEN. VERWENDEN SIE DIESES GERÄT NICHT IN BEREICHEN MIT CHEMISCHEN MITTELN: SAUREN, LÖSUNGSMITTEL, FARBEN, SILIKONE, BESCHICHTUNGEN ETC.

PT ATENÇÃO: A FONTE DE LUZ CONTIDA NA LUMINÁRIA DEVE SER SUBSTITUÍDA UNICAMENTE PELO FABRICANTE. QUALQUER ANOMALIA DETECTADA CONTACTAR O FABRICANTE. NÃO UTILIZAR O EQUIPAMENTO EM ZONAS QUE CONTENHAM AGENTES QUÍMICOS: ÁCIDOS, SOLVENTES, TINTAS, SILICONES, VERNIZES, ETC.

ES ATENCIÓN: LA FUENTE DE LUZ CONTENIDA EN LA LUMINARIA DEBE SER SUSTITUIDA ÚNICAMENTE POR EL FABRICANTE. CUALQUIER ANOMALÍA DETECTADA CONTACTAR CON EL FABRICANTE. NO UTILIZAR

LA LUMINARIA EN ZONAS QUE CONTENGAN AGENTES QUÍMICOS: ÁCIDOS, DISOLVENTES, PINTURAS, SILICONAS, BARNICES, ETC.”



EN Read carefully the general terms and conditions of use and environmental concern with recycling attached. | **FR** Lire attentivement les conditions générales d'utilisations et de préoccupation environnementales avec les recyclage ci-joint. | **DE** Bitte lesen Sie de Allgemeinen Geschäftsbedingungen und Umweltbewusstsein über Recycling angeschlossen. | **PT** Ler atentamente as condições gerais de uso e preocupação ambiental com a reciclagem, em anexo. | **ES** Lea atentamente las condiciones generales de uso y preocupación ambiental con el reciclaje adjuntos.

EN We reserve the right to make changes on technical specifications, design and installation leaflet without prior notice. | **FR** Sous réserve de modifications au niveau de la conception, des spécifications techniques et de la notice. | **DE** Änderungen von Entwurf, technischen Daten und Bedienungsanleitungen bleiben vorbehalten. | **PT** O fabricante reserva-se no direito de realizar modificações no desenho, especificações técnicas e folheto, sem aviso prévio. | **ES** El fabricante se reserva el derecho de realizar modificaciones en el diseño, las especificaciones técnicas y el folleto.

BATU



EN SURFACE MOUNTED VERSION

FR VERSION SAILLIE

DE AUFBAUVERSION

PT VERSÃO SALIENTE

ES VERSIÓN DE SUPERFICIE

 (mm)
ø95x150
ø95x230
ø95x310

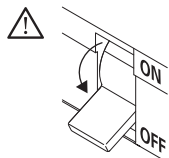

1 - BATU

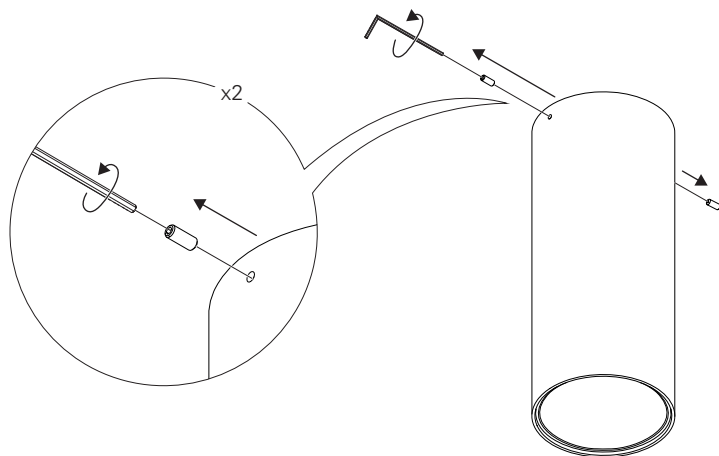

2 - BATU

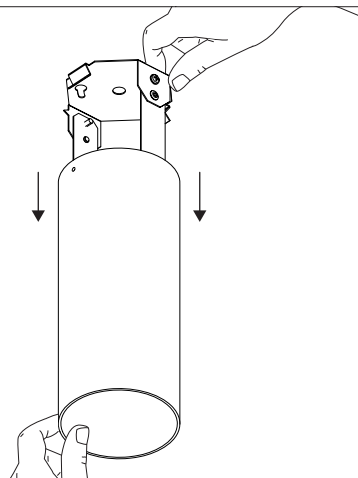

26 - BATU

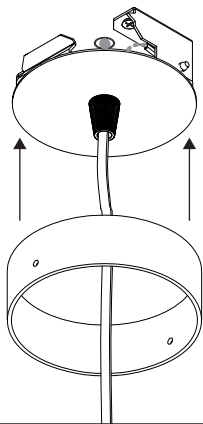

27 - BATU

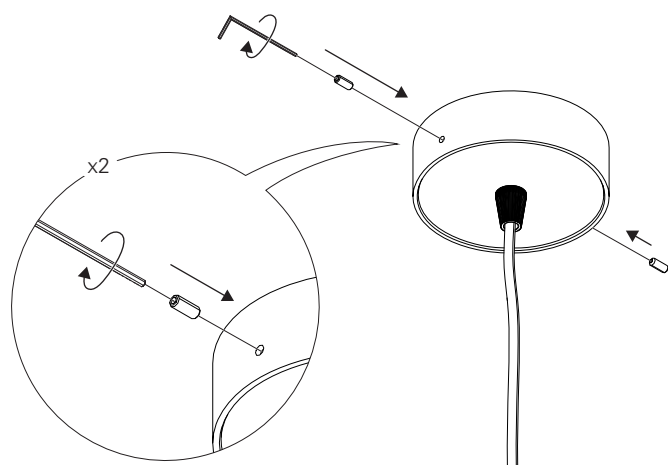

3 - BATU

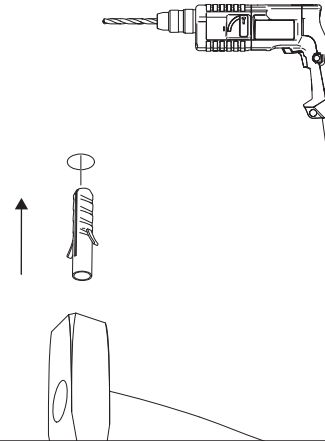

4 - BATU

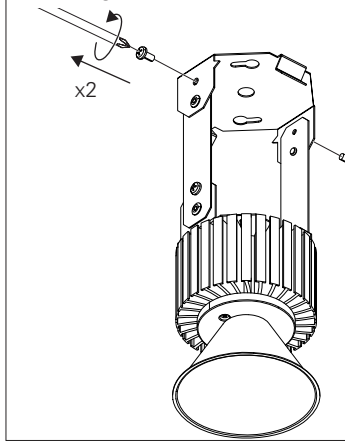

5 - BATU

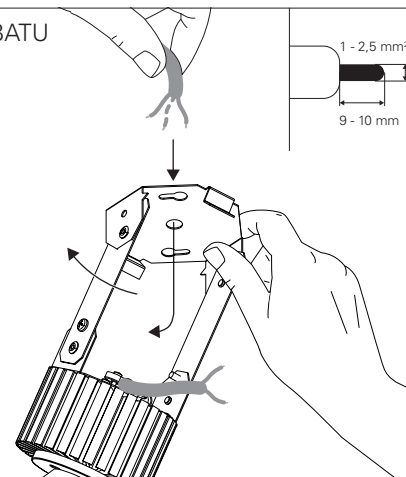

6 - BATU

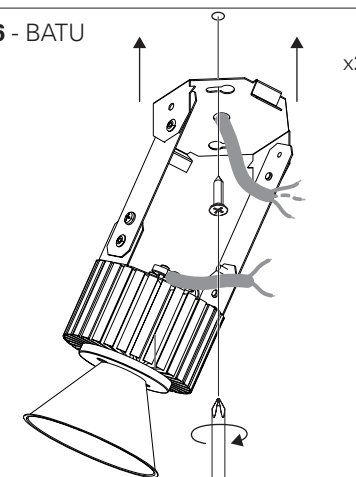

7 - BATU

STANDARD POWER SUPPLY
CÂBLAGE STANDAR
STANDARD VERDRÄHTUNG
ALIMENTAÇÃO ELÉCTRICA STANDARD
ELECTRIFICACIÓN ESTÁNDAR

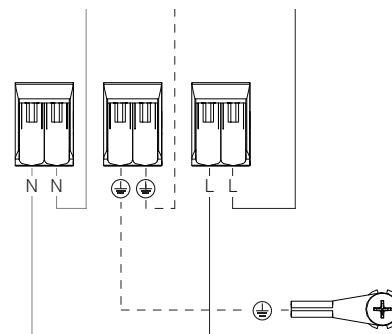

BLUE - N (NEUTRAL)
GREEN AND YELLOW - ⊕ (EARTH)
BROWN - L (LIVE)

BLEU - N (NEUTRE)
VERT ET JAUNE - ⊕ (TERRE)
MARRON - L (PHASE)

BLAU - N (NEUTRAL)
GRÜN UND GELB - ⊕ (ERDE)
BRAUN - L (PHASE)

AZUL - N (NEUTRO)
VERDE E AMARELO - ⊕ (TERRA)
CASTANHO - L (FASE)

AZUL - N (NEUTRAL)
VERDE Y AMARILLO - ⊕ (TIERRA)
MARRÓN - L (FASE)

8 - BATU

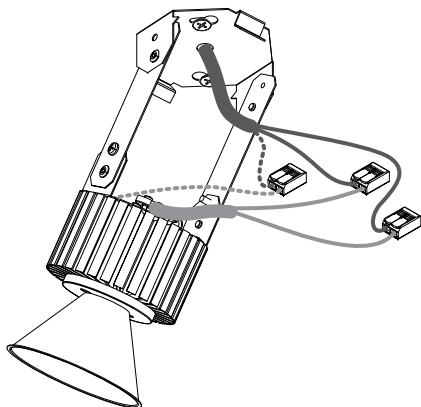

9 - BATU

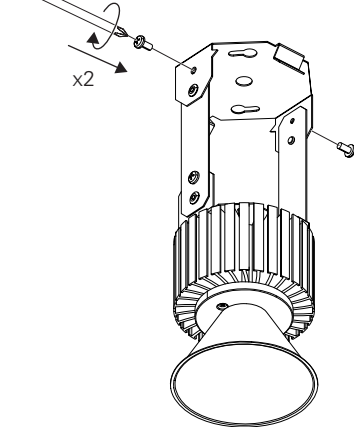

10 - BATU

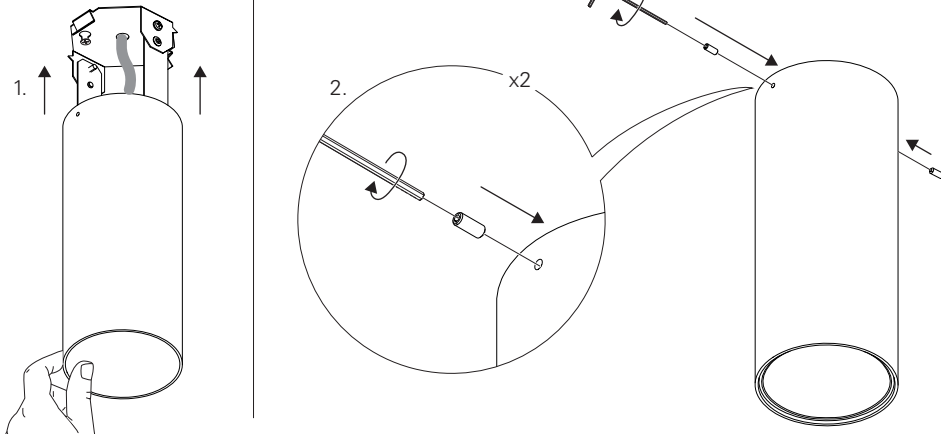

BATU

EN SUSPENDED VERSION
FR VERSION SUSPENDU
DE PENDELVERSION
PT VERSÃO SUSPensa
ES VERSIÓN SUSPENDIDO

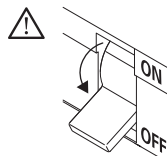

22 - BATU

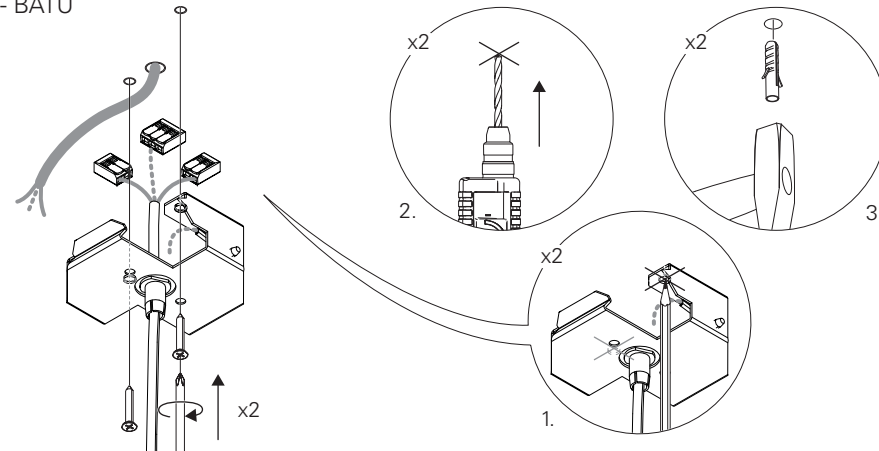

23 - BATU

STANDARD POWER SUPPLY
 CÂBLAGE STRANDARD
 STANDARD VERDRAHTUNG
 ALIMENTAÇÃO ELECTRICA STANDARD
 ELECTRIFICACION ESTÁNDAR

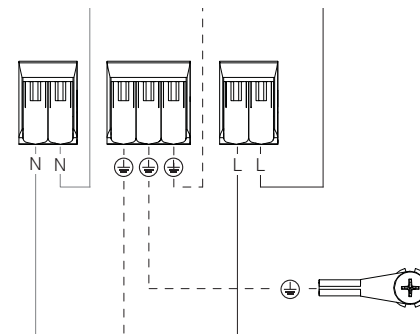

BLUE - N (NEUTRAL)
 GREEN AND YELLOW - ⊕ (EARTH)
 BROWN - L (LIVE)
 BLEU - N (NEUTRE)
 VERT ET JAUNE - ⊕ (TERRE)
 MARRON - L (PHASE)
 BLAU - N (NEUTRAL)
 GRÜN UND GELB - ⊕ (ERDE)
 BRAUN - L (PHASE)
 AZUL - N (NEUTRO)
 VERDE E AMARELO - ⊕ (TERRA)
 CASTANHO - L (FASE)
 AZUL - N (NEUTRAL)
 VERDE Y AMARILLO - ⊕ (TIERRA)
 MARRÓN - L (FASE)

24 - BATU

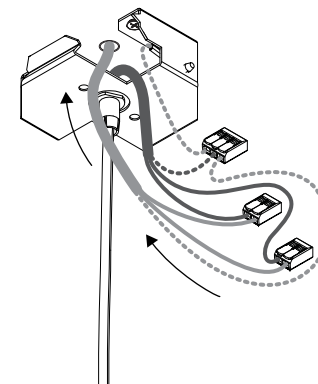

25 - BATU

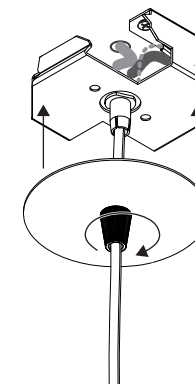

BATU

SURFACE MOUNTED CEILING ROSE OPTION
OPTION PATÈRE DE SUSPENSION SILLIE
OPTIONEN AUFBAU DECKENBALDACHIN
OPÇÃO CAIXA DE ALIMENTAÇÃO SALIENTE
OPCIÓN BASE DE TECHO DE SUPERFICIE

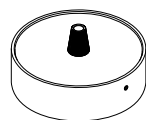

19 - BATU

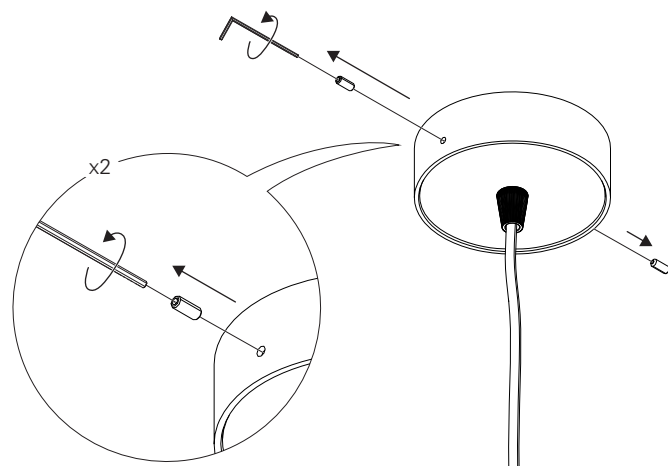

20 - BATU

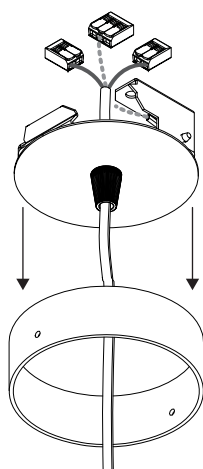

21 - BATU

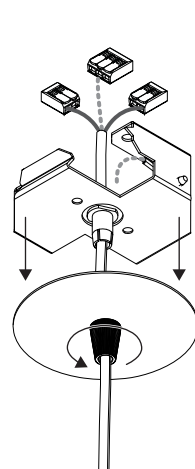

SUSPENDED VERSION OPTION
OPTION VERSION SUSPENDU
OPTIONEN PENDELVERSION
OPÇÃO VERSÃO SUSPensa
OPCIÓN VERSIÓN SUSPENDIDO

CEILING ROSE OPTION
OPTION PATÈRE DE SUSPENSION
OPTIONEN DECKENBALDACHIN
OPÇÃO CAIXA DE ALIMENTAÇÃO
OPCIÓN BASE DE TECHO

CURRENT SUPPLY CABLE
CÂBLE D'ALIMENTATION
EINSPEISUNGSKABEL
CABO DE ALIMENTAÇÃO
CABLE DE ALIMENTACIÓN

Recessed or surface mounted
Encastré ou en saillie
Vertieft oder hervorstehen
Encastrar ou saliente
Empotrar o superficie

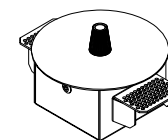

(x1)

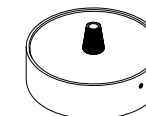

(x1)



(x1)

BATU

RECESSED CEILING ROSE OPTION
OPTION PATÈRE DE SUSPENSION ENCASTRÉE
OPTIONEN EINBAU DECKENBALDACHIN
OPÇÃO CAIXA DE ALIMENTAÇÃO DE ENCASTRADA
OPCIÓN BASE DE TECHO DE EMPOTRAR

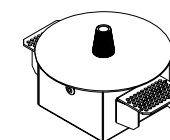

11 - BATU

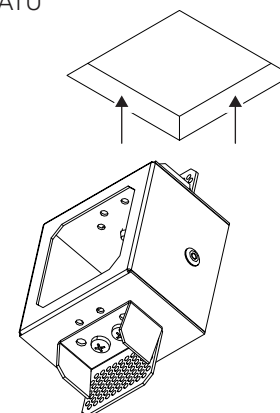

12 - BATU

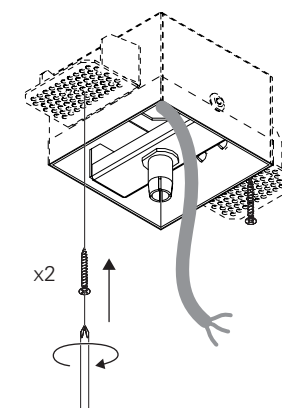

13 - BATU

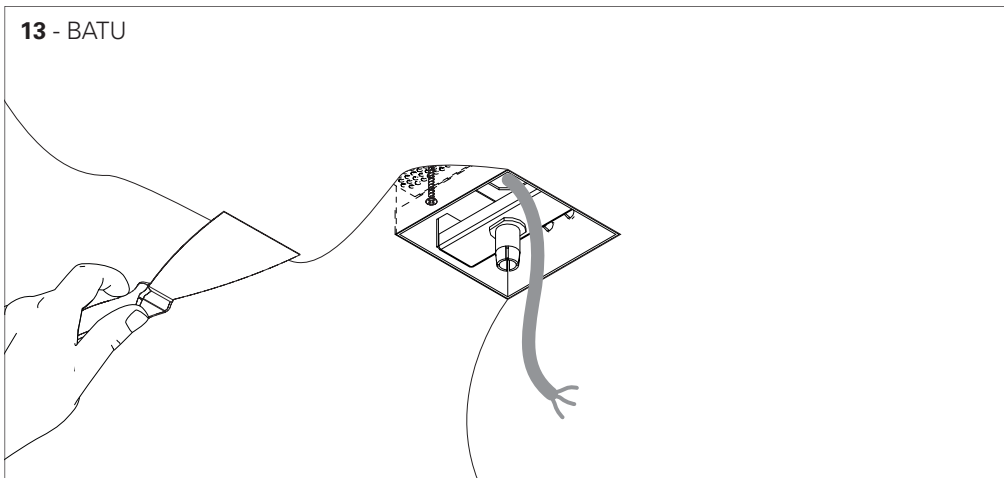

14 - BATU

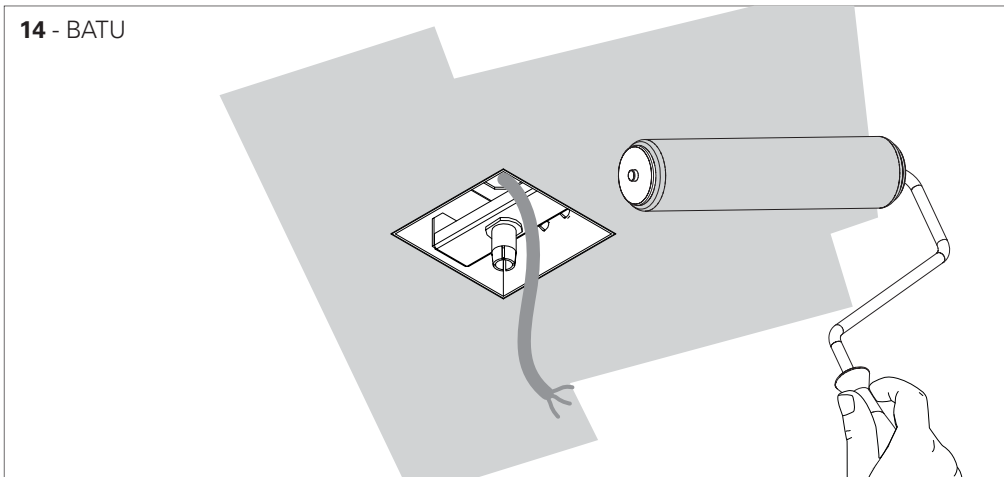

15 - BATU

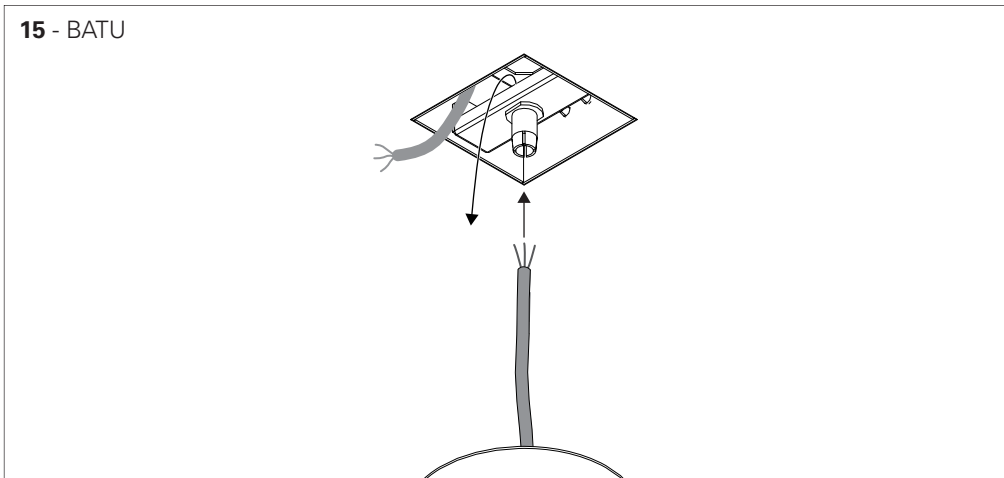

16 - BATU

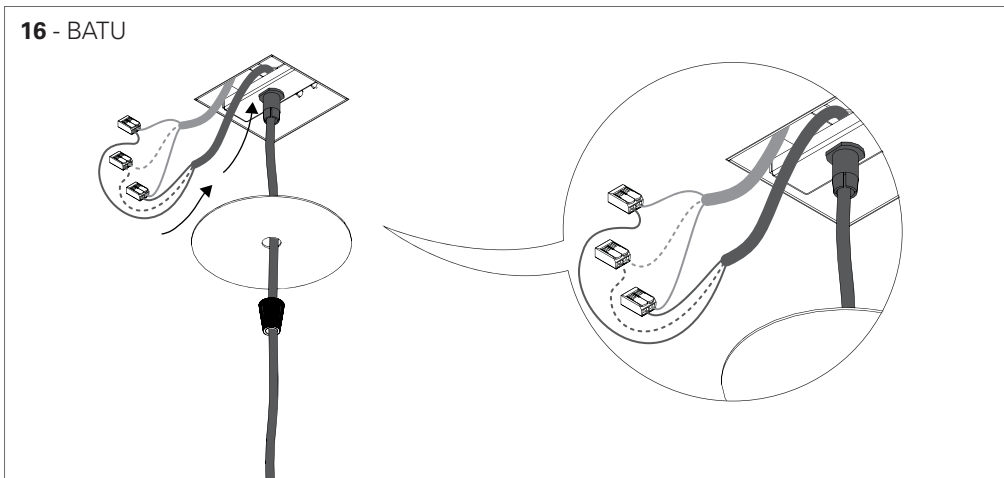

17 - BATU

STANDARD POWER SUPPLY
CÁBLAGE STANDARD
STANDARD VERDRAHTUNG
ALIMENTAÇÃO ELÉCTRICA STANDARD
ELECTRIFICACIÓN ESTÁNDAR

BLUE - N (NEUTRAL)
GREEN AND YELLOW - ⊕ (EARTH)
BROWN - L (LIVE)

BLEU - N (NEUTRE)
VERT ET JAUNE - ⊕ (TERRE)
MARRON - L (PHASE)

BLAU - N (NEUTRAL)
GRÜN UND GELB - ⊕ (ERDE)
BRAUN - L (PHASE)

AZUL - N (NEUTRO)
VERDE E AMARELO - ⊕ (TERRA)
CASTANHO - L (FASE)

AZUL - N (NEUTRAL)
VERDE Y AMARILLO - ⊕ (TIERRA)
MARRÓN - L (FASE)

18 - BATU

