

Norms: EN 60598-1, EN 60598-2-1



## PRODUCT DESCRIPTION

**Areas of Application:** Commercial and Business areas, Public buildings, Housing, Offices, Hotel and Restaurant services, Art and Culture spaces.

**Mounting:** Track system.

**Light Distribution:** Direct.

**Light Source:** LED or Halogen (G53) lamp or CDM-R111 (GX8.5) lamp.

**Control Gear:** Electronic equipment, 220-240VAC-50/60Hz and track adapter.

**Materials:** Body: Die cast aluminium.

**Surface Finish:** Powder coated.



LAMP*		W	BEAM ↙	AxBxC (mm)	D	Kg	ORDER CODE
LED 12V	G53	10/15	24/40	121x260x180	89	1,5	90001.U112.I
HAL 12V	G53	45/60	24/45	121x260x180	89	1,5	90001.U160.A
CDM-R111	GX8.5	35	10/40	121x260x180	89	1,5	90001.A135.A
	GX8.5	70	10/40	121x260x180	89	1,5	90001.A170.A

Please note: Electronic transformer 35 - 105W (G53). We recommend PHILIPS lamps.

### COLOUR / FINISH

Code	Description
W	White (RAL 9016)
B	Black (RAL 9005)
G	Grey (RAL 9006)

### OPTIONS

Code	Description
--	Track system.
--	Lamps as optional.

### DIMENSIONS

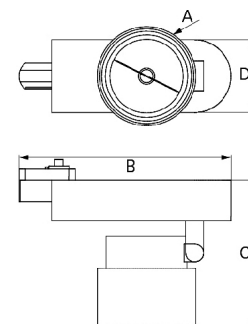

\* Lamp not included.

Example code for order: 90001.U160.A (ORDER CODE) + W (COLOUR/FINISH)

We reserve the right to make technical changes without prior notice. Electrical/Optical data are subjected to a tolerance of +/-10%.

**DETAILS**



Spotlight detail.



Spotlight detail.

**PHOTOMETRY**

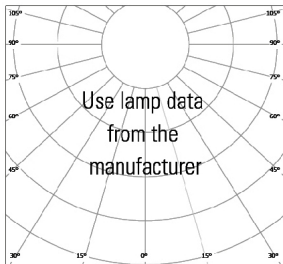

**TO SPECIFY:**

Three circuit track spotlight for LED/halogen (G53) lamp or 35/70W CDM-R111 (GX8,5) lamp. Housing in die cast aluminium with integral electronic equipment. Spotlight body swivels 355° and tilts 90° - as Indelague CALÉ.

We reserve the right to make technical changes without prior notice.  
Electrical/Optical data are subjected to a tolerance of +/-10%.