



**LED**

Norms: EN 60598-1, EN 60598-2-2



### PRODUCT DESCRIPTION

**Areas of Application:** Commercial and Business areas, Public buildings, Offices, Schools, Corridors.

**Mounting:** Ceiling recessed.

**Light Distribution:** Direct.



**Light Source:** LED 4000K, CRI>80, 65.000h life (@L80, B10, Ta 25 C).

**Control Gear:** LED driver, 220-240VAC-50/60Hz.



**Materials:** Body: Steel sheet.  
Frame: Extruded aluminium.

**Surface Finish:** Powder coated in white matt.

#### DAM - Microprismatic diffuser

	LED	UGR	W	Lm	Lm/W	η(%)	AxBxC (mm)		Kg	HF	DALI
		≤19	30	4080	94	69	897x297x102	880x280	6,1	9X5M.130.6V.F4	9X5M.130.6V.E4
		≤19	39	5440	96	69	1197x297x102	1180x280	7,1	9X5M.140.6V.F4	9X5M.140.6V.E4
		≤19	47	6800	103	71	1497x297x102	1480x280	8,6	9X5M.150.6V.F4	9X5M.150.6V.E4
		≤19	39	5440	100	72	597x597x102	580x580	7,1	9X5M.410.6V.F4	9X5M.410.6V.E4

#### DOZ - Opal polycarbonate diffuser

	LED	UGR	W	Lm	Lm/W	η(%)	AxBxC (mm)		Kg	HF	DALI
		≤22	30	4080	92	68	897x297x102	880x280	6,1	9X5M.130.2J.F4	9X5M.130.2J.E4
		≤22	39	5440	93	67	1197x297x102	1180x280	7,1	9X5M.140.2J.F4	9X5M.140.2J.E4
		≤22	47	6800	100	69	1497x297x102	1480x280	8,6	9X5M.150.2J.F4	9X5M.150.2J.E4
		≤22	39	5440	99	71	597x597x102	580x580	7,1	9X5M.410.2J.F4	9X5M.410.2J.E4

### DIMENSIONS

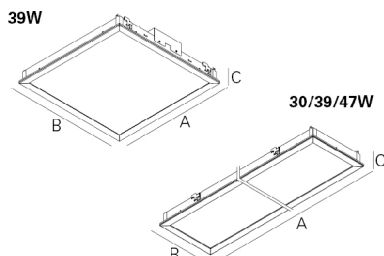

Example code for order: 9X5M.150.2J.E4 (DALI) + 3000 + W5MD + 955000 (OPTIONS)

We reserve the right to make technical changes without prior notice.  
Electrical/Optical data are subjected to a tolerance of +/-10%.

### OPTIONS

#### Colour temperature

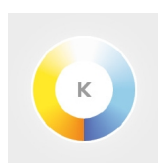

3000K

Order code  
**3000**

#### Connectors

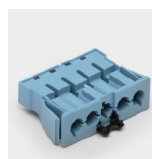

Connector 3-pole wieland GST 18i3 male  
Connector 5-pole wieland GST 18i5 male  
Connector 5-pole wieland GST 18i5 DIM male

Order code  
**W3M**  
**W5M**  
**W5MD**

#### Safety cable



Steel safety cable

Order code  
**955000**

#### CRI



CRI>90

Order code  
**CRI90**

#### Emergency unit



Emergency unit 3 hours  
Emergency unit 1 hour

Order code  
**K3**  
**K1**

• Test function by telecommand signal.

### DETAILS



Side fixture connector on the luminaire (optional)

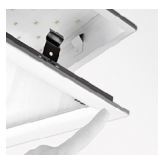

Frame with click system

### PHOTOMETRY

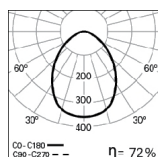

**LNE LED 39W DAM**  
(597x597mm) 4000K

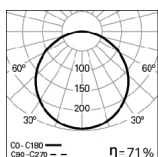

**LNE LED 39W DOZ**  
(597x597mm) 4000K

### PERFORMANCE

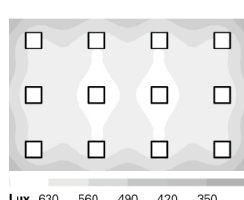

#### LNE LED DAM

LED: 39W  
DIMENSIONS: 9,5m x 6m  
HEIGHT: 3m  
MAINTENANCE: 0,8  
REFLECTANCE: 70/50/20  
WORKING PLACE: 0,8m  
ILLUMINANCE  $E_{m}$ : 566 lux  
UGR:  $\leq 17$

We reserve the right to make technical changes without prior notice.  
Electrical/Optical data are subjected to a tolerance of +/-10%.

## FIXING SYSTEMS

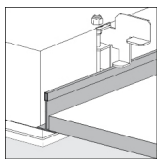

Pull-up version with brackets for exposed T grids 15/24mm.

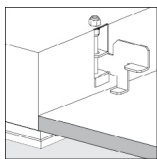

Pull-up version with brackets for plasterboard ceilings.

### TO SPECIFY:

Recessed LED luminaire for modular ceilings. Aluminium frame with opal polycarbonate or microprismatic diffuser. Standard version with 4000K, CRI>80 and 65.000h lifetime (@L80, B10, Ta 25 C). Suitable for pull up version with brackets. Optional DALI dimmable driver, 3000K, CRI>90, connectors, steel safety cable and 1 or 3 hours emergency unit. – as Indelague LNE LED

We reserve the right to make technical changes without prior notice.  
Electrical/Optical data are subjected to a tolerance of +/-10%.