

SAFETY CABLE OPTION
OPTION FILIN DACIER
OPTIONEN STAHL SICHERHEITSKABEL
OPÇÃO CABO DE SEGURANÇA
OPCIÓN CABLE DE SEGURIDAD

The technical drawing illustrates the 'Safety Cable Option' for a window blind. It is divided into two parts. The left part shows a perspective view of a window blind's corner where a cable is being installed into a channel. Arrows indicate the cable's path and the direction of installation. The right part shows a detailed view of the cable's end, which features a hook and a loop mechanism, likely for securing the cable to a specific component of the blind's frame.

POWER SUPPLY HF WITH EMERGENCY KIT
CABLAGE HF AVEC UNITÉ DE SECOURS
VERDRAHTUNG FÜR HF MIT NOTLICHTEINSATZ
ALIMENTAÇÃO ELECTRICA HF COM KIT EMERGÊNCIA
ELECTRIFICACIÓN HF COM KIT DE EMERGENCIA

~ 220-240V 50/60Hz

HF EM

3 N 1 2

L ⊕ N LE NE

BLEU - N (NEUTRAL)	AZUL - N (NEUTRO)
GREEN AND YELLOW - (⊕)(EARTH)	VERDE E AMARELO - (⊕)(TERRA)
BROWN - L (LIVE)	CASTANHO - L (FASE)
GREY - D1+	CINZA - D1+
BLACK - D2-	PRETO - D2-
BLUE - NE (EMERGENCE NEUTRAL)	AZUL - NE (EMERGÊNCIA NEUTRO)
BROWN - LE (EMERGENCE LIVE)	CASTANHO - LE (EMERGÊNCIA FASE)
BLEU - N (NEUTRE)	AZUL - N (NEUTRAL)
VERT ET JAUNE - (⊕)(TERRE)	VERDE Y AMARILLO - (⊕)(TIERRA)
MARRON - L (PHASE)	MARRON - L (FASE)
GRIS - D1+	GRIS - D1+
NOIR - D2-	NEGRO - D2-
BLEU - NE (UNI.SECOURS NEUTRE)	AZUL - NE (EMERGÊNCIA NEUTRAL)
MARRON - LE (UNI.SECOURS PHASE)	MARRON - LE (EMERGÊNCIA FASE)
BLAU - N (NEUTRAL)	
GRÜN UND GELB - (⊕)(ERDE)	
BRAUN - L (PHASE)	
GRAU - D1+	
SCHWARZ - D2-	
BLAU - NE (NOTLICHT NEUTRAL)	
BRAUN - LE (NOTLICHT PHASE)	

STANDARD POWER SUPPLY
CÂBLAGE AVEC GRADATION
STANDARD VERDRÄHTUNG
ALIMENTAÇÃO ELÉCTRICA STANDARD
ELECTRIFICACION ESTÁNDAR

~220-240V 50/60Hz

DIMMABLE POWER SUPPLY
CÂBLAGE AVEC GRADATION
DIMMBARE VERDRÄHTUNG
ALIMENTAÇÃO ELÉCTRICA COM REGULAÇÃO
ELECTRIFICACION CON REGULACIÓN

~220-240V 50/60Hz

BLAU - N (NEUTRAL)
VERT ET JAUNE - (⊕) (TERRE)
MARRON - L (PHASE)
GRIS - D1+
NOIR - D2-

BLAU - N (NEUTRAL)
GRÜN UND GELB - (⊕) (ERDE)
BRAUN - L (PHASE)
GRAU - D1+
SCHWARZ - D2-

AZUL - N (NEUTRO)
VERDE E AMARELO - (⊕) (TERRA)
CASTANHO - L (FASE)
CINZA - D1+
PRETO - D2-

AZUL - N (NEUTRO)
VERDE Y AMARILLO - (⊕) (TIERRA)
MARRÓN - L (FASE)
GRIS - D1+
NEGRO - D2-

DIMMABLE POWER SUPPLY AND EMERGENCY KIT
 CÂBLAGE AVEC GRADATION ET UNITÉ DE SECOURS
 STROMVERSORGUNG FÜR DIMMBARE LEUCHTE ODER MIT NOTLEUCHTEN
 ALIMENTAÇÃO ELÉCTRICA COM REGULAÇÃO E KIT EMERGÊNCIA
 ELECTRIFICACIÓN CON REGULACIÓN Y KIT DE EMERGENCIA

~220-240V 50/60Hz
 L N LENE D1 D2
 DADA

MADE IN
PORTUGAL

EN INSTALLATION INSTRUCTIONS
FR INSTRUCTIONS D'INSTALLATION
DE INSTALLATIONSANLEITUNG
PT INSTRUÇÕES DE MONTAGEM
ES INSTRUCCIONES DE MONTAJE

IP 20
DAM DOP DOA
IP 20/40
PS PB PM
960°C
DOP
850°C
DAM DOA
650°C
230V/50Hz

EN Luminaire can not be covered with thermal insulation.

FR Luminaires ne pouvant pas être recouverts de matériaux isolants thermique.

DE Leuchte die nicht mit thermisch isolierenden Material bedeckt sein kann.

PT Luminária que não pode ser coberta com material isolante térmico.

ES La luminaria no puede ser cubierta con material aislante térmico.



EN If glass or diffuser break or crack, please replace it.

FR En cas de casse ou fissuration, remplacez le verre ou diffuseur.

DE Bei Bruch oder Riss, Glas oder Diffuser ersetzen.

PT Em caso de quebra ou fissura, substituir o vidro ou difusor.

ES En caso de rotura o fisura, sustituir el vidrio o difusor.

MAINTENANCE | ENTRETIEN | WARTUNG |
MANUTENÇÃO | MANTENIMIENTO

EN To replace lamps please reverse the steps 8-7 or 16-15 of this leaflet.
FR Pour remplacer les tubes inversez les étapes 8-7 ou 16-15 de cette brochure.
DE Um die Lampen zu ersetzen müssen die Schritte 8-7 oder 16-15 dieser Broschüre umgekehrt werden.
PT Para trocar lâmpadas deve inverter os passos 8-7 ou 16-15 deste folheto.
ES Para sustituir las lámparas deben revertir los pasos 8-7 o 16-15.

 **EN** Read carefully the general terms and conditions of use and environmental concern with recycling attached. | **FR** Lire attentivement les conditions générales d'utilisations et de préoccupation environnementales avec les recyclage ci-joint. | **DE** Bitte lesen Sie de Allgemeinen Geschäftsbedingungen und Umweltbewusstsein über Recycling angeschlossen. | **PT** Ler atentamente as condições gerais de uso e preocupação ambiental com a reciclagem, em anexo. | **ES** Lea atentamente las condiciones generales de uso y preocupación ambiental con el reciclaje adjuntos.

EN We reserve the right to make changes to technical specifications, design and installation leaflet without prior notice. | **FR** Nous réservons de modifications au niveau de la conception, des spécifications techniques et de la notice. | **DE** Änderungen von Entwurf, technischen Daten und Bedienungsanleitungen bleiben vorbehalten. | **PT** O fabricante reserva-se ao direito de realizar modificações no desenho, especificações técnicas e folheto, sem aviso prévio. | **ES** El fabricante se reserva el derecho de realizar modificaciones en el diseño, las especificaciones técnicas y el folleto.

LNE

EN 1 LAMP VERSION WITH DIFFUSER
FR VERSION 1 LAMPE AVEC DIFUSEUR
DE VERSION MIT DIFFUSER 1 LEUCHTMITTEL
PT VERSÃO DE 1 LÂMPADA COM DIFUSOR
ES VERSIÓN DE 1 LÁMPARA CON DIFUSOR

(mm)
1197x120x89 1180x103
1497x120x89 1480x103

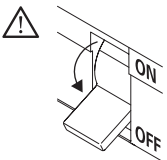
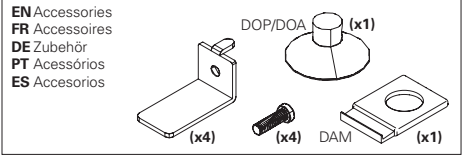

1 - LNE

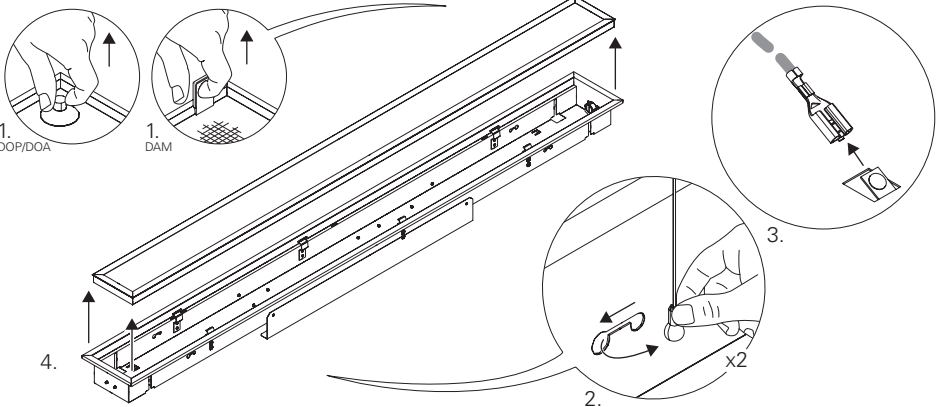

2 - LNE

SAFETY CABLE OPTION
OPTION FILIN D'ACIER
OPTIONEN STAHL SICHERHEITSKABEL
OPÇÃO CABO DE SEGURANÇA
OPCIÓN CABLE DE SEGURIDAD

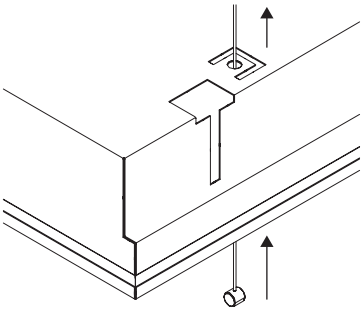

4 - LNE DSI/DALI + EM

DIMMABLE POWER SUPPLY AND EMERGENCY KIT
CÂBLAGE AVEC GRADATION ET UNITÉ DE SECOURS
STROMVERSORGUNG FÜR DIMMBARE LEUCHTE ODER MIT NOTLICHTEINSATZ
ALIMENTAÇÃO ELÉCTRICA COM REGULAÇÃO E KIT EMERGÊNCIA
ELECTRIFICACIÓN CON REGULACIÓN Y KIT DE EMERGENCIA

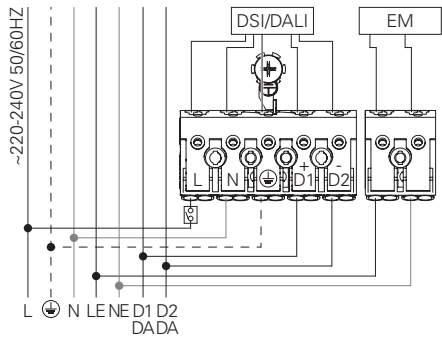

BLUE - N (NEUTRAL)
GREEN AND YELLOW - (EARTH)
BROWN - L (LIVE)
GREY - D1+
BLACK - D2-
BLUE - NE (EMERGENCY NEUTRAL)
BROWN - LE (EMERGENCY LIVE)

BLEU - N (NEUTRE)
VERT ET JAUNE - (TERRE)
MARRON - L (PHASE)
GRIS - D1+
NOIR - D2-
BLEU - NE (UNI. SECOURS NEUTRE)
MARRON - LE (UNI. SECOURS PHASE)

BLAU - N (NEUTRAL)
GRÜN UND GELB - (ERDE)
BRAUN - L (PHASE)
GRAU - D1+
SCHWARZ - D2-
BLAU - NE (NOTLICHT NEUTRAL)
BRAUN - LE (NOTLICHT PHASE)

AZUL - N (NEUTRO)
VERDE E AMARELO - (TERRA)
CASTANHO - L (FASE)
CINZA - D1+
PRETO - D2-
AZUL - NE (EMERGÊNCIA NEUTRO)
CASTANHO - LE (EMERGÊNCIA FASE)

AZUL - N (NEUTRO)
VERDE Y AMARILLO - (TIERRA)
MARRÓN - L (FASE)
GRIS - D1+
NEGRO - D2-
AZUL - NE (EMERGENCIA NEUTRAL)
MARRÓN - LE (EMERGENCIA FASE)

5 - LNE

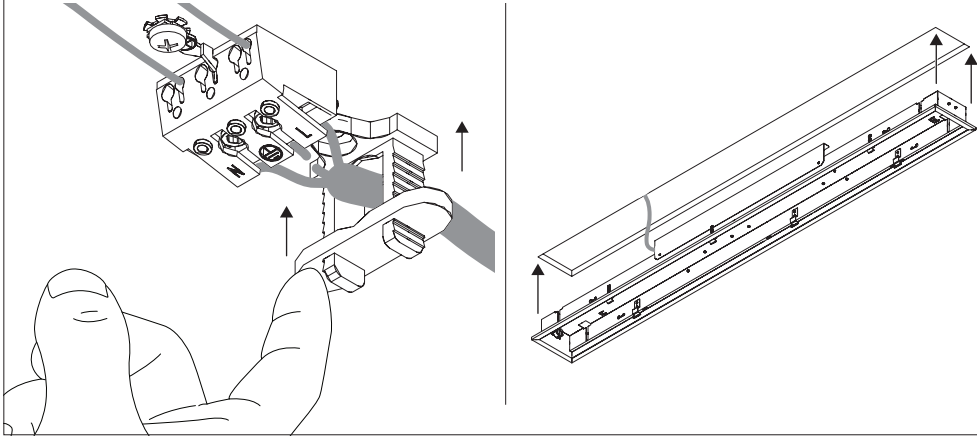

6 - LNE

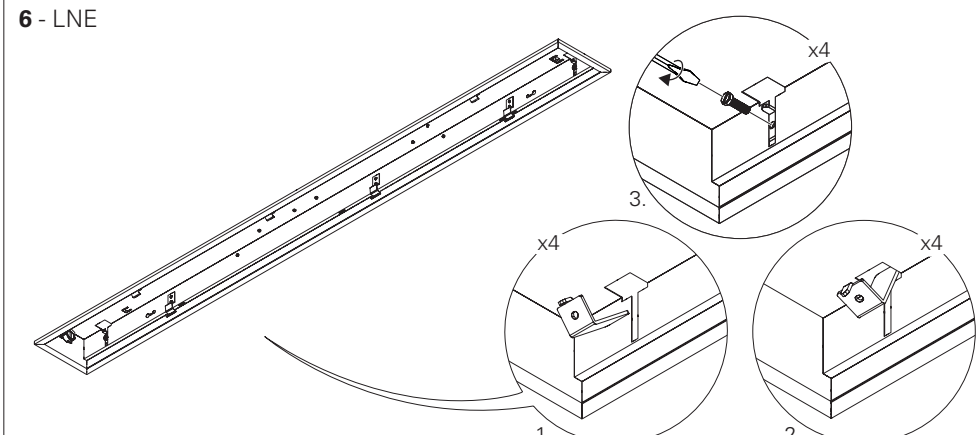

3 - LNE

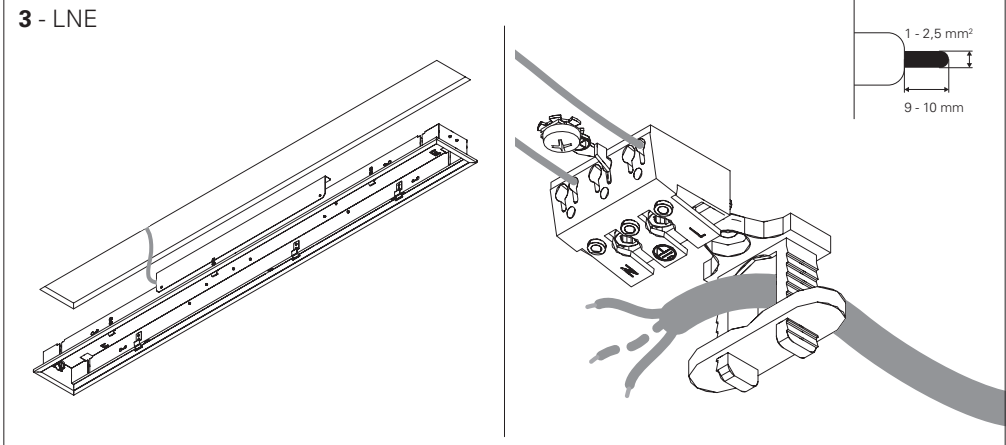

4 - LNE HF

STANDARD POWER SUPPLY
CÂBLAGE STRANDARD
STANDARD VERDRAHTUNG
ALIMENTAÇÃO ELÉCTRICA STANDARD
ELECTRIFICACIÓN ESTÁNDAR

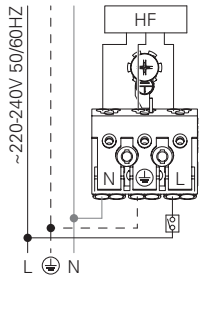

DSI/DALI

DIMMABLE POWER SUPPLY
CÂBLAGE AVEC GRADATION
DIMMBARE VERDRAHTUNG
ALIMENTAÇÃO ELÉCTRICA COM REGULAÇÃO
ELECTRIFICACIÓN CON REGULACIÓN

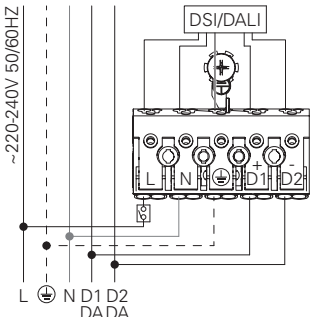

BLUE - N (NEUTRAL)
GREEN AND YELLOW - (EARTH)
BROWN - L (LIVE)
GREY - D1+
BLACK - D2-

BLEU - N (NEUTRE)
VERT ET JAUNE - (TERRE)
MARRON - L (PHASE)
GRIS - D1+
NOIR - D2-

BLAU - N (NEUTRAL)
GRÜN UND GELB - (ERDE)
BRAUN - L (PHASE)
GRAU - D1+
SCHWARZ - D2-

AZUL - N (NEUTRO)
VERDE E AMARELO - (TERRA)
CASTANHO - L (FASE)
CINZA - D1+
PRETO - D2-

AZUL - N (NEUTRAL)
VERDE Y AMARILLO - (TIERRA)
MARRÓN - L (FASE)
GRIS - D1+
NEGRO - D2-

4 - LNE HF + EM

POWER SUPPLY HF WITH EMERGENCY KIT
CÂBLAGE HF AVEC UNITÉ DE SECOURS
VERDRAHTUNG FÜR HF MIT NOTLICHTEINSATZ
ALIMENTAÇÃO ELÉCTRICA HF COM KIT EMERGÊNCIA
ELECTRIFICACIÓN HF COM KIT DE EMERGENCIA

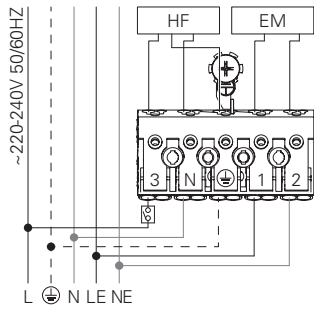

BLUE - N (NEUTRAL)
GREEN AND YELLOW - (EARTH)
BROWN - L (LIVE)
GREY - LE (EMERGENCY LIVE)
BLACK - NE (EMERGENCY NEUTRAL)

BLEU - N (NEUTRE)
VERT ET JAUNE - (TERRE)
MARRON - L (PHASE)
GRIS - LE (UNI. SECOURS PHASE)
NOIR - NE (UNI. SECOURS NEUTRE)

BLAU - N (NEUTRAL)
GRÜN UND GELB - (ERDE)
BRAUN - L (PHASE)
GRAU - LE (NOTLICHT PHASE)
SCHWARZ - NE (NOTLICHT NEUTRAL)

AZUL - N (NEUTRO)
VERDE E AMARELO - (TERRA)
CASTANHO - L (FASE)
CINZA - LE (EMERGÊNCIA FASE)
PRETO - NE (EMERGÊNCIA NEUTRO)

AZUL - N (NEUTRAL)
VERDE Y AMARILLO - (TIERRA)
MARRÓN - L (FASE)
GRIS - LE (EMERGENCIA FASE)
NEGRO - NE (EMERGENCIA NEUTRAL)

7 - LNE

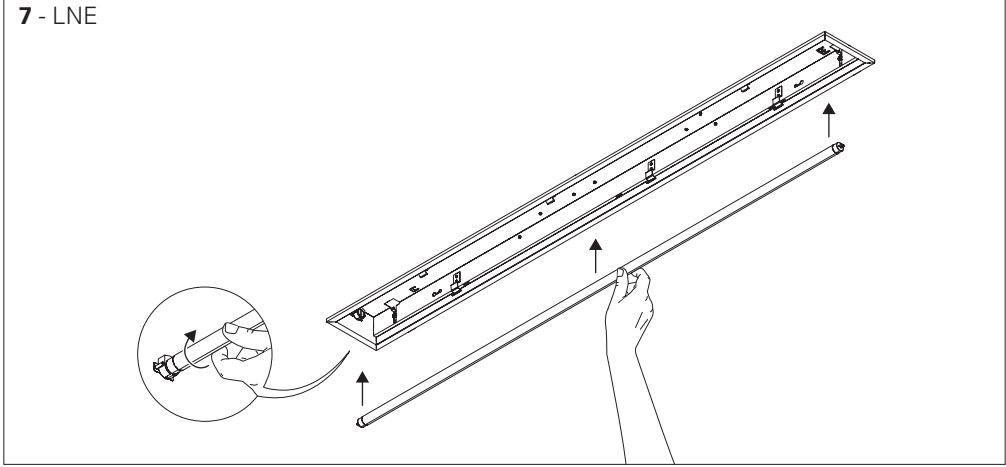

8 - LNE

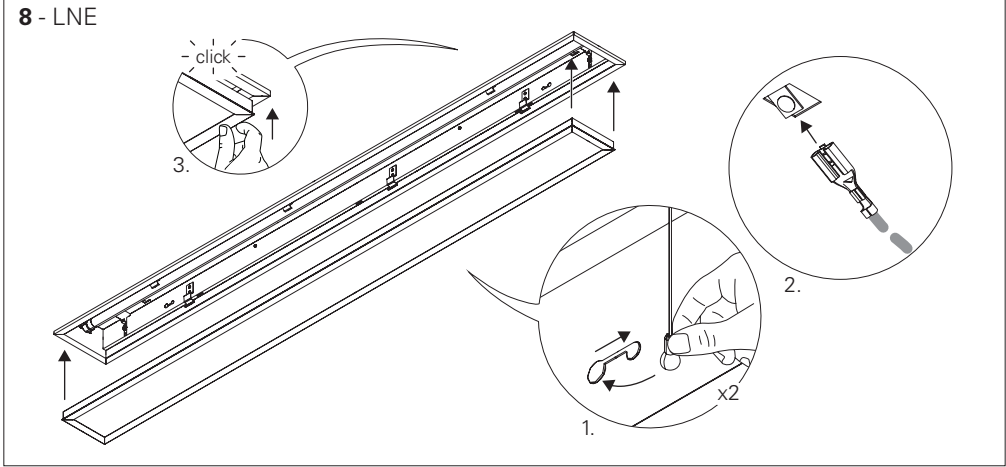

LNE

EN 1 LAMP VERSION WITH LOUVRE
FR VERSION 1 LAMPE AVEC RÉFLECTEUR
DE VERSION MIT REFLEKTOR 1 LEUCHTMITTEL
PT VERSÃO DE 1 LÂMPADA COM REFLETOR
ES VERSIÓN DE 1 LÁMPARA CON ÓPTICA

(mm)
1197x120x89 1180x103
1497x120x89 1480x103

EN Accessories
FR Accessoires
DE Zubehör
PT Acessórios
ES Accesorios

