



Norms: EN 60598-1, EN 60598-2-1



PRODUCT DESCRIPTION

Areas of Application: Commercial and Business areas, Public buildings, Housing, Offices, Hotel and Restaurant services, Art and Culture spaces.

Light Source: LED 4000K, CRI >80, 50.000h life.

Optical System: Diffuser: Opal acrylic.

Control Gear: LED driver, 220-240VAC-50/60Hz.

Wiring: Ceiling rose with LED driver included.

Materials: Body: Steel sheet.

Surface Finish: Powder coated.

DOA - Opal acrylic diffuser.

LED	W	Lm	AxBxC (mm)	Kg	HF	DALI
	1x16	2250	920x80x80	3,2	90127.L116.E	90127.L116.H
	1x22	3000	1200x80x80	3,9	90127.L122.E	90127.L122.H
	1x27	3750	1480x80x80	4,9	90127.L127.E	90127.L127.H

OPTIONS

Code	Description
3000	Colour temperature 3000K.

DETAILS



Suspension detail

DIMENSIONS

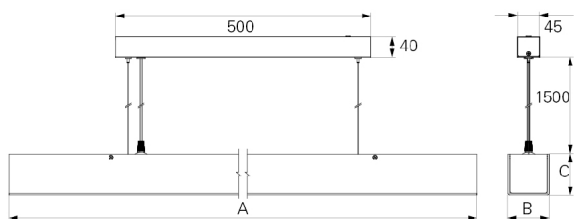

TO SPECIFY:

Suspended LED luminaire with opal diffuser and 2250/3000/3750 lumen light engine - as Roxo Lighting LUCID LED.

Example code for order: 90127.L116.H (DALI) + 3000 (OPTIONS)

We reserve the right to make technical changes without prior notice.