

Norms: EN 60598-1, EN 60598-2-1



PRODUCT DESCRIPTION

Mounting:	Suspended.
Light Distribution:	Direct.
Control Gear:	Magnetic ballast, ignitor and capacitor.
Materials:	Body: Galvanized steel. Diffuser: Transparent tempered glass.
Surface Finish:	Powder coated in grey.



RLO - Satin aluminium reflector

	LAMP*		W	AxB (mm)	Kg	ORDER CODE
	HIE	E40	250	Ø485x545	8,7	9D99.250.0N4
		E40	400	Ø485x545	9,5	9D99.400.0N4
	HSE-E	E40	250	Ø485x545	8,7	9F99.250.0N4
		E40	400	Ø485x545	9,5	9F99.400.0N4

OPTIONS

Code	Description
925100	Wire grid protection
--	Lamps as optional

DETAILS



Grelha de proteção

* Lamp not included.
Example code for order: 9F99.250.0N4 (ORDER CODE) + 925100 (OPTIONS)

We reserve the right to make technical changes without prior notice.
Electrical/Optical data are subjected to a tolerance of +/-10%.

DIMENSIONS

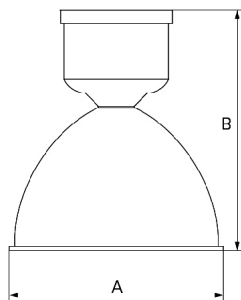

TO SPECIFY:

Suspended IP65 high bay luminaire suitable for 1x250/400W high pressure sodium or metal halide lamp. Aluminium reflector with high efficient and transparent tempered glass. Optional wire grip protection – as Indelague LUM.

We reserve the right to make technical changes without prior notice.
Electrical/Optical data are subjected to a tolerance of +/-10%.