

## REBA 65 /E LED

**EN** INSTALLATION INSTRUCTIONS  
**FR** INSTRUCTIONS D'INTALLATION  
**DE** INSTALLATIONSANLEITUNG  
**PT** INSTRUÇÕES DE MONTAGEM  
**ES** INSTRUCCIONES DE MONTAJE

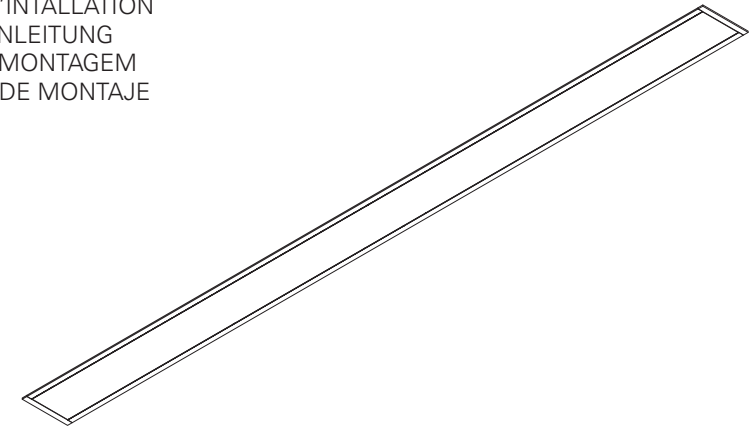

### REBA 65 /E LED



**EN** WARNING: THE LIGHT SOURCE CONTAINED IN THE LUMINAIRE SHOULD BE REPLACED ONLY BY THE MANUFACTURER. DO NOT USE THIS EQUIPMENT IN AREAS CONTAINING CHEMICAL AGENTS: ACIDS, SOLVENTS, PAINTS, SILICONES, COATINGS, ETC.

**FR** AVERTISSEMENT: LA SOURCE DE LUMIÈRE CONTENUE DANS LA LUMINAIRE DOIT ÊTRE REMPLACÉE PAR LE FABRICANT. EN CAS D'ANOMALIE DÉTECTÉE, CONTACTEZ LE FABRICANT. NE PAS UTILISER L'EQUIPEMENT DANS LES ZONES QUI CONTIENNENT DES AGENTS CHIMIQUES: ACIDES, SOLVANTS, PEINTURES, SILICONES, VERNIS, ETC.

**DE** WARNUNG: DIE IN DER LEUCHTE ENTHALTEN LICHTQUELLE SOLLTE NUR VOM HERSTELLER ERSETZT WERDEN. VERWENDEN SIE DIESES GERÄT NICHT IN BEREICHEN MIT CHEMISCHEN MITTELN: SÄUREN, LÖSUNGSMITTEL, FARBEN, SILIKONE, BESCHICHTUNGEN ETC.

**PT** ATENÇÃO: A FONTE DE LUZ CONTIDA NA LUMINÁRIA DEVE SER SUBSTITUÍDA UNICAMENTE PELO FABRICANTE. QUALQUER ANOMALIA DETECTADA CONTACTAR O FABRICANTE. NÃO UTILIZAR O EQUIPAMENTO EM ZONAS QUE CONTENHAM AGENTES QUÍMICOS: ÁCIDOS, SOLVENTES, TINTAS, SILICONES, VERNIZES, ETC.

**ES** ATENCIÓN: LA FUENTE DE LUZ CONTENIDA EN LA LUMINARIA DEBE SER SUSTITUIDA UNICAMENTE POR EL FABRICANTE. CUALQUIER ANOMALÍA DETECTADA CONTACTAR CON EL FABRICANTE. NO UTILIZAR

LA LUMINARIA EN ZONAS QUE CONTENGAN AGENTES QUÍMICOS: ÁCIDOS, DISOLVENTES, PINTURAS, SILICONAS, BARNICES, ETC."



**EN** CAUTION, RISK OF ELECTRIC SHOCK.

**FR** ATTENTION, RISQUE DE CHOC ÉLECTRIQUE.

**DE** ACHTUNG, GEFAHR EINES STROMSCHLAGS.

**PT** CUIDADO, RISCO DE CHOQUE ELÉTRICO.

**ES** PRECAUCIÓN, RIESGO DE DESCARGA ELÉCTRICA.



**EN** LUMINAIRE CAN NOT BE COVERED WITH THERMAL INSULATION.

**FR** LUMINAIRES NE POUVANT PAS ÊTRE RECOUVERTS DE MATÉRIAUX ISOLANT THERMIQUE.

**DE** LEUCHTE DIE NICHT MIT THERMISCH ISOLIERENDEN MATERIAL BEDECKT SEIN KANN.

**PT** LUMINÁRIA QUE NÃO PODE SER COBERTA COM MATERIAL ISOLANTE TÉRMICO.

**ES** LA LUMINARIA NO PUEDE SER CUBIERTA CON MATERIAL AISLANTE TÉRMICO.





**EN** Read carefully the general terms and conditions of use and environmental concern with recycling attached. | **FR** Lire attentivement les conditions générales d'utilisations et de préoccupation environnementales avec les recyclage ci-joint. | **DE** Bitte lesen Sie de Allgemeinen Geschäftsbedingungen und Umweltbewusstsein über Recycling angeschlossen. | **PT** Ler atentamente as condições gerais uso e preocupação ambiental com a reciclagem em anexo. | **ES** Lea atentamente las condiciones generales de uso y preocupación ambiental con el reciclaje adjuntos.

**EN** We reserve the right to make changes on technical specifications, design and installation leaflet without prior notice. | **FR** Sous réserve de modifications au niveau de la conception, des spécifications techniques et de la notice. | **DE** Änderungen von Entwurf, technischen Daten und Bedienungsanleitungen bleiben vorbehalten. | **PT** O fabricante reserva-se no direito de realizar modificações no desenho, especificações técnicas e folheto, sem aviso prévio. | **ES** El fabricante se reserva el derecho de realizar modificaciones en el diseño, las especificaciones técnicas y el folleto.

# REBA 65 /E LED

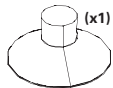
EN Accessories  
FR Accessoires  
DE Zubehör  
PT Acessórios  
ES Accesorios



 (mm)	
858x77x80	850x71
1138x77x80	1130x71
1418x77x80	1410x71
1698x77x80	1690x71
1980x77x80	1972x71
2260x77x80	2252x71
2540x77x80	2532x71
2820x77x80	2812x71

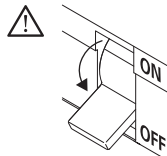

## 1 - REBA 65 /E LED

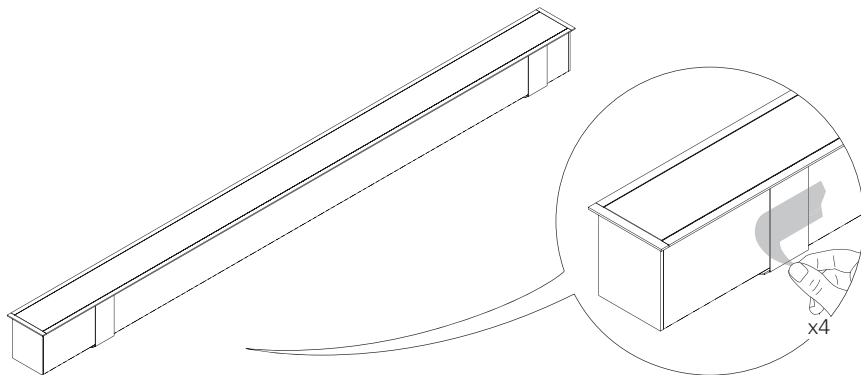

## 2 - REBA 65 /E LED

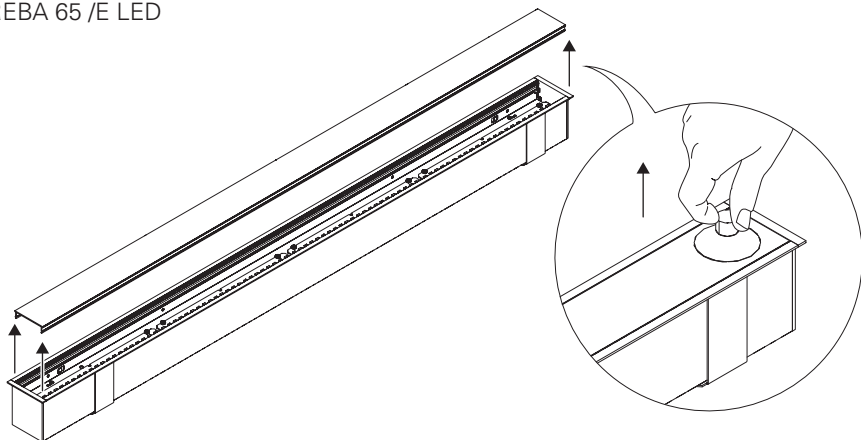

**9 - REBA 65 /E LED**

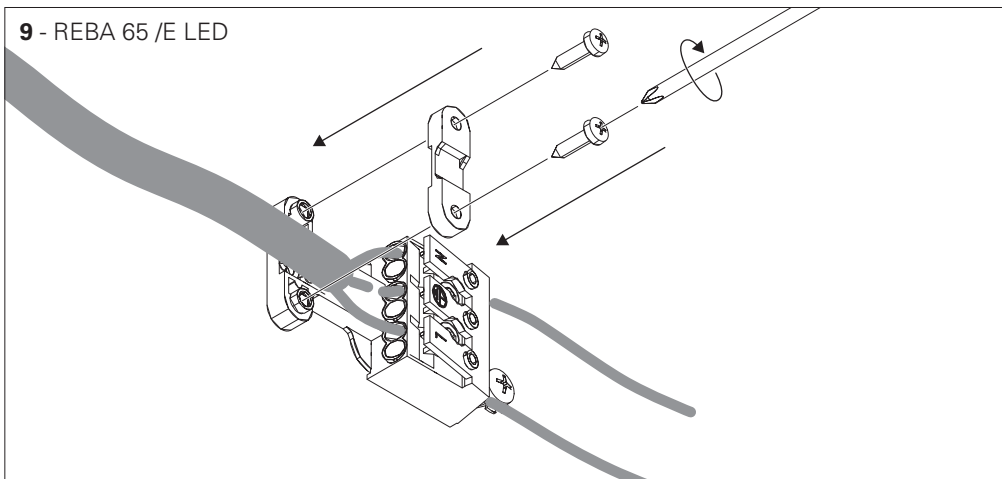

**10 - REBA 65 /E LED**

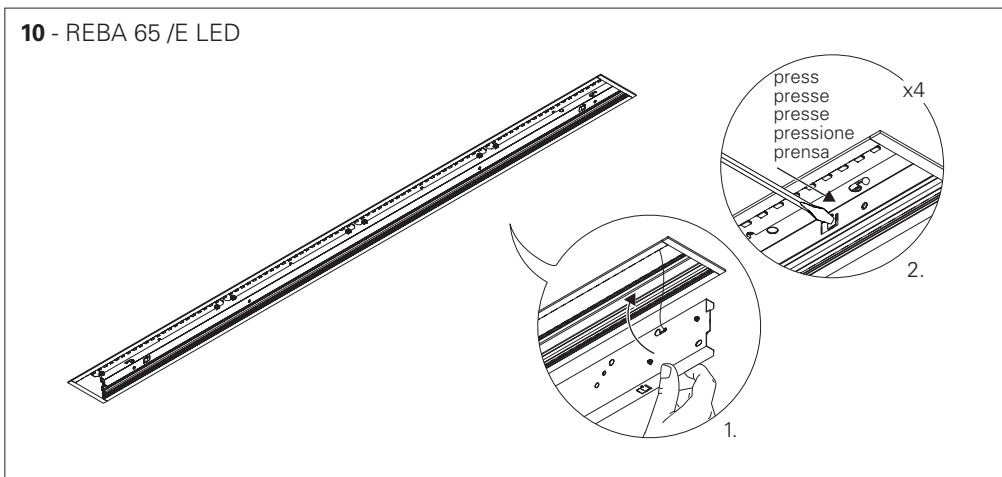

**11 - REBA 65 /E LED**

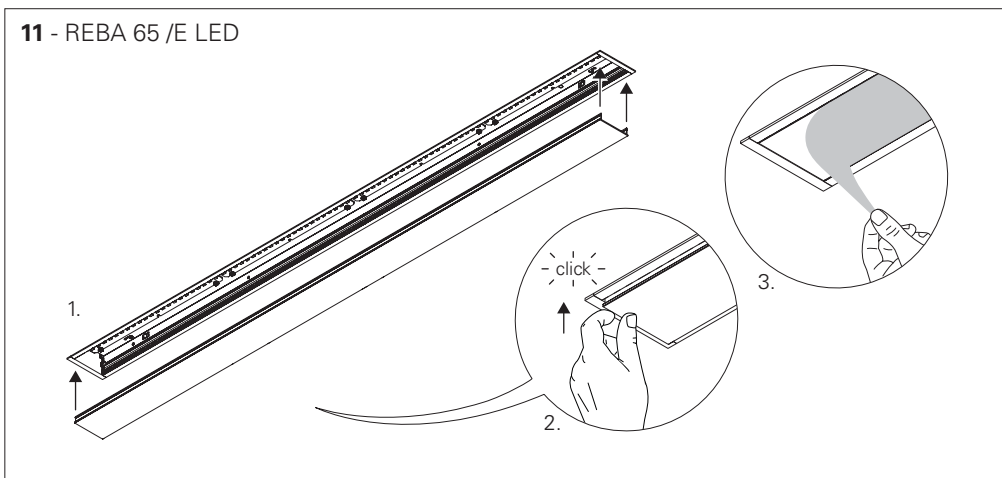

**3 - REBA 65 /E LED**

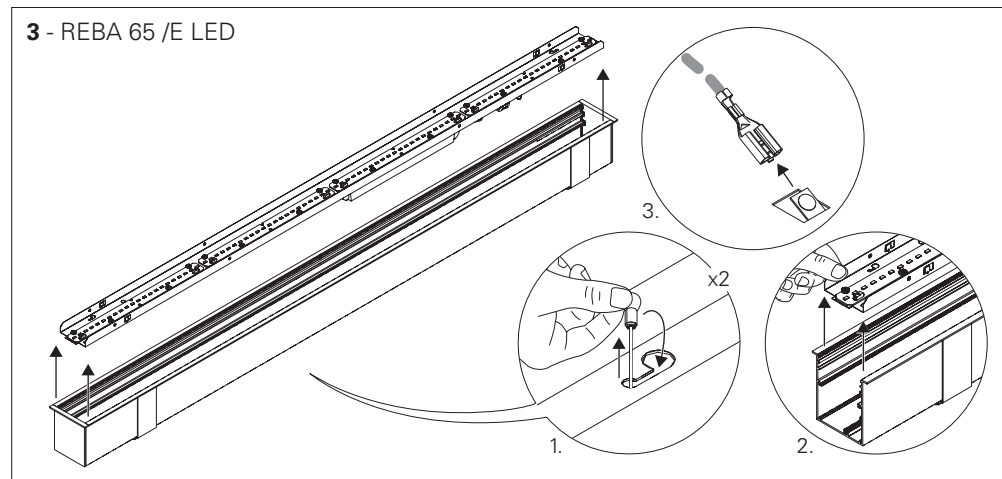

**4 - REBA 65 /E LED**

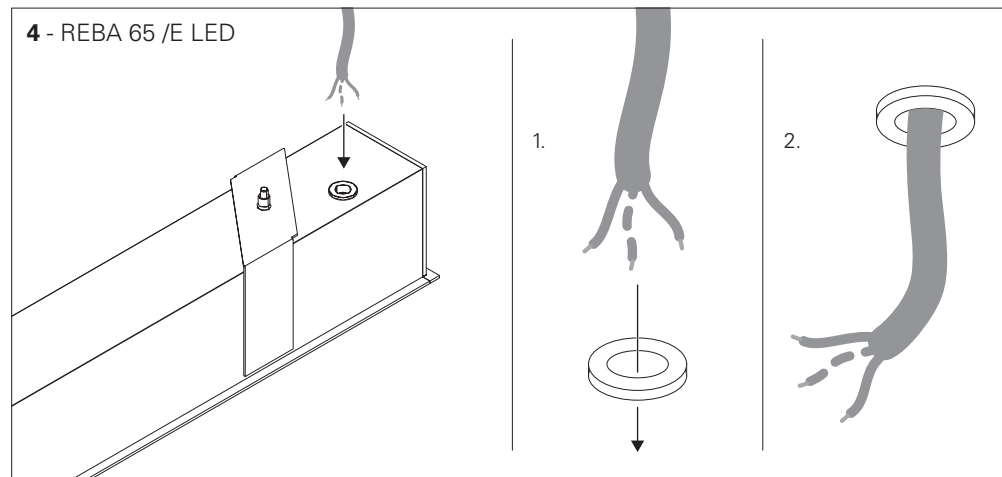

**5 - REBA 65 /E LED**

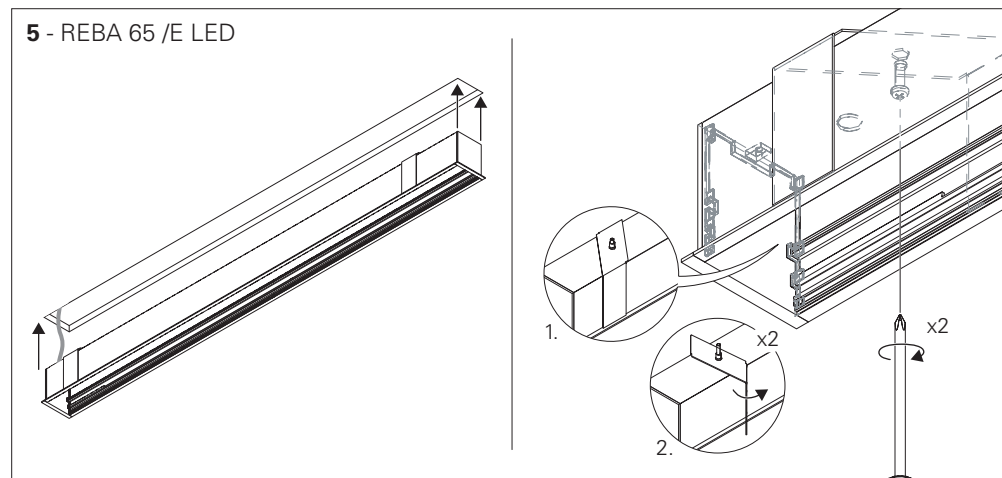

## 6 - REBA 65 /E LED

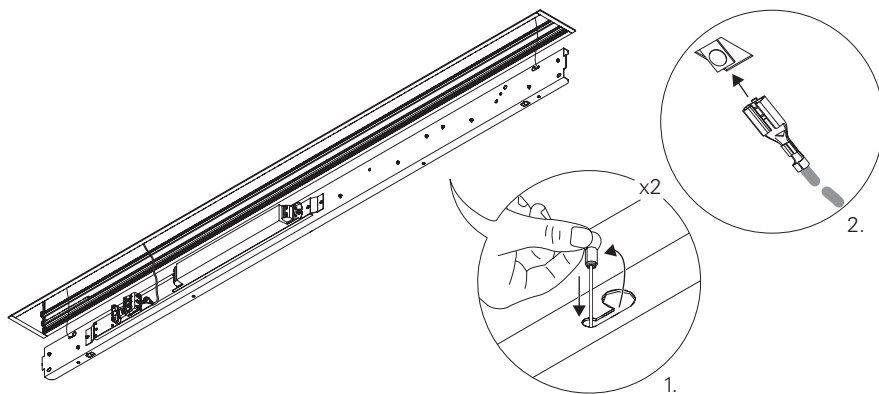

## 7 - REBA 65 /E LED

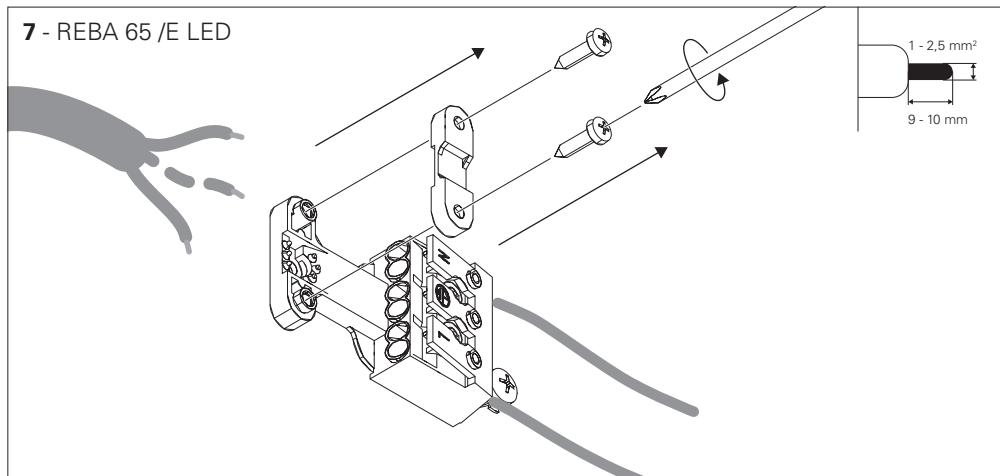

## 8 - REBA 65 /E LED HF

STANDARD POWER SUPPLY  
CÂBLAGE STANDARD  
STANDARD VERDRÄHTUNG  
ALIMENTAÇÃO ELÉCTRICA STANDARD  
ELECTRIFICACIÓN ESTÁNDAR

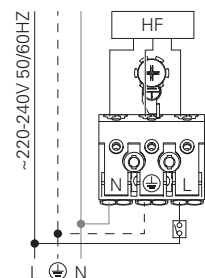

### DALI

DIMMABLE POWER SUPPLY  
CÂBLAGE AVEC GRADATION  
DIMMBARE VERDRÄHTUNG  
ALIMENTAÇÃO ELÉCTRICA COM REGULAÇÃO  
ELECTRIFICACIÓN CON REGULACIÓN

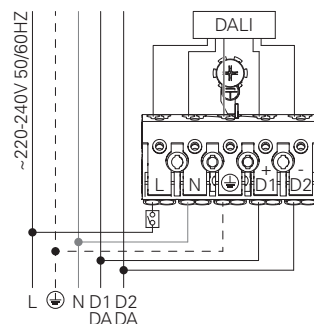

BLUE - N (NEUTRAL)  
GREEN AND YELLOW - (EARTH)  
BROWN - L (LIVE)  
GREY - D1+  
BLACK - D2-

BLEU - N (NEUTRE)  
VERT ET JAUNE - (TERRE)  
MARRON - L (PHASE)  
GRIS - D1+  
NOIR - D2-

BLAU - N (NEUTRAL)  
GRÜN UND GELB - (ERDE)  
BRAUN - L (PHASE)  
GRAU - D1+  
SCHWARZ - D2-

AZUL - N (NEUTRO)  
VERDE E AMARELO - (TERRA)  
CASTANHO - L (FASE)  
CINZA - D1+  
PRETO - D2-

AZUL - N (NEUTRAL)  
VERDE Y AMARILLO - (TIERRA)  
MARRÓN - L (FASE)  
GRIS - D1+  
NEGRO - D2-

## 8.1 - REBA 65 /E LED HF + EM + TEL.

POWER SUPPLY HF WITH EMERGENCY KIT AND TELECOMMAND  
CÂBLAGE HF AVEC UNITE DE SECOURS ET TELECOMMANDE  
VERDRÄHTUNG FÜR HF MIT NOTLICHTEINSATZ UND TELEKOMMAND  
ALIMENTAÇÃO ELÉCTRICA HF COM KIT EMERGÊNCIA E TELECOMANDO  
ELECTRIFICACIÓN HF CON KIT DE EMERGENCIA Y TELEMANDABLE

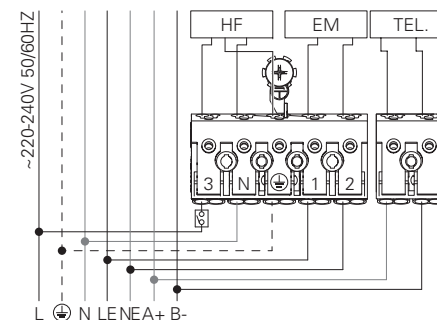

BLUE - N (NEUTRAL)  
GREEN AND YELLOW - (EARTH)  
BROWN - L (LIVE)  
GREY - LE (EMERGENCY LIVE)  
BLACK - NE (EMERGENCY NEUTRAL)  
RED - A+  
BLACK - B-

BLEU - N (NEUTRE)  
VERT ET JAUNE - (TERRE)  
MARRON - L (PHASE)  
GRIS - LE (UNI. SECOURS PHASE)  
NOIR - NE (UNI. SECOURS NEUTRE)  
ROUGE - A+  
NOIR - B-

BLAU - N (NEUTRAL)  
GRÜN UND GELB - (ERDE)  
BRAUN - L (PHASE)  
GRAU - LE (NOTLICHT PHASE)  
SCHWARZ - NE (NOTLICHT NEUTRAL)  
ROT - A+  
SCHWARZ - B-

AZUL - N (NEUTRO)  
VERDE E AMARELO - (TERRA)  
CASTANHO - L (FASE)  
CINZA - LE (EMERGÊNCIA FASE)  
PRETO - NE (EMERGÊNCIA NEUTRO)  
VERMELHO - A+  
PRETO - B-

AZUL - N (NEUTRAL)  
VERDE Y AMARILLO - (TIERRA)  
MARRÓN - L (FASE)  
GRIS - LE (EMERGÊNCIA FASE)  
NEGRO - NE (EMERGENCIA NEUTRAL)  
ROJO - A+  
NEGRO - B-

## 8.2 - REBA 65 /E LED DALI + EM + TEL.

POWER SUPPLY HF WITH EMERGENCY KIT AND TELECOMMAND  
CÂBLAGE HF AVEC UNITE DE SECOURS ET TELECOMMANDE  
VERDRÄHTUNG FÜR HF MIT NOTLICHTEINSATZ UND TELEKOMMAND  
ALIMENTAÇÃO ELÉCTRICA HF COM KIT EMERGÊNCIA E TELECOMANDO  
ELECTRIFICACIÓN HF CON KIT DE EMERGENCIA Y TELEMANDABLE

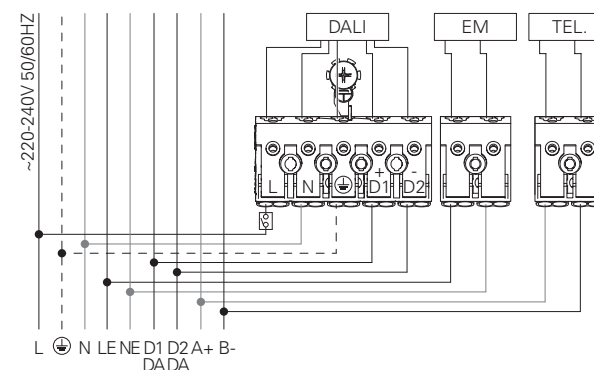

BLUE - N (NEUTRAL)  
GREEN AND YELLOW - (EARTH)  
BROWN - L (LIVE)  
GREY - D1+  
BLACK - D2-  
BLUE - NE (EMERGENCY NEUTRAL)  
BROWN - LE (EMERGENCY LIVE)  
RED - A+  
BLACK - B-

BLEU - N (NEUTRE)  
VERT ET JAUNE - (TERRE)  
MARRON - L (PHASE)  
GRIS - D1+  
NOIR - D2-  
BLEU - NE (UNI. SECOURS NEUTRE)  
MARRON - LE (UNI. SECOURS PHASE)  
ROUGE - A+  
NOIR - B-

BLAU - N (NEUTRAL)  
GRÜN UND GELB - (ERDE)  
BRAUN - L (PHASE)  
GRAU - D1+  
SCHWARZ - D2-  
BLAU - NE (NOTLICHT NEUTRAL)  
BRAUN - LE (NOTLICHT PHASE)  
ROT - A+  
SCHWARZ - B-

AZUL - N (NEUTRO)  
VERDE E AMARELO - (TERRA)  
CASTANHO - L (FASE)  
CINZA - D1+  
PRETO - D2-  
AZUL - NE (EMERGÊNCIA NEUTRO)  
CASTANHO - LE (EMERGÊNCIA FASE)  
VERMELHO - A+  
PRETO - B-

AZUL - N (NEUTRAL)  
VERDE Y AMARILLO - (TIERRA)  
MARRÓN - L (FASE)  
GRIS - D1+  
NEGRO - D2-  
AZUL - NE (EMERGENCIA NEUTRAL)  
MARRÓN - LE (EMERGENCIA FASE)  
ROJO - A+  
NEGRO - B-