

REBA 65 LED Line SUSPENDED SUSPENDU PENDELVERSION SUSPensa SUSPENDIDO

EN INSTALLATION INSTRUCTIONS
FR INSTRUCTIONS D'INSTALLATION
DE INSTALLATIONSANLEITUNG
PT INSTRUÇÕES DE MONTAGEM
ES INSTRUCCIONES DE MONTAJE

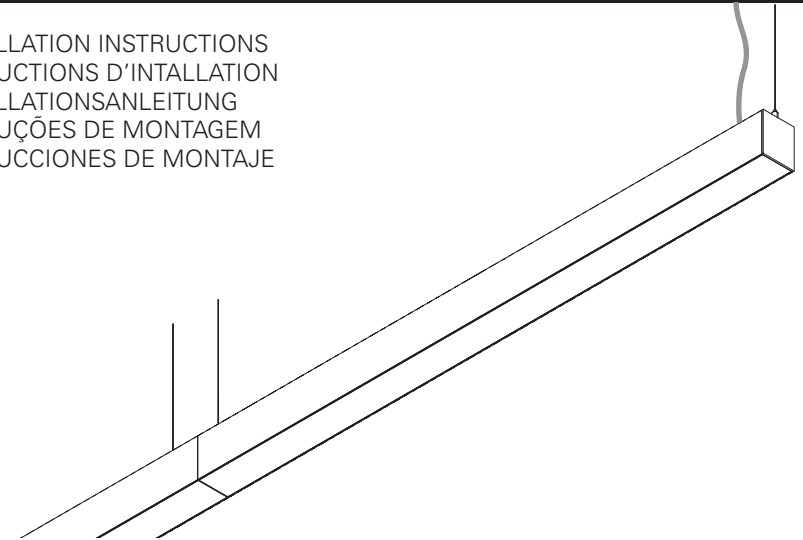

REBA 65 LED Line

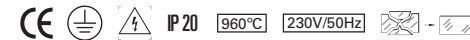

EN Warning: The light source contained in the luminaire should be replaced only by the manufacturer. Do not use this equipment in areas containing chemical agents: acids, solvents, paints, silicones, coatings, etc.

FR Advertissement: La source de lumière contenue dans la luminaire doit être remplacée par le fabricant. En cas d'anomalie détectée, contactez le fabricant. Ne pas utiliser l'équipement dans les zones qui contiennent des agents chimiques: acides, solvants, peintures, silicones, vernis, etc.

DE Warnung: Die in der Leuchte enthalten Lichtquelle sollte nur vom Hersteller ersetzt werden. Verwenden Sie dieses Gerät nicht in Bereichen mit chemischen Mitteln: Säuren, Lösungsmittel, Farben, Silikone, Beschichtungen etc.

PT Atenção: A fonte de luz contida na luminária deve ser substituída unicamente pelo fabricante. Qualquer anomalia detectada contactar o fabricante. Não utilizar o equipamento em zonas que contenham agentes químicos: ácidos, solventes, tintas, silicones, vernizes, etc.

ES Atención: La fuente de luz contenida en la luminaria debe ser sustituida unicamente por el fabricante. Cualquier anomalia detectada contactar con el fabricante. No utilizar la luminaria en zonas que contengan agentes químicos: ácidos, disolventes, pinturas, siliconas, barnices, etc."



EN Caution, risk of electric shock.

FR Attention, risque de choc électrique.

DE Achtung, Gefahr eines Stromschlags.

PT Cuidado, risco de choque elétrico.

ES Precaución, riesgo de descarga eléctrica.



EN If glass or diffuser break or crack, please replace it.

FR En cas de casse ou fissurement, remplacez le verre ou diffuseur.

DE Bei Bruch oder Riss, Glas oder Diffuser ersetzen.

PT Em caso de quebra ou fissura, substituir o vidro ou difusor.

ES En caso de rotura o fisura, sustituir el vidrio o difusor.



EN Read carefully the general terms and conditions of use and environmental concern with recycling attached. | **FR** Lire attentivement les conditions générales d'utilisations et de préoccupation environnementales avec les recyclage ci-joint. | **DE** Bitte lesen Sie de Allgemeinen Geschäftsbedingungen und Umweltbewusstsein über Recycling angeschlossen. | **PT** Ler atentamente as condições gerais de uso e preocupação ambiental com a reciclagem, em anexo. | **ES** Lea atentamente las condiciones generales de uso y preocupación ambiental con el reciclaje adjuntos.

EN We reserve the right to make changes on technical specifications, design and installation leaflet without prior notice. | **FR** Sous réserve de modifications au niveau de la conception, des spécifications techniques et de la notice. | **DE** Änderungen von Entwurf, technischen Daten und Bedienungsanleitungen bleiben vorbehalten. | **PT** O fabricante reserva-se no direito de realizar modificações no desenho, especificações técnicas e folheto, sem aviso prévio. | **ES** El fabricante se reserva el derecho de realizar modificaciones en el diseño, las especificaciones técnicas y el folleto.

REBA 65 LED Line



EN SUSPENDED VERSION
FR VERSION SUSPENDU
DE PENDELVERSION
PT VERSÃO SUSPENSA
ES VERSIÓN SUSPENDIDO

EN Accessories
FR Accessoires
DE Zubehör
PT Acessórios
ES Accesorios

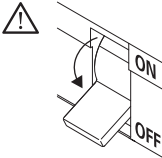
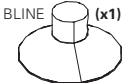

SUSPENSION OPTION
OPTION SUSPENSION
OPTIONEN AUFHÄNGUNG
OPÇÃO SUSPENSÃO
OPCIÓN SUSPENSIÓN

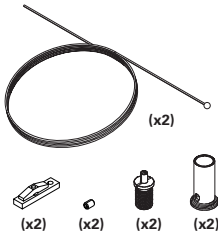

CEILING ROSE OPTION
OPTION PATÈRE DE SUSPENSION
OPTIONEN DECKENBALDACHIN
OPÇÃO CAIXA DE ALIMENTAÇÃO
OPCIÓN BASE DE TECHO

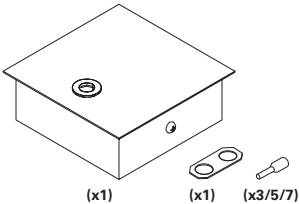

CURRENT SUPPLY CABLE OPTION
OPTION CÂBLE D'ALIMENTATION
OPTIONEN EINSPEISUNGSKABEL
OPÇÃO CABO DE ALIMENTAÇÃO
OPCIÓN CABLE DE ALIMENTACIÓN

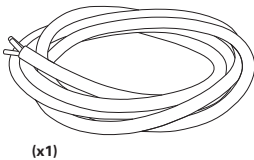

START KIT OPTION
OPTION KIT DÉBUT DE LIGNE
OPTION START KIT
OPÇÃO START KIT
OPCIÓN START KIT

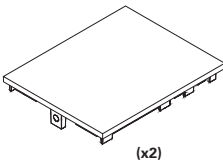

BLANK PARTS OPTION
OPTION MODULE VIDE
OPTION BLINDMODUL
OPÇÃO MÓDULOS CEGOS
OPCIÓN MÓDULOS CIEGOS

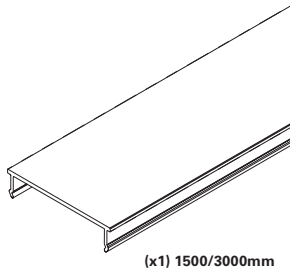

BODY CONNECTOR KIT OPTION
OPTION KIT UNION
OPTION VERBINDUNGS KIT
OPÇÃO KIT DE UNIÃO
OPCIÓN KIT DE UNIÓN

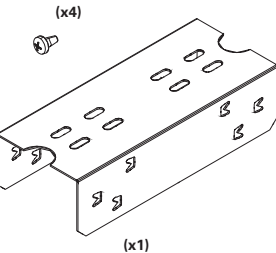

25 - REBA 65 LED Line

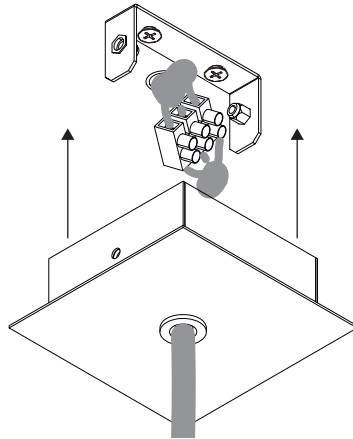

26 - REBA 65 LED Line

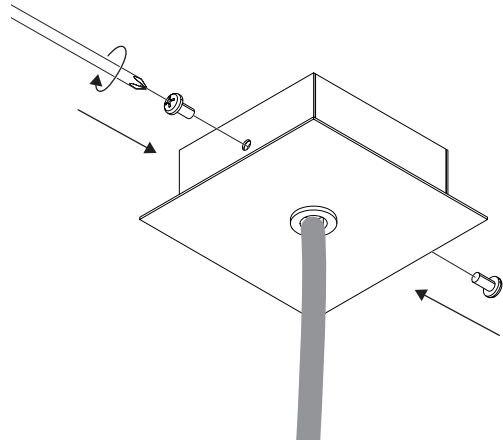

21 - REBA 65 LED Line

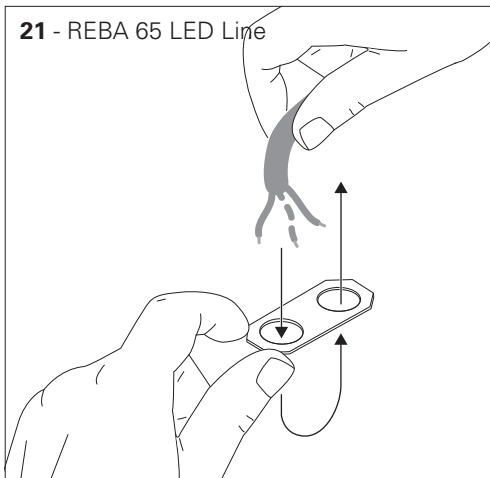

22 - REBA 65 LED Line

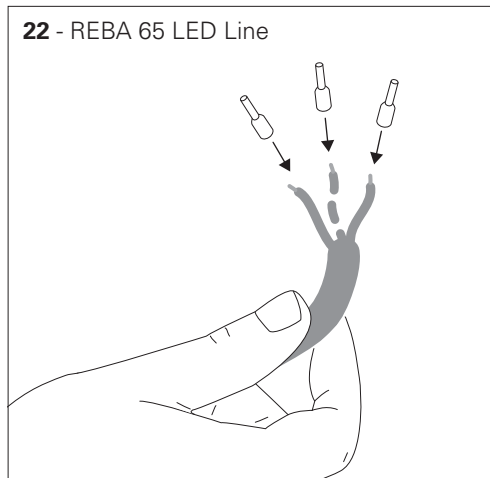

1 - REBA 65 LED Line

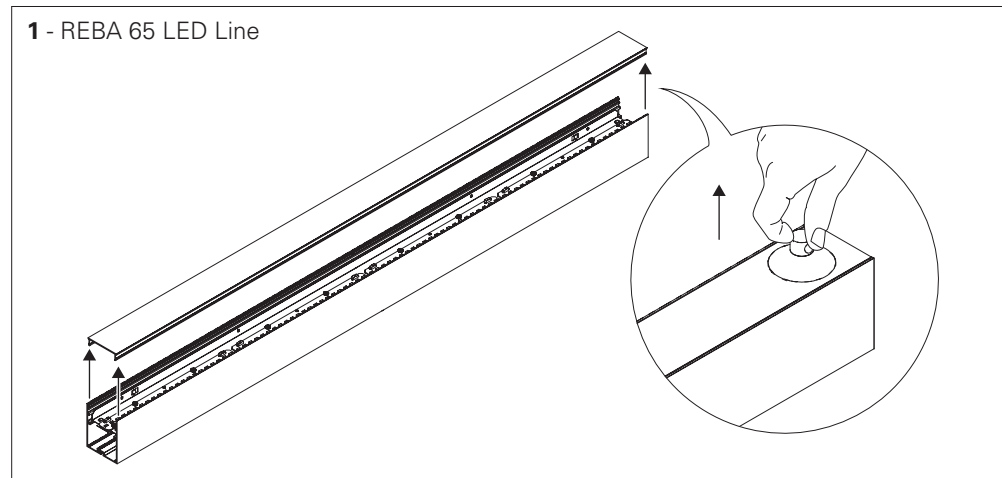

23 - REBA 65 LED Line - HF

STANDARD POWER SUPPLY
CÂBLAGE STRANDARD
STANDARD VERDRAHTUNG
ALIMENTAÇÃO ELÉCTRICA STANDARD
ELECTRIFICACIÓN ESTÁNDAR

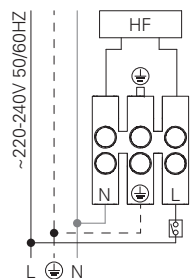

DALI

DIMMABLE POWER SUPPLY
CÂBLAGE AVEC GRADATION
DIMMBARE VERDRAHTUNG
ALIMENTAÇÃO ELÉCTRICA COM REGULAÇÃO
ELECTRIFICACIÓN CON REGULACIÓN

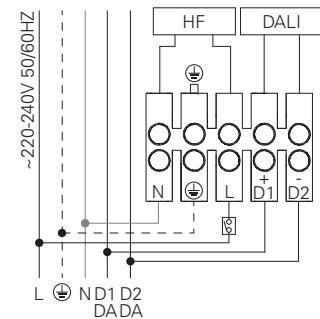

2 - REBA 65 LED Line

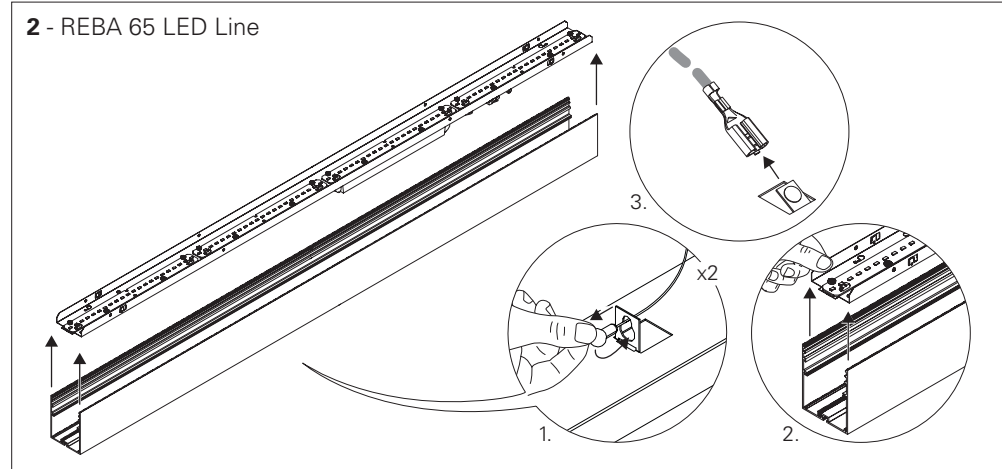

24 - REBA 65 LED Line

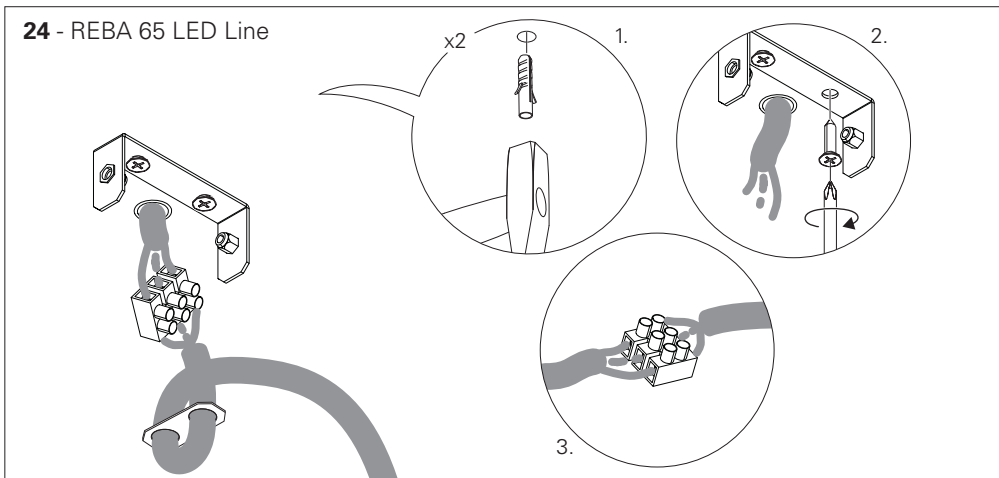

3 - REBA 65 LED Line

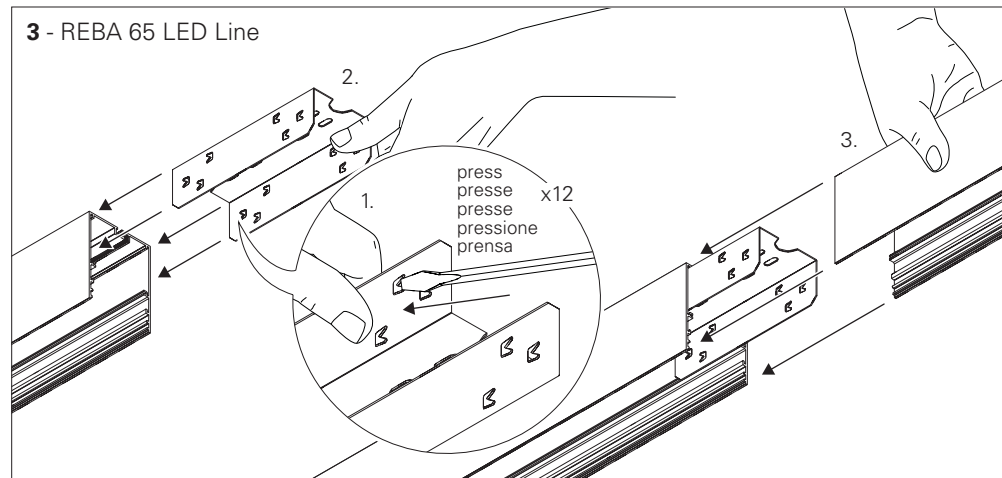

4 - REBA 65 LED Line

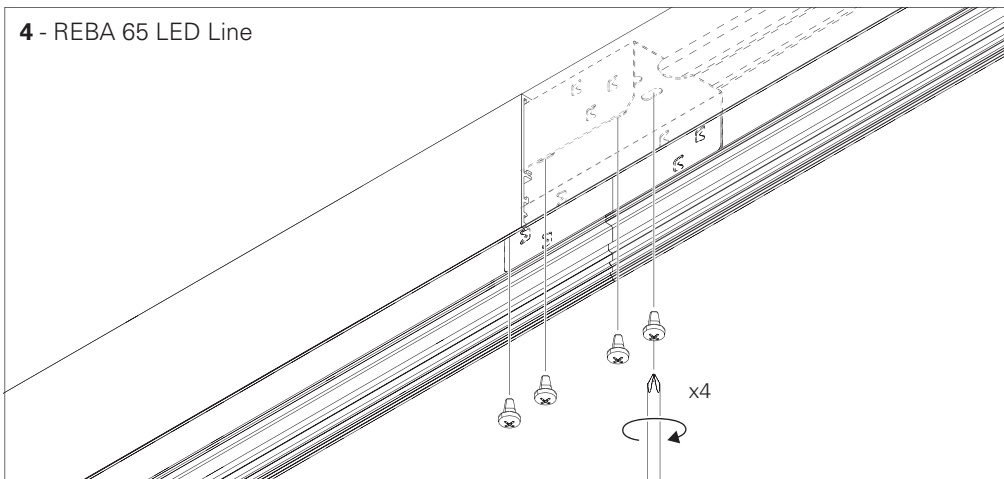

5 - REBA 65 LED Line

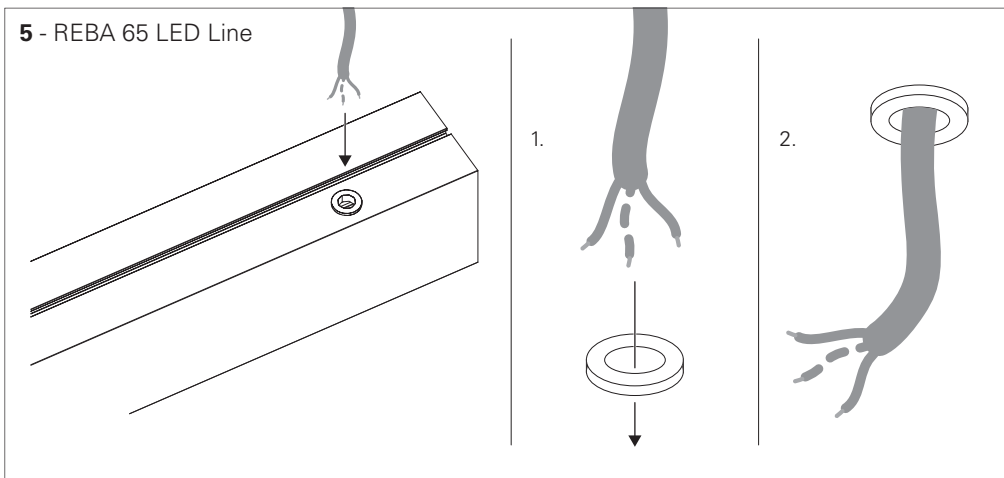

6 - REBA 65 LED Line

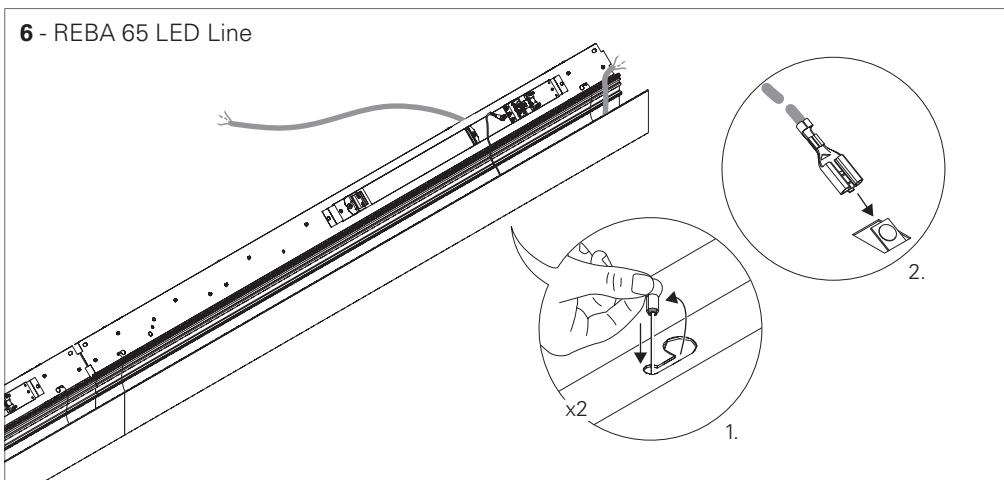

17 - REBA 65 LED Line

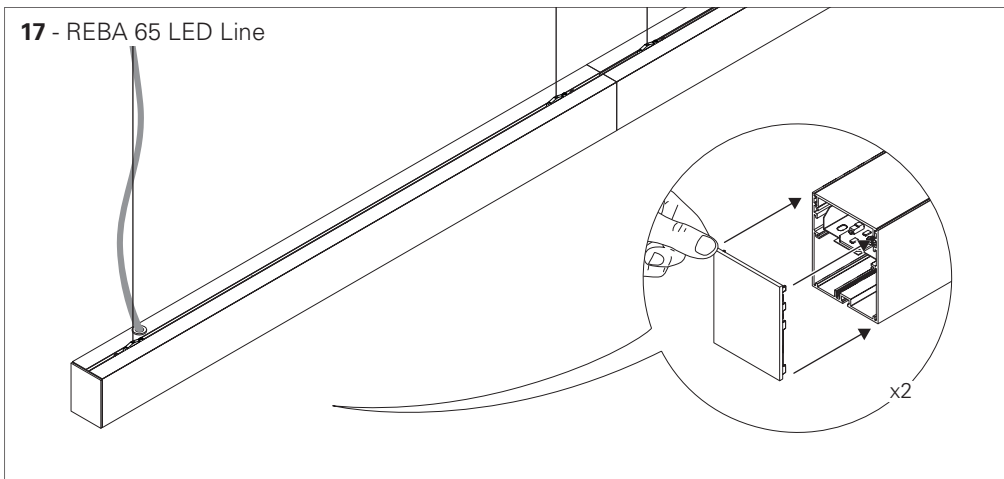

18 - REBA 65 LED Line

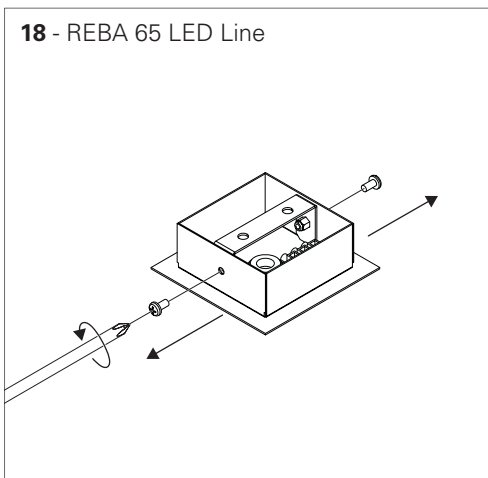

19 - REBA 65 LED Line

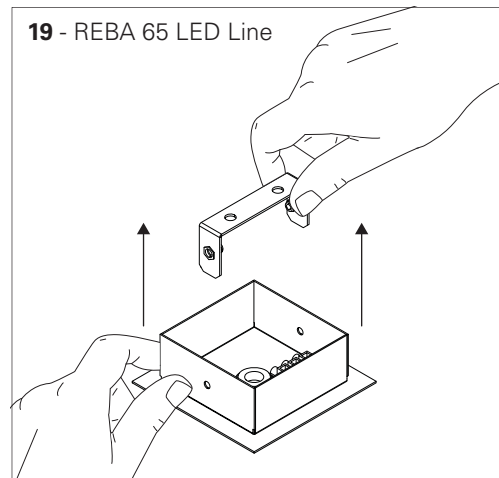

20 - REBA 65 LED Line

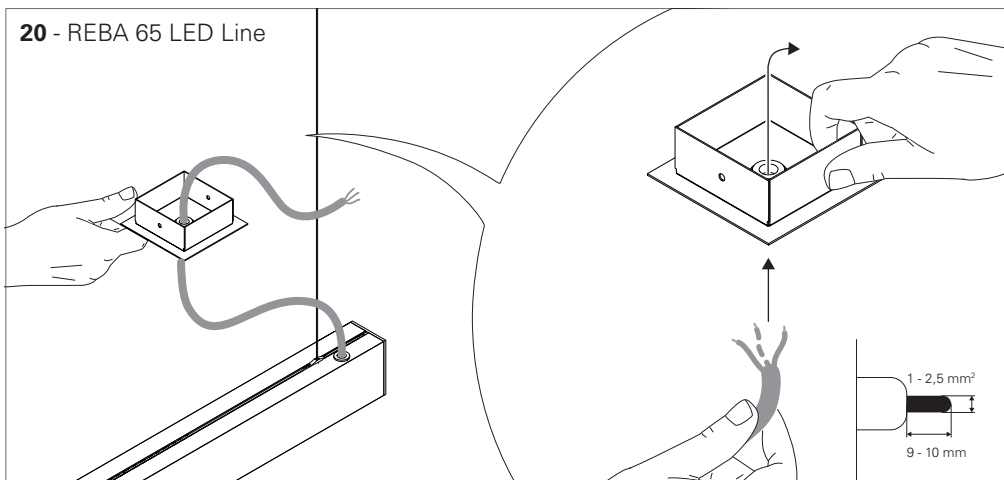

14 - REBA 65 LED Line

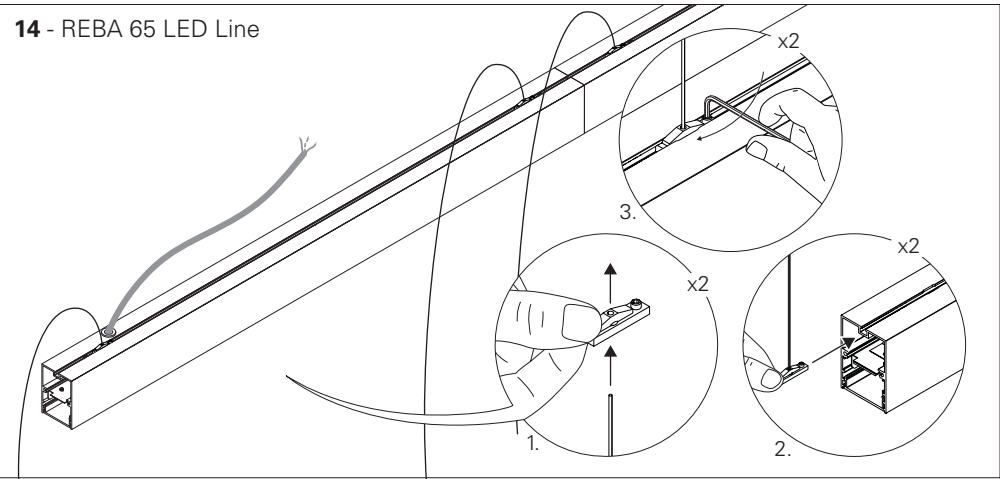

15 - REBA 65 LED Line

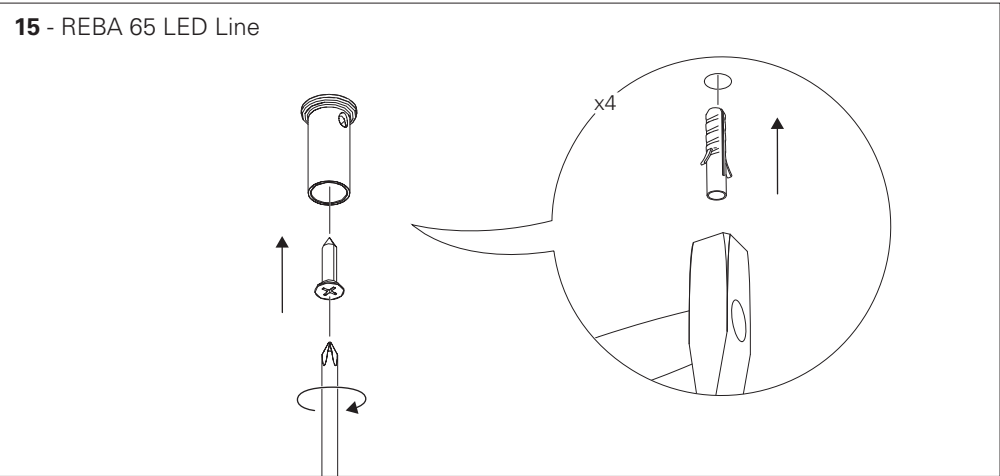

16 - REBA 65 LED Line

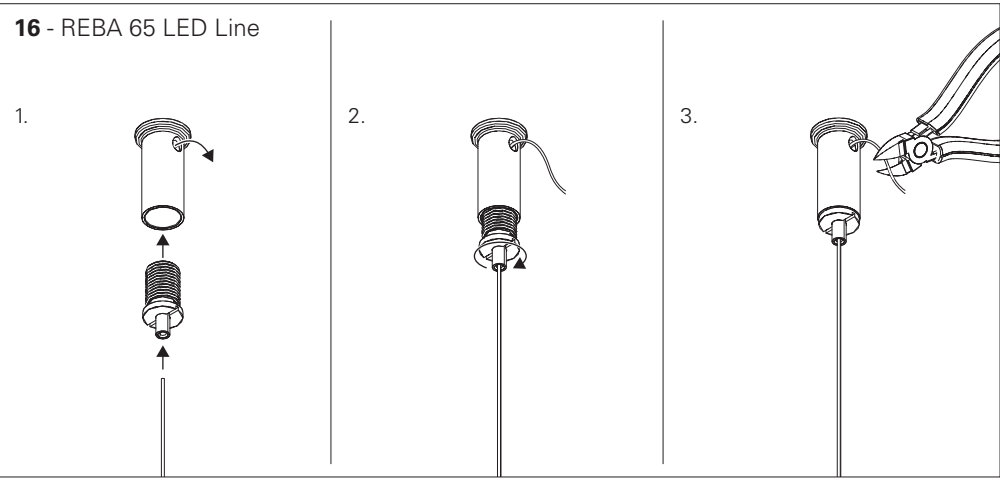

7 - REBA 65 LED Line

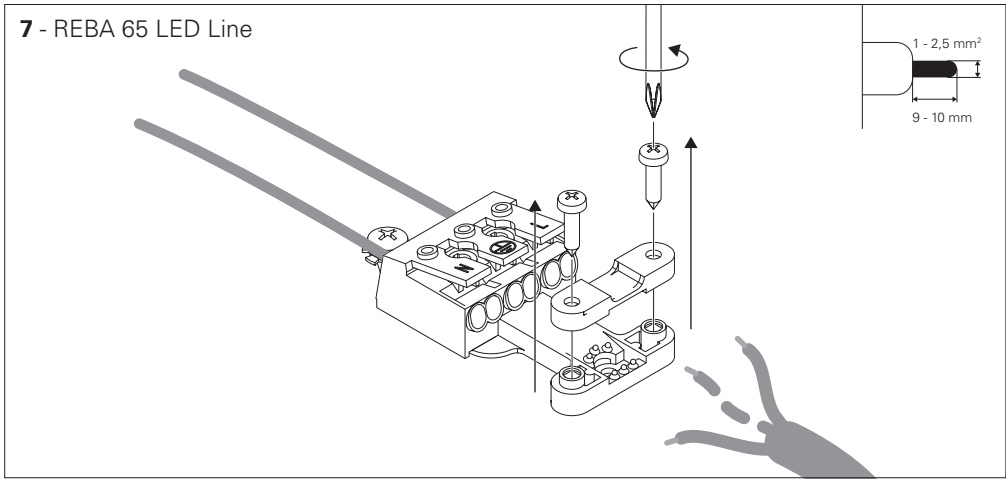

8 - REBA 65 LED Line HF

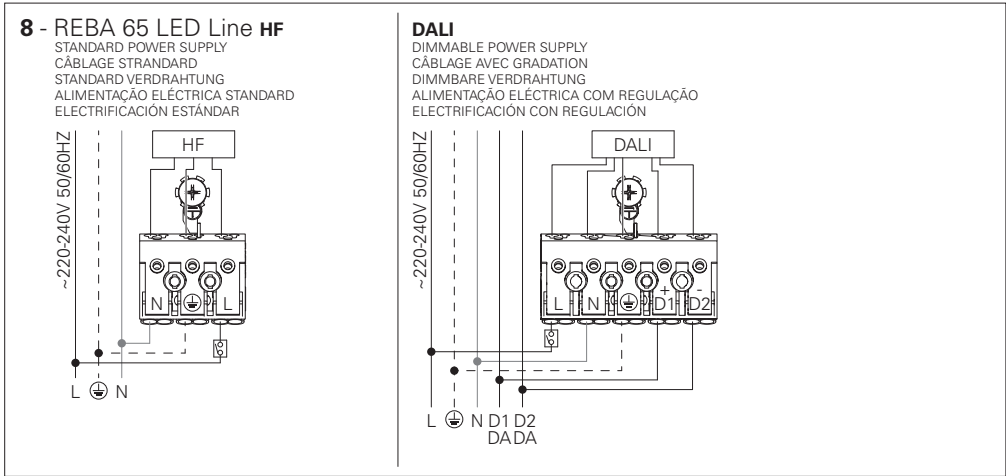

8 - REBA 65 LED Line HF + EM

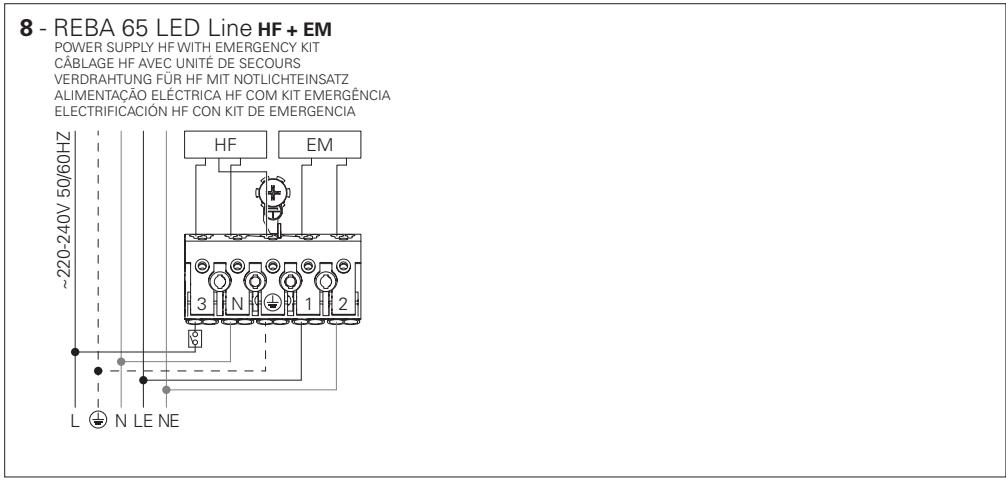

8 - REBA 65 LED Line DALI + EM

DIMMABLE POWER SUPPLY AND EMERGENCY KIT
CÂBLAGE AVEC GRADATION ET UNITÉ DE SECOURS
STROMVERSÖRGUNG FÜR DIMMBARE LEUCHTE ODER MIT NOTLICHT-EINSATZ
ALIMENTAÇÃO ELÉCTRICA COM REGULAÇÃO E KIT EMERGÊNCIA
ELECTRIFICACIÓN CON REGULACIÓN Y KIT DE EMERGENCIA

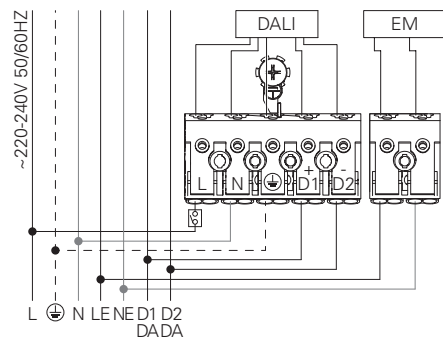

9 - REBA 65 LED Line

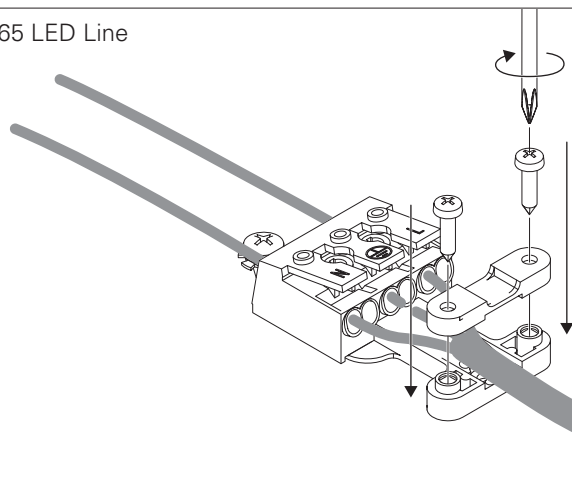

10 - REBA 65 LED Line

CONNECTORS OPTION
OPTION CONNECTEURS
OPTION STECKER
OPÇÃO CONECTORES
OPCIÓN CONECTORES

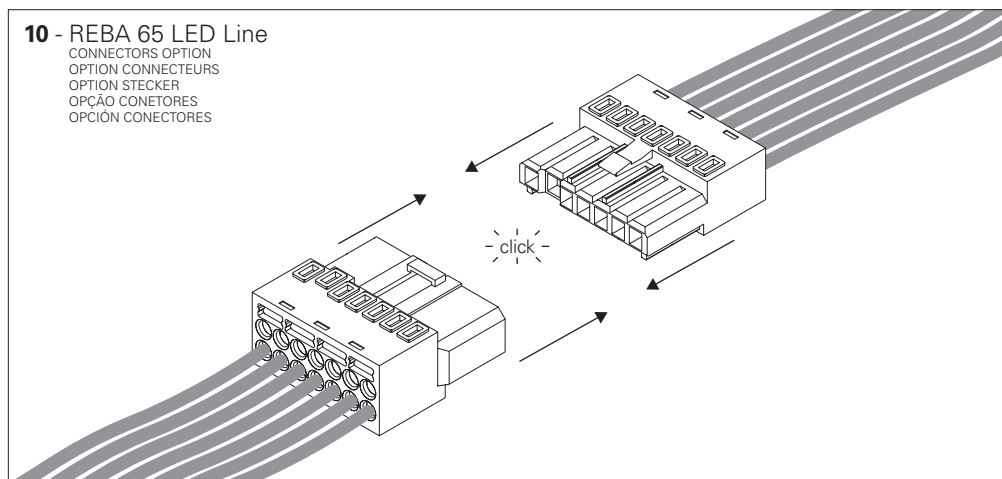

11 - REBA 65 LED Line

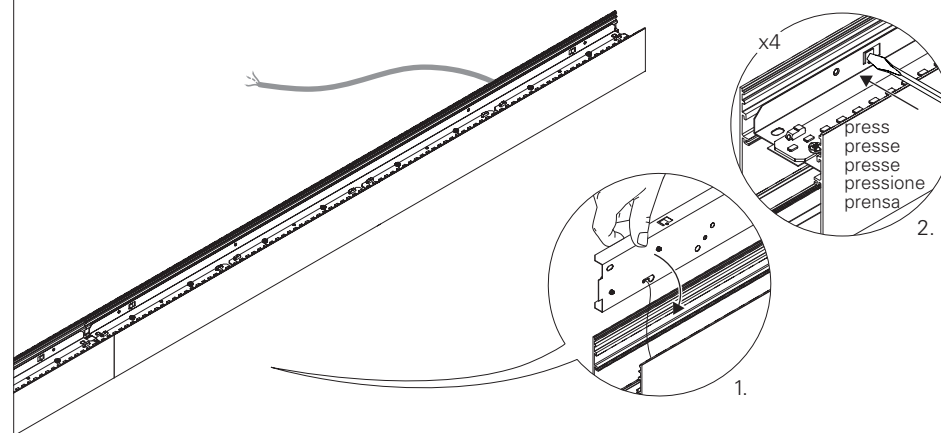

12 - REBA 65 LED Line

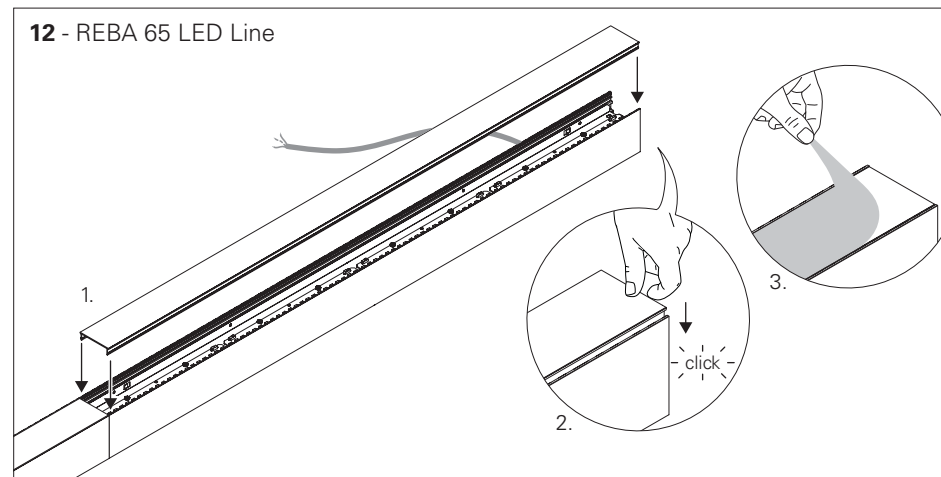

13 - REBA 65 LED Line

BLANK PARTS OPTION
OPTION MODULE VIDE
OPTION BLINDMODUL
OPÇÃO MÓDULOS CEGOS
OPCIÓN MÓDULOS CIEGOS

