

## REBA 65 /T LED Line

**EN** INSTALLATION INSTRUCTIONS  
**FR** INSTRUCTIONS D'INTALLATION  
**DE** INSTALLATIONSANLEITUNG  
**PT** INSTRUÇÕES DE MONTAGEM  
**ES** INSTRUCCIONES DE MONTAJE

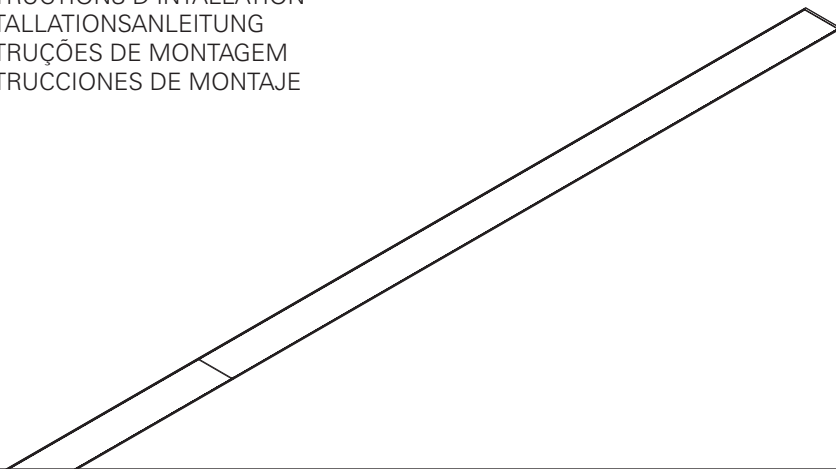

### REBA 65 /T LED Line



**EN** WARNING: THE LIGHT SOURCE CONTAINED IN THE LUMINAIRE SHOULD BE REPLACED ONLY BY THE MANUFACTURER. DO NOT USE THIS EQUIPMENT IN AREAS CONTAINING CHEMICAL AGENTS: ACIDS, SOLVENTS, PAINTS, SILICONES, COATINGS, ETC.

**FR** ADVERTISSEMENT: LA SOURCE DE LUMIÈRE CONTENUE DANS LA LUMINAIRE DOIT ÊTRE REMPLACÉE PAR LE FABRICANT. EN CAS D'ANOMALIE DETECTÉE, CONTACTEZ LE FABRICANT. NE PAS UTILISER L'EQUIPEMENT DANS LES ZONES QUI CONTIENNENT DES AGENTS CHIMIQUES: ACIDES, SOLVANTS, PEINTURES, SILICONES, VERNIS, ETC.

**DE** WARNUNG: DIE IN DER LEUCHTE ENTHALTEN LICHTQUELLE SOLLTE NUR VOM HERSTELLER ERSETZT WERDEN. VERWENDEN SIE DIESES GERÄT NICHT IN BEREICHEN MIT CHEMISCHEN MITTELN: SÄUREN, LÖSUNGSMITTEL, FARBEN, SILIKONE, BESCHICHTUNGEN ETC.

**PT** ATENÇÃO: A FONTE DE LUZ CONTIDA NA LUMINÁRIA DEVE SER SUBSTITUÍDA UNICAMENTE PELO FABRICANTE. QUALQUER ANOMALIA DETECTADA CONTACTAR O FABRICANTE. NÃO UTILIZAR O EQUIPAMENTO EM ZONAS QUE CONTENHAM AGENTES QUÍMICOS: ÁCIDOS, SOLVENTES, TINTAS, SILICÓNES, VERNIZES, ETC.

**ES** ATENCIÓN: LA FUENTE DE LUZ CONTENIDA EN LA LUMINARIA DEBE SER SUSTITUIDA UNICAMENTE POR EL FABRICANTE. CUALQUIER ANOMALIA DETECTADA CONTACTAR CON EL FABRICANTE. NO UTILIZAR

LA LUMINARIA EN ZONAS QUE CONTENGAN AGENTES QUÍMICOS: ÁCIDOS, DISOLVENTES, PINTURAS, SILICONAS, BARNICES, ETC."



**EN** CAUTION, RISK OF ELECTRIC SHOCK.

**FR** ATTENTION, RISQUE DE CHOC ÉLECTRIQUE.

**DE** ACHTUNG, GEFAHR EINES STROMSCHLAGS.

**PT** CUIDADO, RISCO DE CHOQUE ELÉTRICO.

**ES** PRECAUCIÓN, RIESGO DE DESCARGA ELÉCTRICA.



**EN** LUMINAIRE CAN NOT BE COVERED WITH THERMAL INSULATION.

**FR** LUMINAIRES NE POUVANT PAS ÊTRE RECOUVERTS DE MATÉRIEL ISOLANT THERMIQUE.

**DE** LEUCHTE DIE NICHT MIT THERMISCH ISOLIERENDEN MATERIAL BEDECKT SEIN KANN.

**PT** LUMINÁRIA QUE NÃO PODE SER COBERTA COM MATERIAL ISOLANTE TÉRMICO.

**ES** LA LUMINARIA NO PUEDE SER CUBIERTA CON MATERIAL AISLANTE TÉRMICO.



**EN** Read carefully the general terms and conditions of use and environmental concern with recycling attached. | **FR** Lire attentivement les conditions générales d'utilisations et de préoccupation environnementales avec les recyclage ci-joint. | **DE** Bitte lesen Sie de Allgemeinen Geschäftsbedingungen und Umweltbewusstsein über Recycling angeschlossen. | **PT** Ler atentamente as condições gerais uso e preocupação ambiental com a reciclagem em anexo. | **ES** Lea atentamente las condiciones generales de uso y preocupación ambiental con el reciclaje adjuntos.

**EN** We reserve the right to make changes on technical specifications, design and installation leaflet without prior notice. | **FR** Sous réserve de modifications au niveau de la conception, des spécifications techniques et de la notice. | **DE** Änderungen von Entwurf, technischen Daten und Bedienungsanleitungen bleiben vorbehalten. | **PT** O fabricante reserva-se no direito de realizar modificações no desenho, especificações técnicas e folheto, sem aviso prévio. | **ES** El fabricante se reserva el derecho de realizar modificaciones en el diseño, las especificaciones técnicas y el folleto.

# REBA 65 /T LED Line

EN Accessories  
FR Accessoires  
DE Zubehör  
PT Acessórios  
ES Accesorios

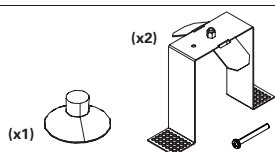

(mm)



842x65x80	842x66
1122x65x80	1122x66
1402x65x80	1402x66
1682x65x80	1682x66
1964x65x80	1964x66
2244x65x80	2244x66
2524x65x80	2524x66
2804x65x80	2804x66

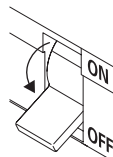

OPTIONS  
OPTIONS  
OPTIONEN  
OPÇÕES  
OPCIÓN

START KIT OPTION  
OPTION KIT DÉBUT DE LIGNE  
OPTION START KIT  
OPÇÃO START KIT  
OPCIÓN START KIT

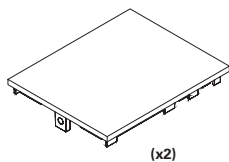

CONNECTORS OPTION  
OPTION CONNECTEURS  
OPTION STECKER  
OPÇÃO CONECTORES  
OPCIÓN CONECTORES

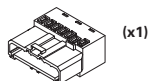

or / ou / oder / ou / o

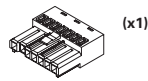

or / ou / oder / ou / o

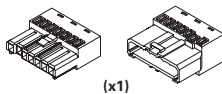

BODY CONNECTOR KIT OPTION  
OPTION KIT UNION  
OPTION VERBINDUNGS KIT  
OPÇÃO KIT DE UNIÃO  
OPCIÓN KIT DE UNIÓN

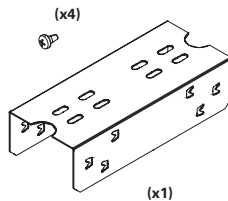

SAFETY CABLE OPTION  
OPTION FILIN D'ACIER  
OPTIONEN STAHL SICHERHEITSKABEL  
OPÇÃO CABO DE SEGURANÇA  
OPCIÓN CABLE DE SEGURIDAD

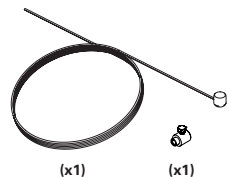

BLANK PARTS OPTION  
OPTION MODULE VIDE  
OPTION BLINDMODUL  
OPÇÃO MÓDULOS CEGOS  
OPCIÓN MÓDULOS CIEGOS

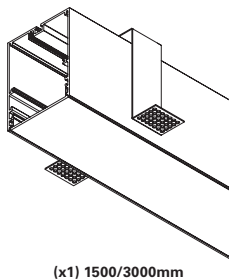

LIGHT CORNERS OPTION  
OPTION ANGLES LUMINEUX  
OPTION LICHTECKE  
OPÇÃO CANTOS ILUMINADOS  
OPCIÓN ÁNGULOS ILUMINADOS

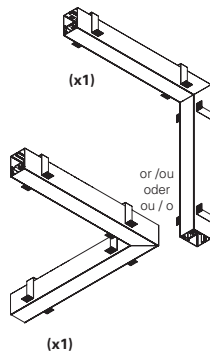

### 1 - REBA 65 /T LED Line

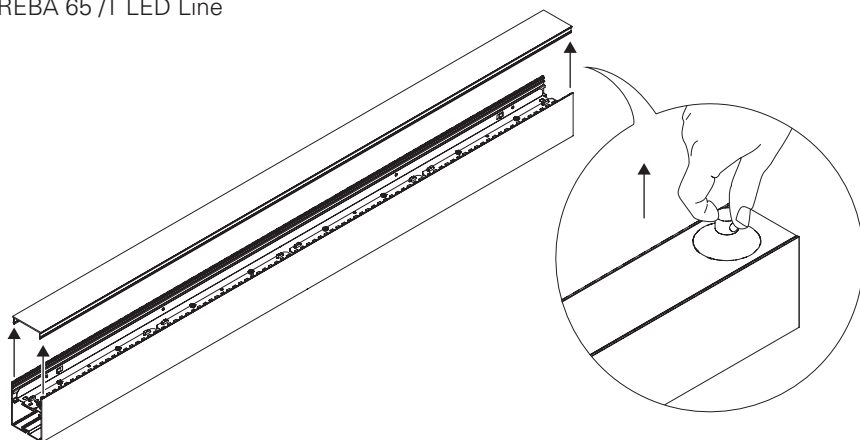

### 2 - REBA 65 /T LED Line

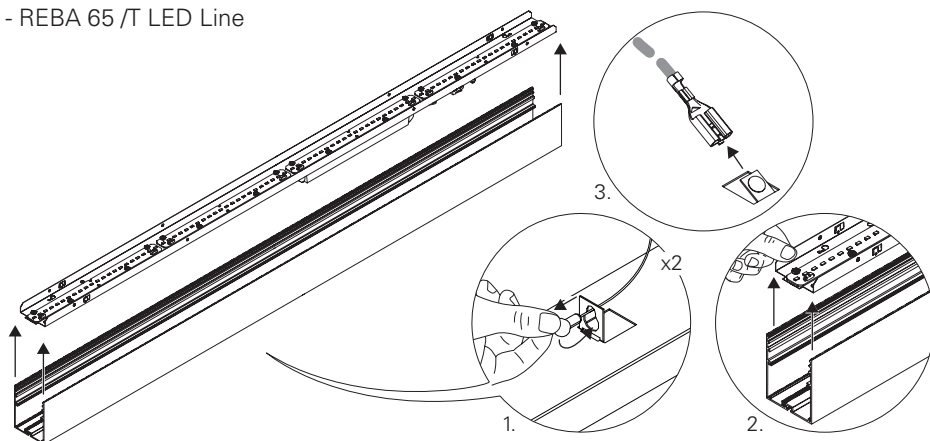

### 3 - REBA 65 /T LED Line

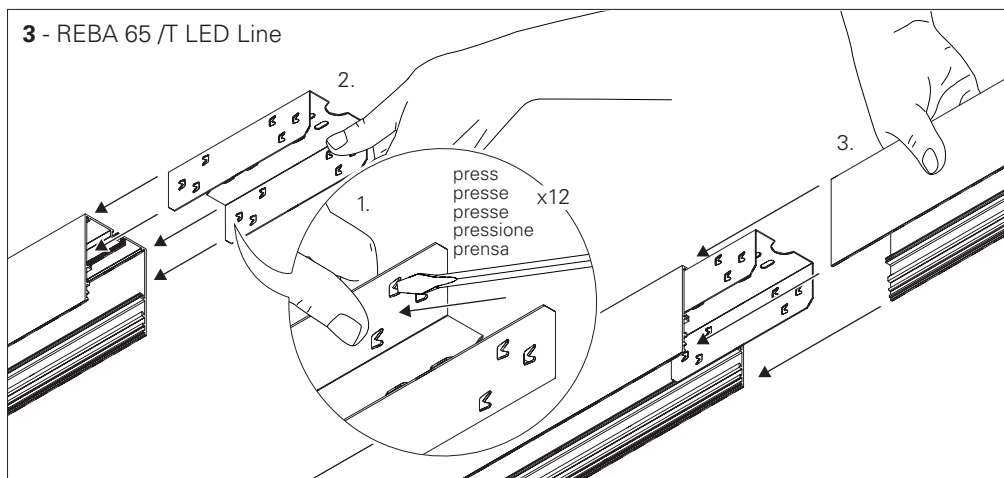

#### 4 - REBA 65 /T LED Line

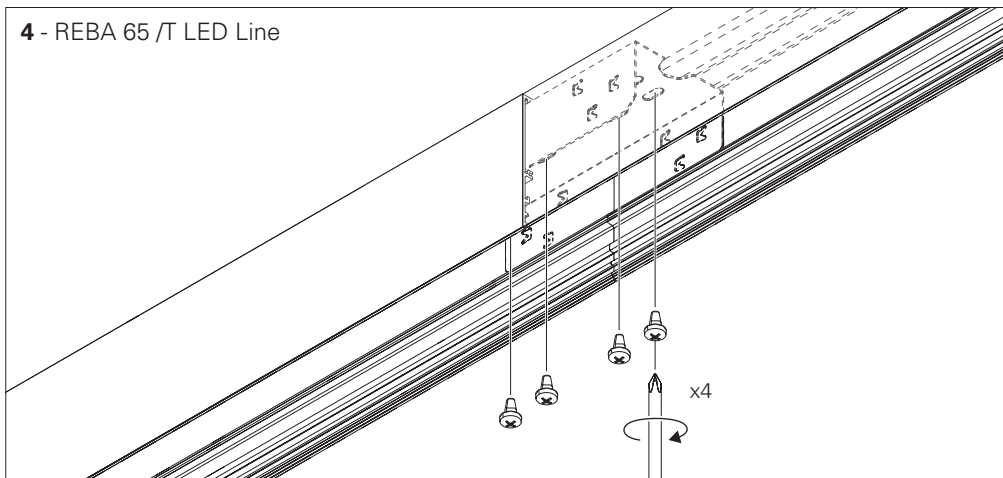

#### 5 - REBA 65 /T LED Line

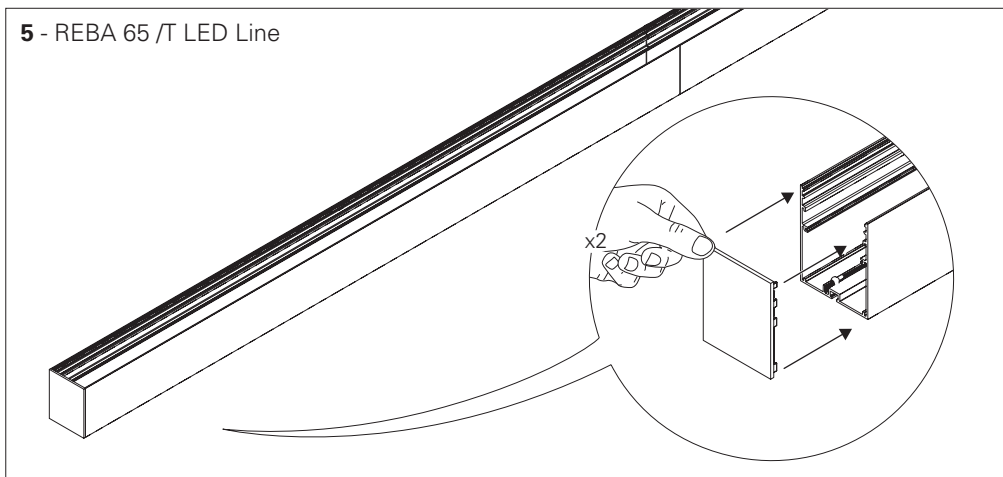

#### 6 - REBA 65 /T LED Line

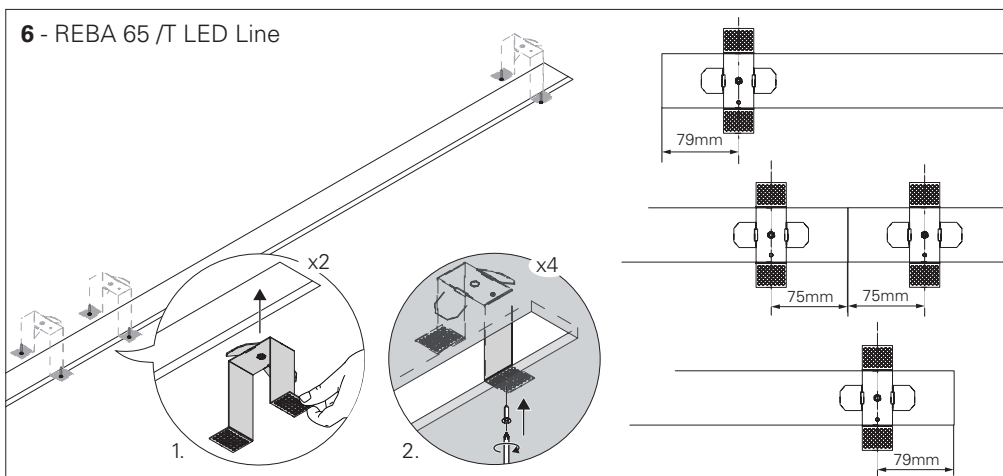

### 7 - REBA 65 /T LED Line

SAFETY CABLE OPTION  
OPTIONEN FILIN D'ACIER  
OPTIONEN STAHL SICHERHEITSKABEL  
OPÇÃO CABO DE SEGURANÇA  
OPCIÓN CABLE DE SEGURIDAD

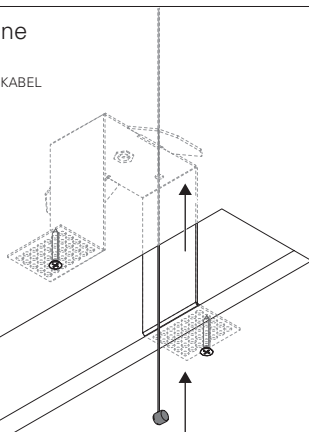

### 8 - REBA 65 /T LED Line

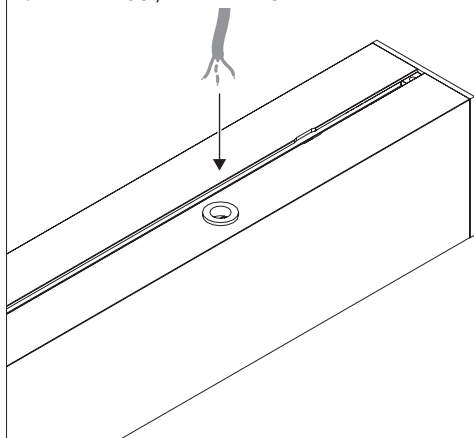

1.



2.

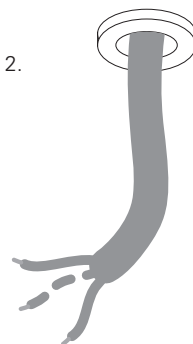

### 9 - REBA 65 /T LED Line

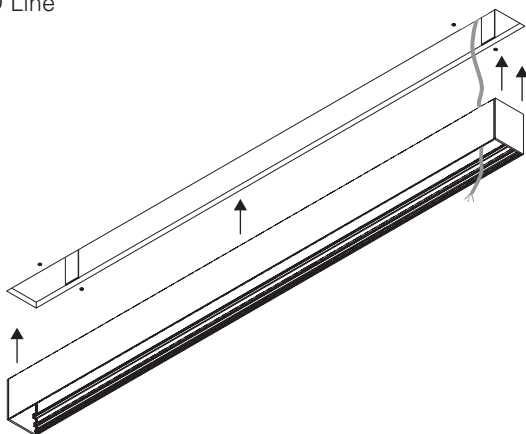

**10 - REBA 65 /T LED Line**

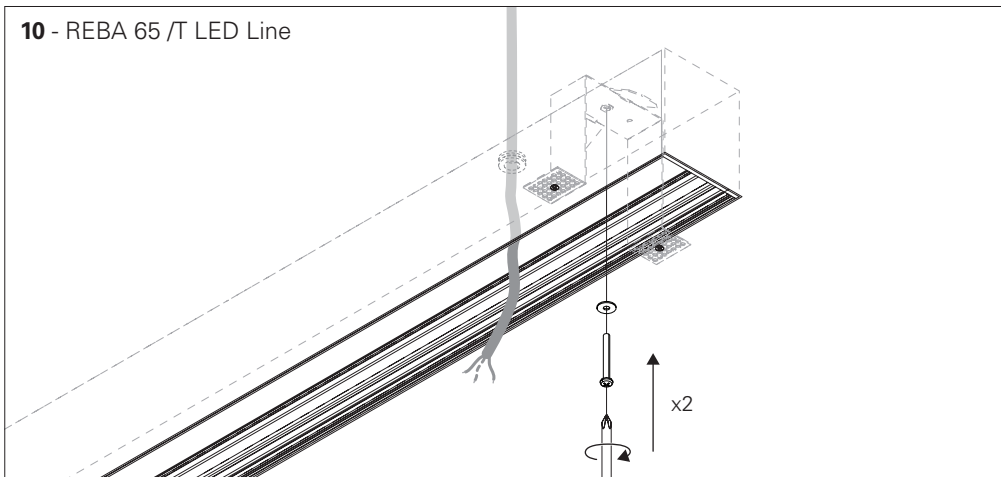

**11 - REBA 65 /T LED Line**

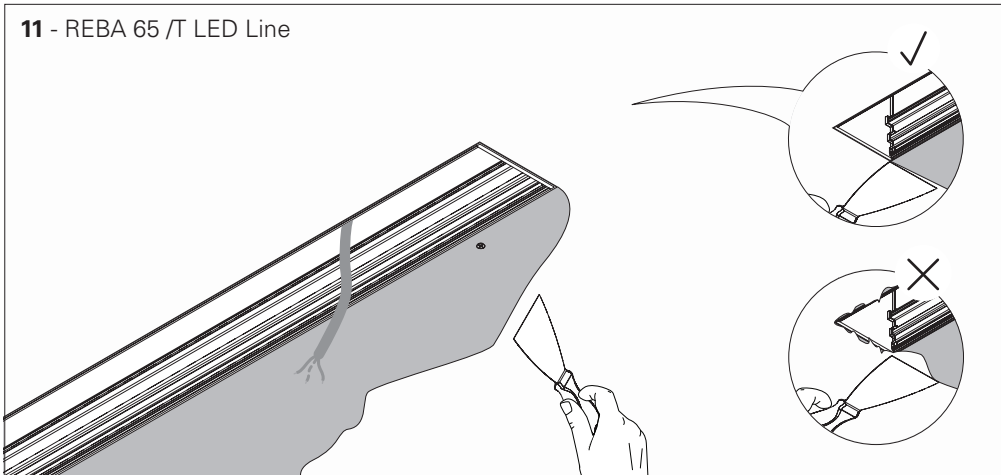

**12 - REBA 65 /T LED Line**

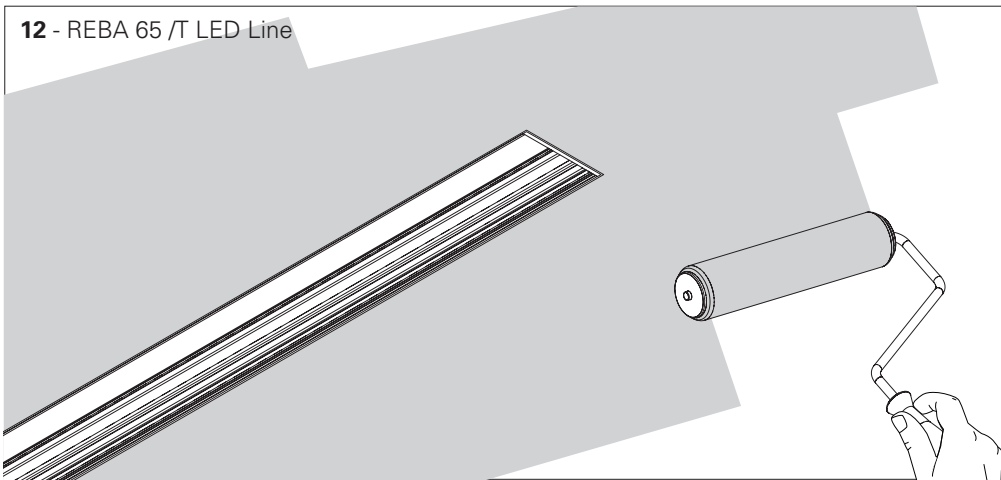

### 13 - REBA 65 /T LED Line

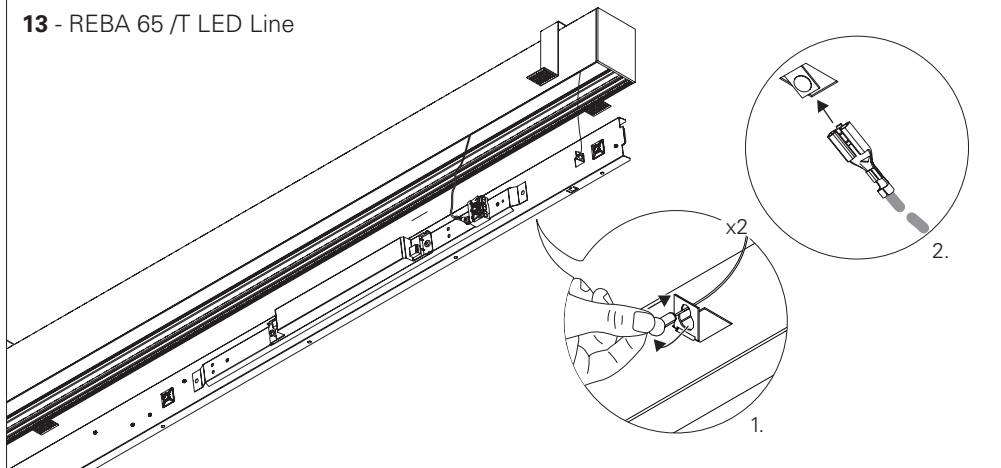

### 14 - REBA 65 /T LED Line

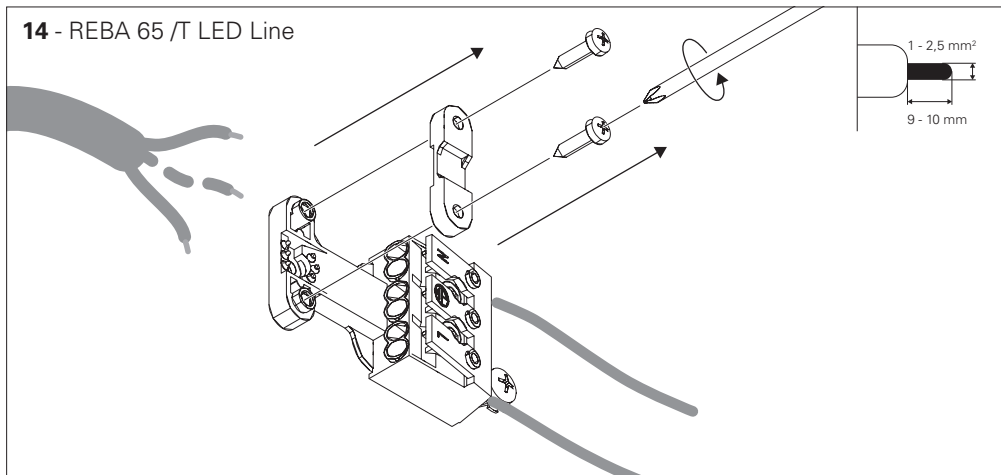

### 15 - REBA 65 /T LED Line HF

STANDARD POWER SUPPLY  
CÂBLAGE STANDARD  
STANDARD VERDRÄHTUNG  
ALIMENTAÇÃO ELÉCTRICA STANDARD  
ELECTRIFICACIÓN ESTÁNDAR

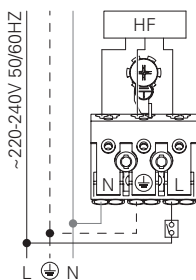

#### DALI

DIMMABLE POWER SUPPLY  
CÂBLAGE AVEC GRADATION  
DIMMBARE VERDRÄHTUNG  
ALIMENTAÇÃO ELÉCTRICA COM REGULAÇÃO  
ELECTRIFICACIÓN CON REGULACIÓN

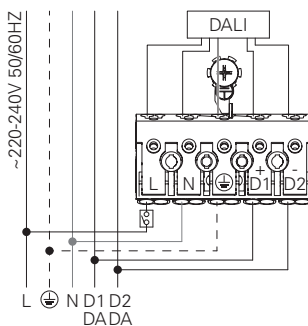

### 15.1 - REBA 65 /T LED Line HF + EM + TEL.

POWER SUPPLY HF WITH EMERGENCY KIT AND TELECOMMAND  
CABLAGE HF AVEC UNITE DE SECOURS ET TELECOMMANDE  
VERDRAHTUNG FÜR HF MIT NOTLICHTEINSATZ UND TELECOMMAND  
ALIMENTAÇÃO ELÉCTRICA HF COM KIT EMERGÊNCIA E TELECOMANDO  
ELECTRIFICACIÓN HF CON KIT DE EMERGENCIA Y TELEMANDABLE

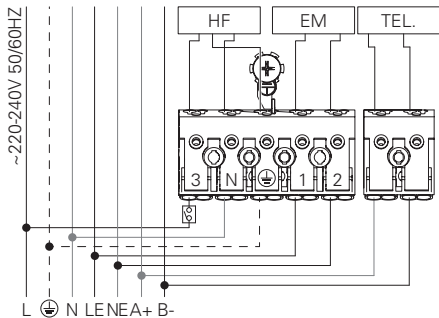

### 15.2 - REBA 65 /T LED Line DALI + EM + TEL.

POWER SUPPLY HF WITH EMERGENCY KIT AND TELECOMMAND  
CABLAGE HF AVEC UNITE DE SECOURS ET TELECOMMANDE  
VERDRAHTUNG FÜR HF MIT NOTLICHTEINSATZ UND TELEKOMMAND  
ALIMENTAÇÃO ELÉCTRICA HF COM KIT EMERGÊNCIA E TELECOMANDO  
ELECTRIFICACIÓN HF CON KIT DE EMERGENCIA Y TELEMANDABLE

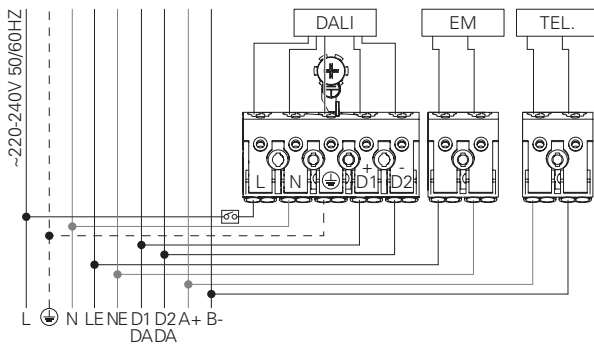

## 16 - REBA 65 /T LED Line

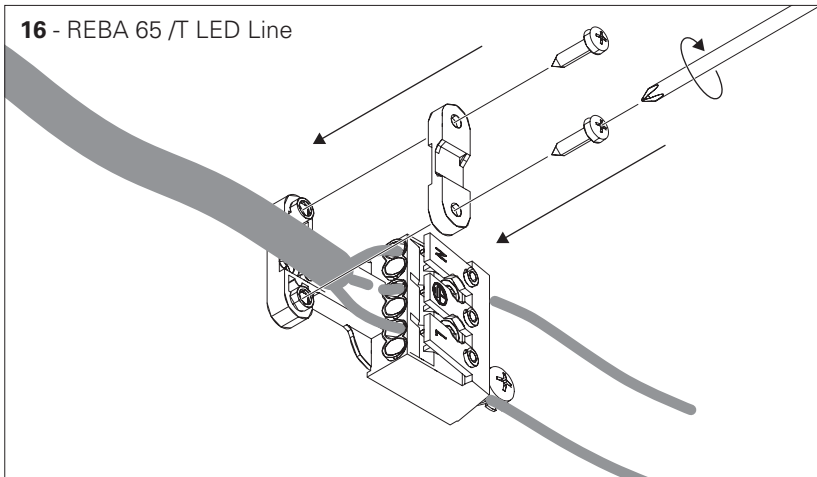



## 17 - REBA 65 /T LED Line

CONNECTORS OPTION  
OPTION CONNECTEURS  
OPTION STECKER  
OPÇÃO CONECTORES  
OPCIÓN CONECTORES

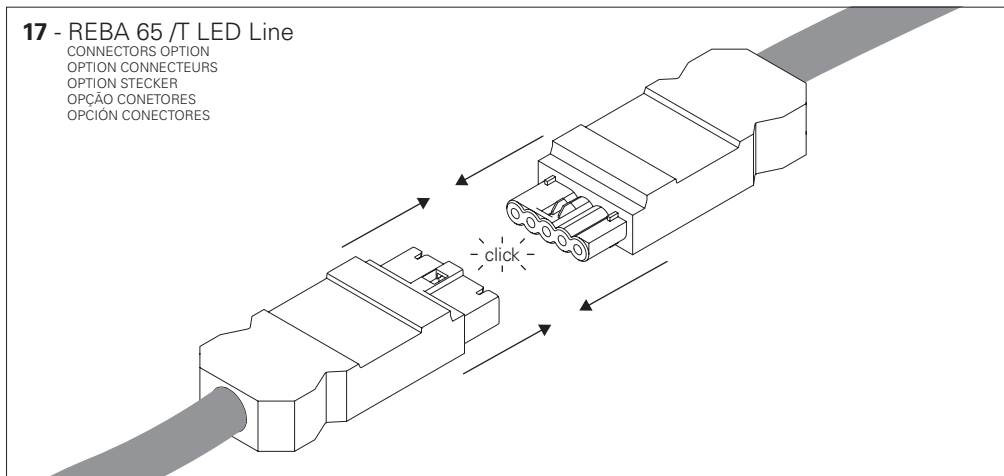

## 18 - REBA 65 /T LED Line

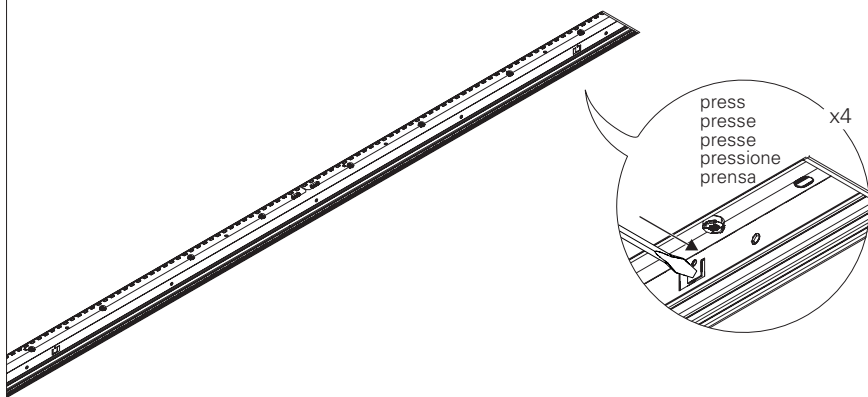

## 19 - REBA 65 /T LED Line

