

REBA LED Line

EN INSTALLATION INSTRUCTIONS
FR INSTRUCTIONS D'INTALLATION
DE INSTALLATIONSANLEITUNG
PT INSTRUÇÕES DE MONTAGEM
ES INSTRUCCIONES DE MONTAJE

REBA LED Line



EN WARNING: THE LIGHT SOURCE CONTAINED IN THE LUMINAIRE SHOULD BE REPLACED ONLY BY THE MANUFACTURER. DO NOT USE THIS EQUIPMENT IN AREAS CONTAINING CHEMICAL AGENTS: ACIDS, SOLVENTS, PAINTS, SILICONES, COATINGS, ETC.

FR AVERTISSEMENT: LA SOURCE DE LUMIÈRE CONTENUE DANS LA LUMINAIRE DOIT ÊTRE REMPLACÉE PAR LE FABRICANT. EN CAS D'ANOMALIE DÉTECTÉE, CONTACTEZ LE FABRICANT. NE PAS UTILISER L'ÉQUIPEMENT DANS LES ZONES QUI CONTIENNENT DES AGENTS CHIMIQUES: ACIDES, SOLVANTS, PEINTURES, SILICONES, VERNIS, ETC.

DE WARNUNG: DIE IN DER LEUCHTE ENTHALTEN LICHTQUELLE SOLLTE NUR VOM HERSTELLER ERSETZT WERDEN. VERWENDEN SIE DIESES GERÄT NICHT IN BEREICHEN MIT CHEMISCHEN MITTELN: SÄUREN, LÖSUNGSMITTEL, FARBEN, SILIKONE, BESCHICHTUNGEN ETC.

PT ATENÇÃO: A FONTE DE LUZ CONTIDA NA LUMINÁRIA DEVE SER SUBSTITUÍDA UNICAMENTE PELO FABRICANTE. QUALQUER ANOMALIA DETECTADA CONTACTAR O FABRICANTE. NÃO UTILIZAR O EQUIPAMENTO EM ZONAS QUE CONTENHAM AGENTES QUÍMICOS: ÁCIDOS, SOLVENTES, TINTAS, SILICONES, VERNIZES, ETC.

ES ATENCIÓN: LA FUENTE DE LUZ CONTENIDA EN LA LUMINARIA DEBE SER SUSTITUIDA ÚNICAMENTE POR EL FABRICANTE. CUALQUIER ANOMALÍA DETECTADA CONTACTAR CON EL FABRICANTE. NO UTILIZAR

LA LUMINARIA EN ZONAS QUE CONTENGAN AGENTES QUÍMICOS: ÁCIDOS, DISOLVENTES, PINTURAS, SILICONAS, BARNICES, ETC."



EN CAUTION, RISK OF ELECTRIC SHOCK.

FR ATTENTION, RISQUE DE CHOC ÉLECTRIQUE.

DE ACHTUNG, GEFAHR EINES STROMSCHLAGS.

PT CUIDADO, RISCO DE CHOQUE ELÉTRICO.

ES PRECAUCIÓN, RIESGO DE DESCARGA ELÉCTRICA.

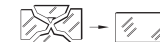

EN IF GLASS OR DIFFUSER BREAK OR CRACK, PLEASE REPLACE IT.

FR EN CAS DE CASSE OU FISSUREMENT, REMPLACEZ LE VERRE OU DIFFUSEUR.

DE BEI BRUCH ODER RISS, GLAS ODER DIFFUSER ERSETZEN.

PT EM CASO DE QUEBRA OU FISSURA, SUBSTITUIR O VIDRO OU DIFUSOR.

ES EN CASO DE ROTURA O FISURA, SUSTITUIR EL VIDRIO O DIFUSOR.



EN Read carefully the general terms and conditions of use and environmental concern with recycling attached. | **FR** Lire attentivement les conditions générales d'utilisations et de préoccupation environnementales avec les recyclage ci-joint. | **DE** Bitte lesen Sie de Allgemeinen Geschäftsbedingungen und Umweltbewusstsein über Recycling angeschlossen. | **PT** Ler atentamente as condições gerais de uso e preocupação ambiental com a reciclagem, em anexo. | **ES** Lea atentamente las condiciones generales de uso y preocupación ambiental con el reciclaje adjuntos.

EN We reserve the right to make changes on technical specifications, design and installation leaflet without prior notice. | **FR** Sous réserve de modifications au niveau de la conception, des spécifications techniques et de la notice. | **DE** Änderungen von Entwurf, technischen Daten und Bedienungsanleitungen bleiben vorbehalten. | **PT** O fabricante reserva-se no direito de realizar modificações no desenho, especificações técnicas e folheto, sem aviso prévio. | **ES** El fabricante se reserva el derecho de realizar modificaciones en el diseño, las especificaciones técnicas y el folleto.

EN SURFACE MOUNTED VERSION
FR VERSION SAILLIE
DE AUFBAUVERSION
PT VERSÃO SALIENTE
ES VERSIÓN DE SUPERFICIE

EN Accessories
FR Accessoires
DE Zubehör
PT Acessórios
ES Accesorios

BLINE (x1)

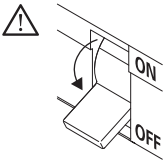

OPTIONS
OPTIONS
OPTIONEN
OPÇÕES
OPCIONES

START KIT OPTION
OPTION KIT DÉBUT DE LIGNE
OPTION START KIT
OPÇÃO START KIT
OPCIÓN START KIT

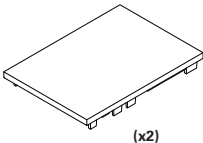

(x2)

CONNECTORS OPTION
OPTION CONNECTEURS
OPTION STECKER
OPÇÃO CONETORES
OPCIÓN CONECTORES

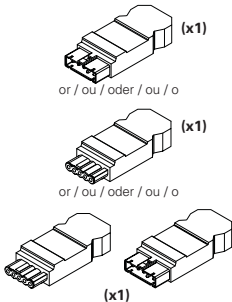

BODY CONNECTOR KIT OPTION
OPTION KIT UNION
OPTION VERBINDUNGS KIT
OPÇÃO KIT DE UNIÃO
OPCIÓN KIT DE UNIÓN

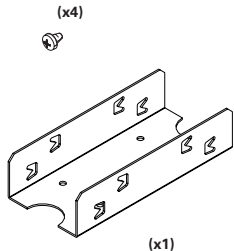

BLANK PARTS OPTION
OPTION MODULE VIDE
OPTION BLINDMODUL
OPÇÃO MÓDULOS CEGOS
OPCIÓN MÓDULOS CIEGOS

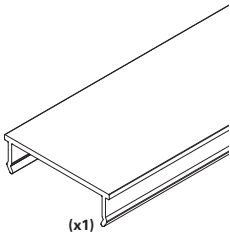

(x1)

LIGHT CORNERS OPTION
OPTION ANGLES LUMINEUX
OPTION LICHTECKE
OPÇÃO CANTOS ILUMINADOS
OPCIÓN ÁNGULOS ILUMINADOS

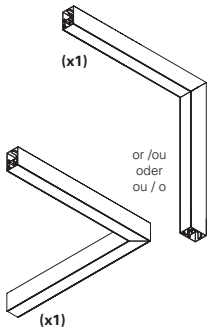

37 - REBA LED Line

CEILING ROSE - RECESSED
PATÈRE DE SUSPENSION - ENCASTRÉ
DECKENROSETTE - VERTIEFT
CAIXA DE ALIMENTAÇÃO - ENCASTRAR
BASE DE TETO - EMPOTRAR

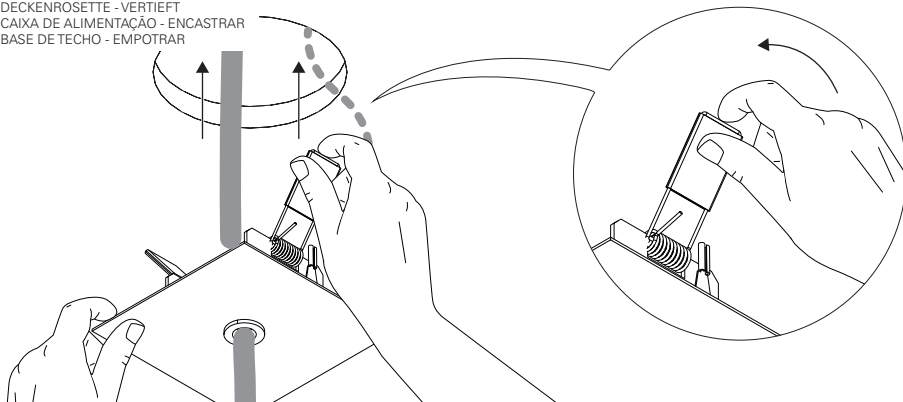

38 - REBA LED Line

CEILING ROSE - SURFACE MOUNTED
PATÈRE DE SUSPENSION - SAILLIE
DECKENROSETTE - AUFPUTZ
CAIXA DE ALIMENTAÇÃO - SALIENTE
BASE DE TETO - SUPERFICIE

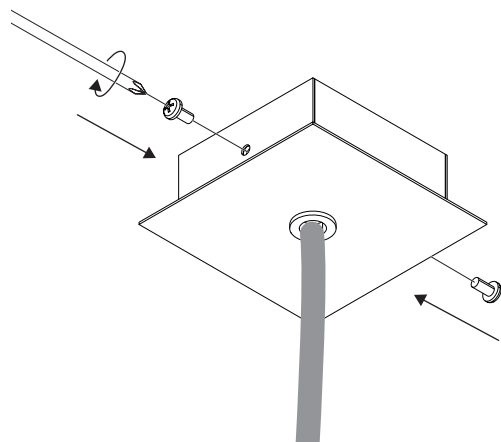

1 - REBA LED Line

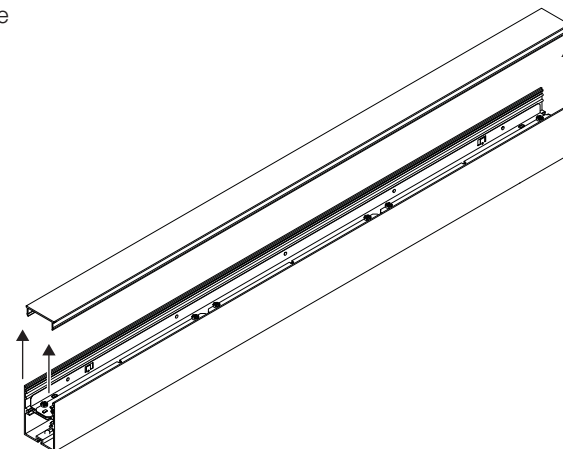

2 - REBA LED Line

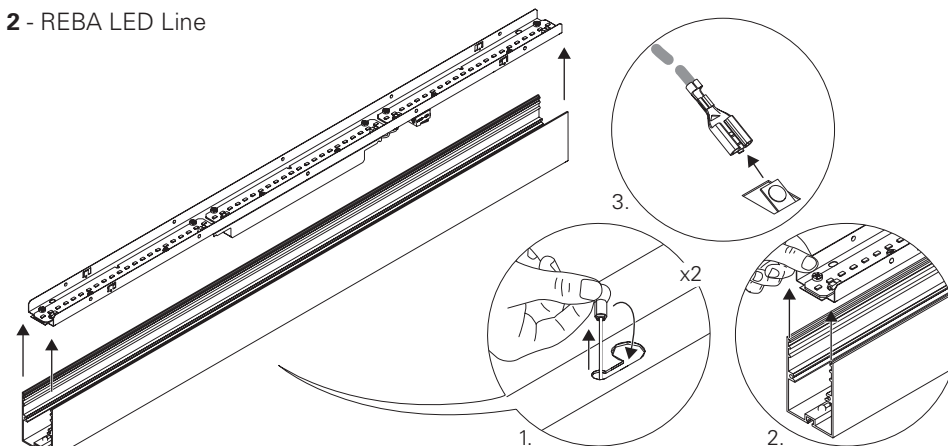

3 - REBA LED Line

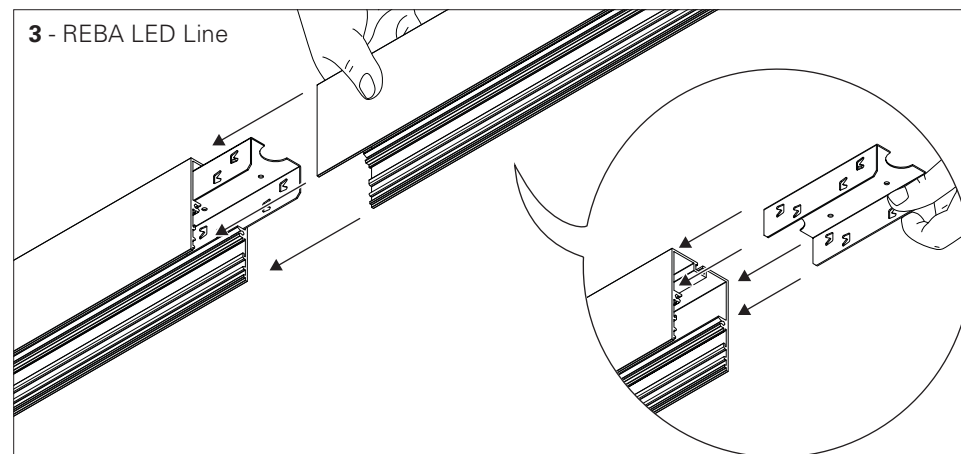

4 - REBA LED Line

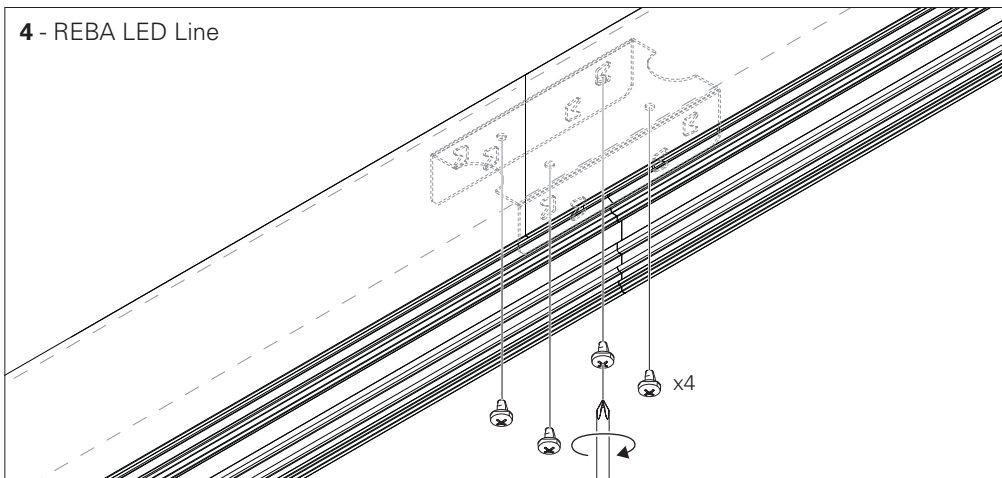

5 - REBA LED Line

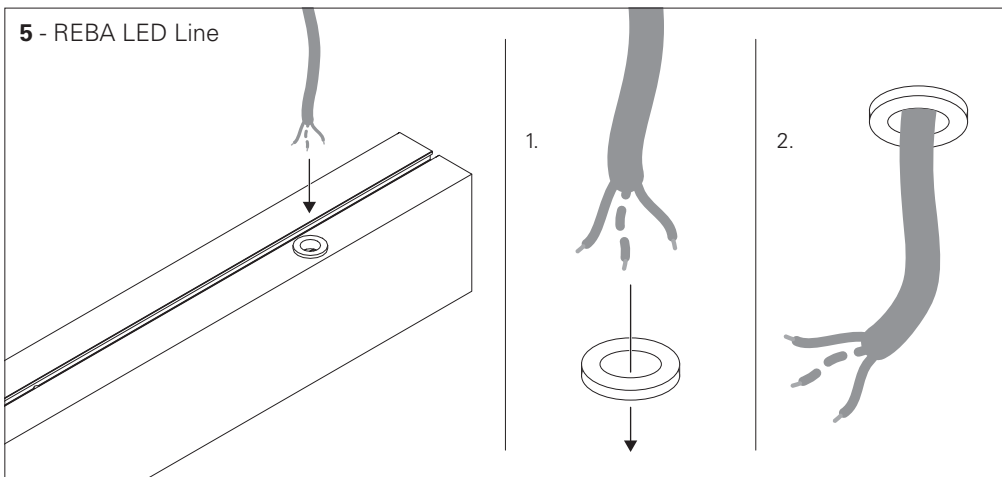

6 - REBA LED Line

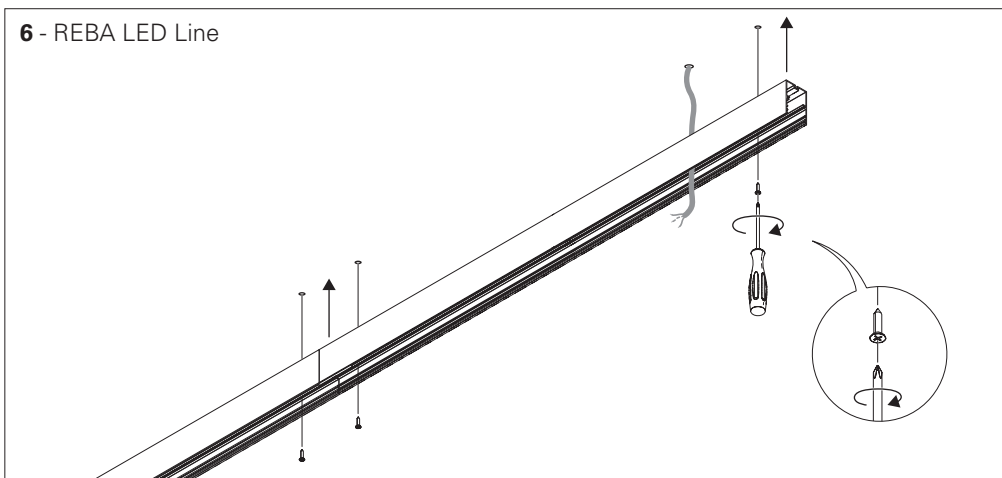

36 - REBA LED Line

CEILING ROSE - SURFACE MOUNTED
PATÈRE DE SUSPENSION - SAILLIE
DECKENROSETTE - AUFPUTZ
CAIXA DE ALIMENTAÇÃO - SALIENTE
BASE DE TECHO - SUPERFICIE

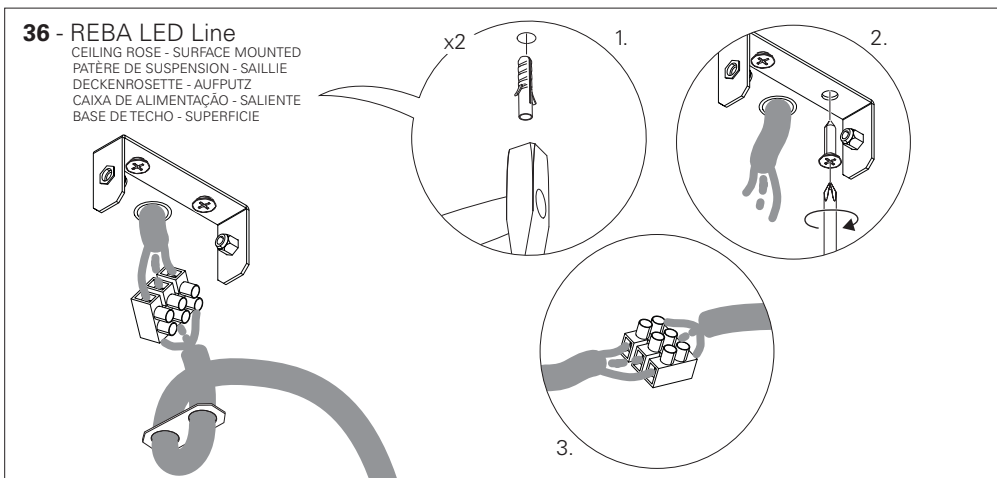

36 - REBA LED Line

CEILING ROSE - RECESSED
PATÈRE DE SUSPENSION - ENCASTRÉ
DECKENROSETTE - VERTIEFT
CAIXA DE ALIMENTAÇÃO - ENCASTRAR
BASE DE TECHO - EMPOTRAR

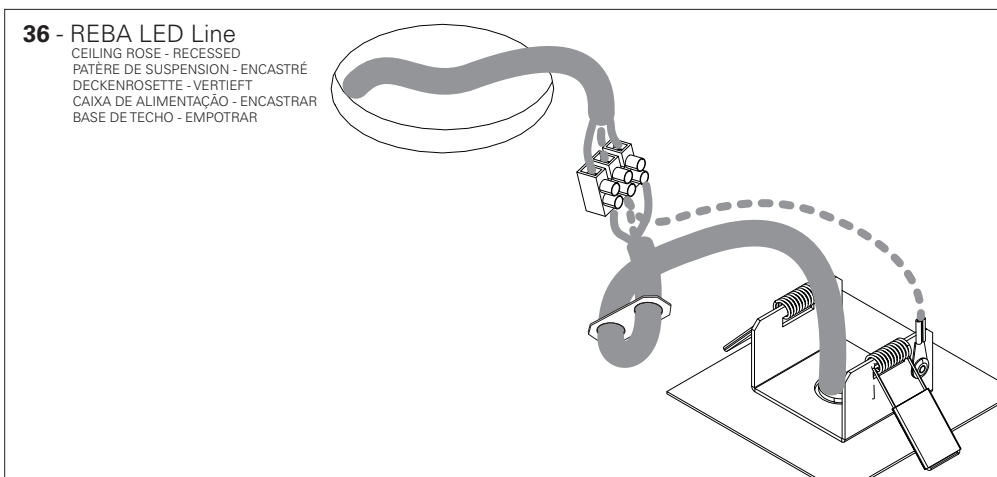

37 - REBA LED Line

CEILING ROSE - SURFACE MOUNTED
PATÈRE DE SUSPENSION - SAILLIE
DECKENROSETTE - AUFPUTZ
CAIXA DE ALIMENTAÇÃO - SALIENTE
BASE DE TECHO - SUPERFICIE

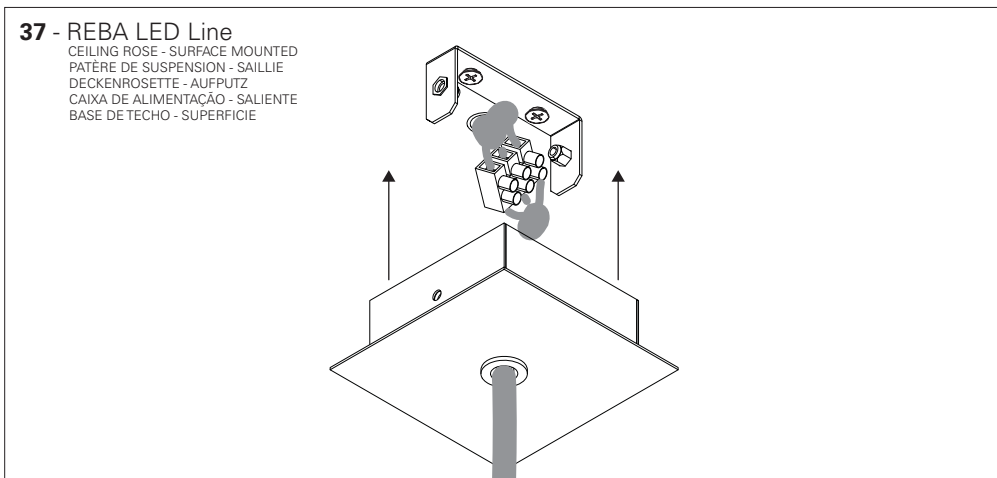

33 - REBA LED Line

CEILING ROSE - RECESSED
PATÈRE DE SUSPENSION - ENCASTRÉ
DECKENROSETTE - VERTIEFT
CAIXA DE ALIMENTAÇÃO - ENCASTRAR
BASE DE TECHO - EMPOTRAR

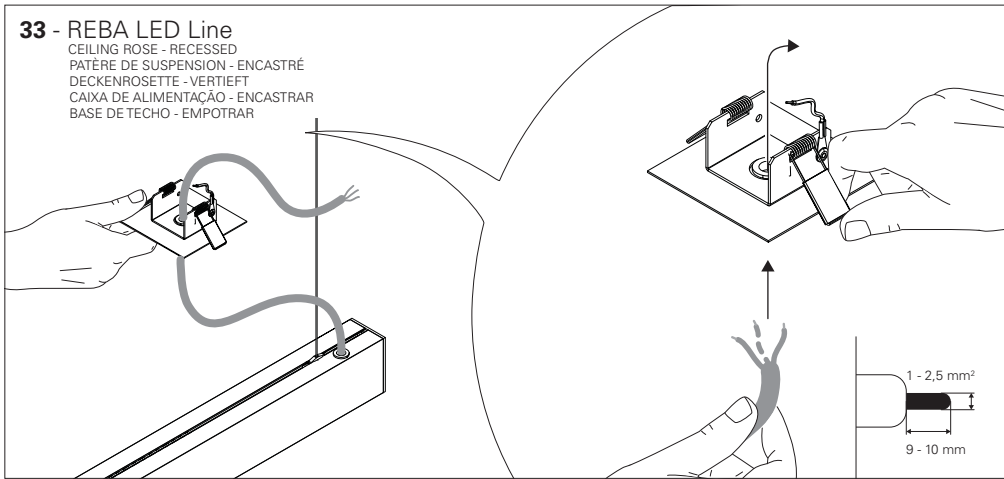

34 - REBA LED Line

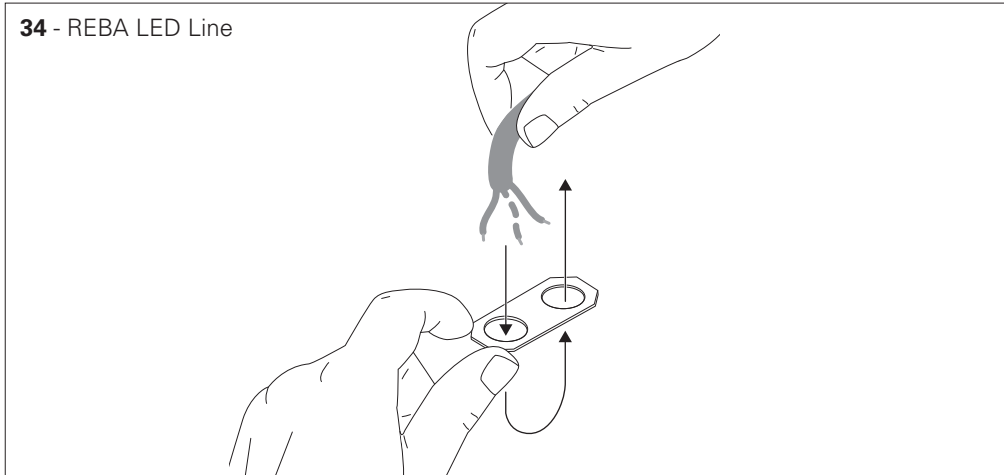

35 - REBA LED Line HF

STANDARD POWER SUPPLY
CÂBLAGE STRANDARD
STANDARD VERDRAHTUNG
ALIMENTAÇÃO ELÉCTRICA STANDARD
ELECTRIFICACIÓN ESTÁNDAR

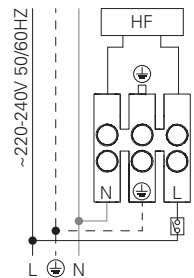

DALI

DIMMABLE POWER SUPPLY
CÂBLAGE AVEC GRADATION
DIMMBARE VERDRAHTUNG
ALIMENTAÇÃO ELÉCTRICA COM REGULAÇÃO
ELECTRIFICACIÓN CON REGULACIÓN

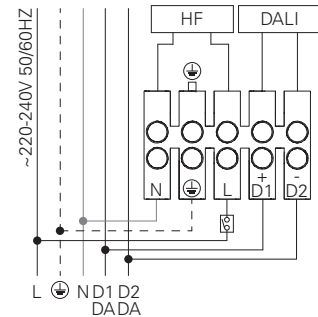

BLUE - N (NEUTRAL)
GREEN AND YELLOW - ⊕ (EARTH)
BROWN - L (LIVE)
GREY - D1+
BLACK - D2-

BLEU - N (NEUTRE)
VERT ET JAUNE - ⊕ (TERRE)
MARRON - L (PHASE)
GRIS - D1+
NOIR - D2-

BLAU - N (NEUTRAL)
GRÜN UND GELB - ⊕ (ERDE)
BRAUN - L (PHASE)
GRAU - D1+
SCHWARZ - D2-

AZUL - N (NEUTRO)
VERDE E AMARELO - ⊕ (TERRA)
CASTANHO - L (FASE)
CINZA - D1+
PRETO - D2-

AZUL - N (NEUTRAL)
VERDE Y AMARILLO - ⊕ (TIERRA)
MARRÓN - L (FASE)
GRIS - D1+
NEGRO - D2-

7 - REBA LED Line

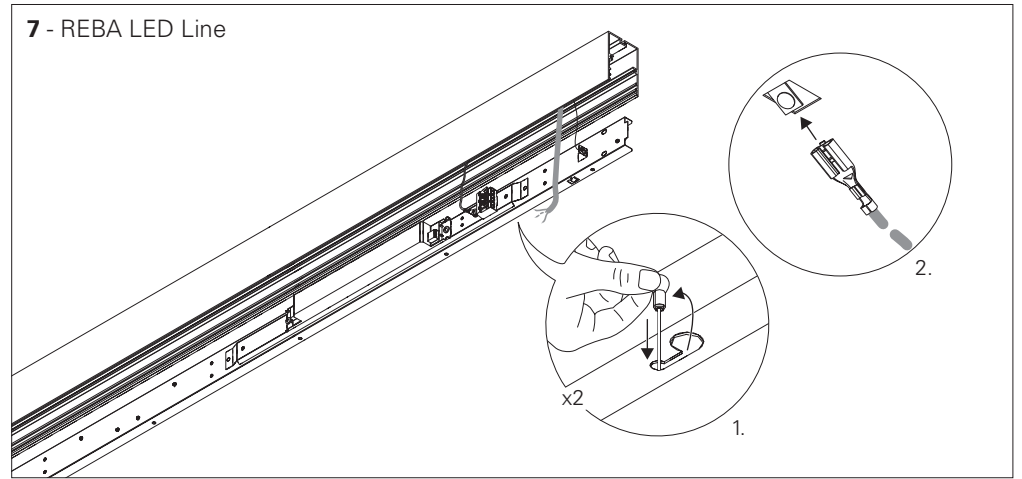

8 - REBA LED Line

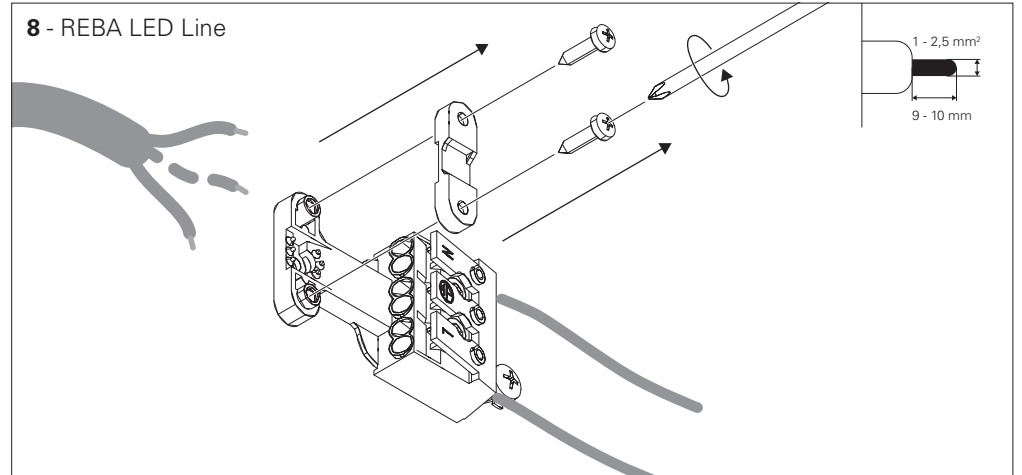

9 - REBA LED Line HF

STANDARD POWER SUPPLY
CÂBLAGE STRANDARD
STANDARD VERDRAHTUNG
ALIMENTAÇÃO ELÉCTRICA STANDARD
ELECTRIFICACIÓN ESTÁNDAR

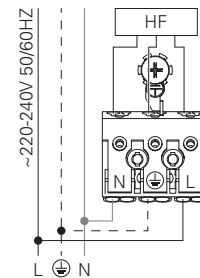

DALI

DIMMABLE POWER SUPPLY
CÂBLAGE AVEC GRADATION
DIMMBARE VERDRAHTUNG
ALIMENTAÇÃO ELÉCTRICA COM REGULAÇÃO
ELECTRIFICACIÓN CON REGULACIÓN

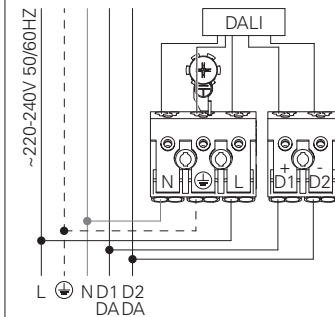

BLUE - N (NEUTRAL)
GREEN AND YELLOW - ⊕ (EARTH)
BROWN - L (LIVE)
GREY - D1+
BLACK - D2-

BLEU - N (NEUTRE)
VERT ET JAUNE - ⊕ (TERRE)
MARRON - L (PHASE)
GRIS - D1+
NOIR - D2-

BLAU - N (NEUTRAL)
GRÜN UND GELB - ⊕ (ERDE)
BRAUN - L (PHASE)
GRAU - D1+
SCHWARZ - D2-

AZUL - N (NEUTRO)
VERDE E AMARELO - ⊕ (TERRA)
CASTANHO - L (FASE)
CINZA - D1+
PRETO - D2-

AZUL - N (NEUTRAL)
VERDE Y AMARILLO - ⊕ (TIERRA)
MARRÓN - L (FASE)
GRIS - D1+
NEGRO - D2-

9.1 - REBA LED Line HF + EM + TEL.

POWER SUPPLY HF WITH EMERGENCY KIT AND TELECOMMAND
CABLAGE HF AVEC UNITE DE SECOURS ET TELECOMMANDE
VERDRAHTUNG FÜR HF MIT NOTLICHTEINSATZ UND TELEKOMMAND
ALIMENTAÇÃO ELÉCTRICA HF COM KIT EMERGÊNCIA E TELECOMANDO
ELECTRIFICACIÓN HF CON KIT DE EMERGENCIA Y TELEMANDABLE

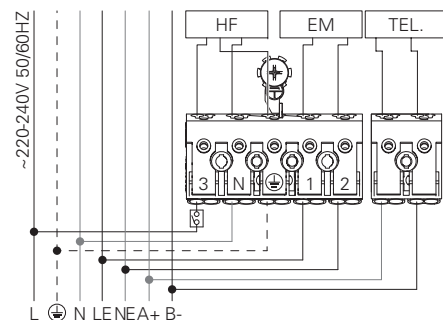

BLUE - N (NEUTRAL)
GREEN AND YELLOW - (EARTH)
BROWN - L (LIVE)
GREY - LE (EMERGENCY LIVE)
BLACK - NE (EMERGENCY NEUTRAL)
RED - A+
BLACK - B-

BLEU - N (NEUTRE)
VERT ET JAUNE - (TERRE)
MARRON - L (PHASE)
GRIS - LE (UNI. SECOURS PHASE)
NOIR - NE (UNI. SECOURS NEUTRE)
ROUGE - A+
NOIR - B-

BLAU - N (NEUTRAL)
GRÜN UND GELB - (ERDE)
BRAUN - L (PHASE)
GRAU - LE (NOTLICHT PHASE)
SCHWARZ - NE (NOTLICHT NEUTRAL)
ROT - A+
SCHWARZ - B-

AZUL - N (NEUTRO)
VERDE E AMARELO - (TERRA)
CASTANHO - L (FASE)
CINZA - LE (EMERGÊNCIA FASE)
PRETO - NE (EMERGÊNCIA NEUTRO)
VERMELHO - A+
PRETO - B-

AZUL - N (NEUTRAL)
VERDE Y AMARILLO - (TIERRA)
MARRÓN - L (FASE)
GRIS - LE (EMERGENCIA FASE)
NEGRO - NE (EMERGENCIA NEUTRAL)
ROJO - A+
NEGRO - B-

30 - REBA LED Line

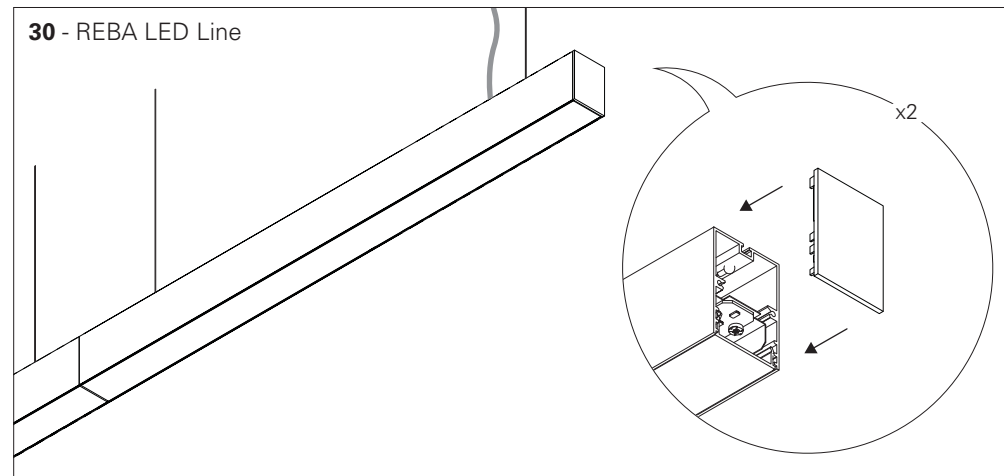

9.2 - REBA LED Line DALI + EM + TEL.

POWER SUPPLY HF WITH EMERGENCY KIT AND TELECOMMANDE
CABLAGE HF AVEC UNITE DE SECOURS ET TELECOMMANDE
VERDRAHTUNG FÜR HF MIT NOTLICHTEINSATZ UND TELEKOMMAND
ALIMENTAÇÃO ELÉCTRICA HF COM KIT EMERGÊNCIA E TELECOMANDO
ELECTRIFICACIÓN HF CON KIT DE EMERGENCIA Y TELEMANDABLE

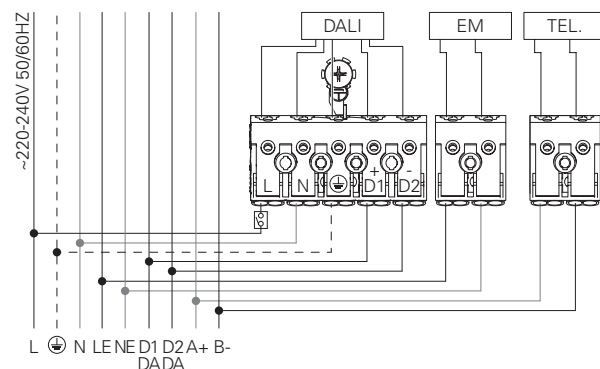

BLUE - N (NEUTRAL)
GREEN AND YELLOW - (EARTH)
BROWN - L (LIVE)
GREY - D1+
BLACK - D2-
BLUE - NE (EMERGENCY NEUTRAL)
BROWN - LE (EMERGENCY LIVE)
RED - A+
BLACK - B-

BLEU - N (NEUTRE)
VERT ET JAUNE - (TERRE)
MARRON - L (PHASE)
GRIS - D1+
NOIR - D2-
BLEU - NE (UNI. SECOURS NEUTRE)
MARRON - LE (UNI. SECOURS PHASE)
ROUGE - A+
NOIR - B-

BLAU - N (NEUTRAL)
GRÜN UND GELB - (ERDE)
BRAUN - L (PHASE)
GRAU - D1+
SCHWARZ - D2-
BLAU - NE (NOTLICHT NEUTRAL)
BRAUN - LE (NOTLICHT PHASE)
ROT - A+
SCHWARZ - B-

AZUL - N (NEUTRO)
VERDE E AMARELO - (TERRA)
CASTANHO - L (FASE)
CINZA - D1+
PRETO - D2-
AZUL - NE (EMERGÊNCIA NEUTRO)
CASTANHO - LE (EMERGÊNCIA FASE)
VERMELHO - A+
PRETO - B-

AZUL - N (NEUTRAL)
VERDE Y AMARILLO - (TIERRA)
MARRÓN - L (FASE)
GRIS - D1+
NEGRO - D2-
AZUL - NE (EMERGENCIA NEUTRAL)
MARRÓN - LE (EMERGENCIA FASE)
ROJO - A+
NEGRO - B-

31 - REBA LED Line

CEILING ROSE - SURFACE MOUNTED
PATÈRE DE SUSPENSION - SAILLIE
DECKENROSETTE - AUFPUTZ
CAIXA DE ALIMENTAÇÃO - SALIENTE
BASE DE TECTO - SUPERFICIE

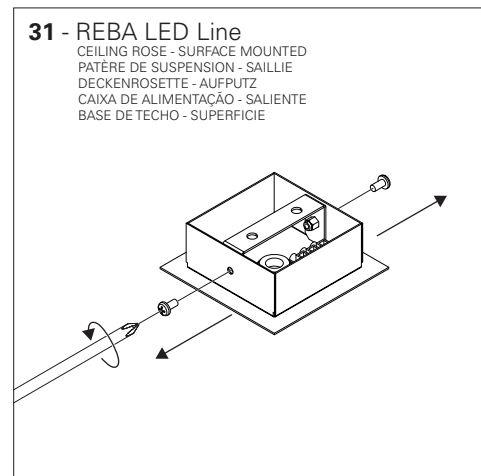

32 - REBA LED Line

CEILING ROSE - SURFACE MOUNTED
PATÈRE DE SUSPENSION - SAILLIE
DECKENROSETTE - AUFPUTZ
CAIXA DE ALIMENTAÇÃO - SALIENTE
BASE DE TECTO - SUPERFICIE

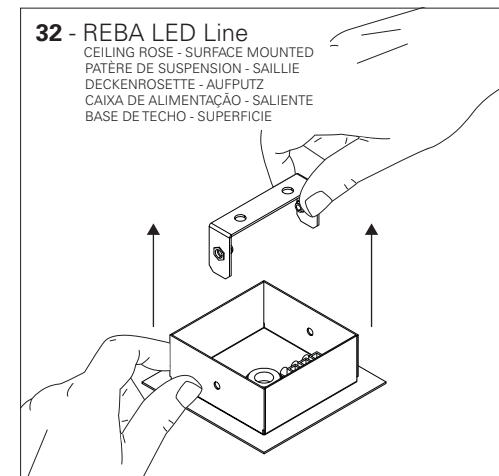

33 - REBA LED Line

CEILING ROSE - SURFACE MOUNTED
PATÈRE DE SUSPENSION - SAILLIE
DECKENROSETTE - AUFPUTZ
CAIXA DE ALIMENTAÇÃO - SALIENTE
BASE DE TECTO - SUPERFICIE

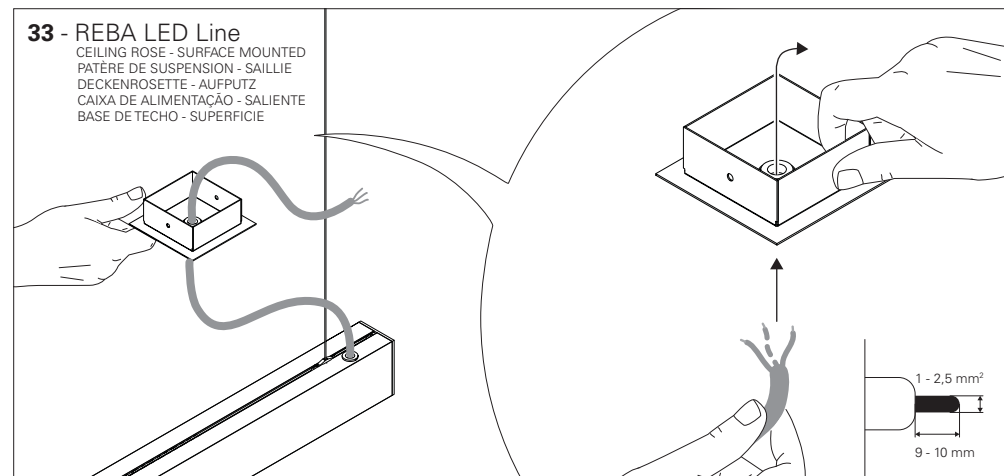

27 - REBA LED Line

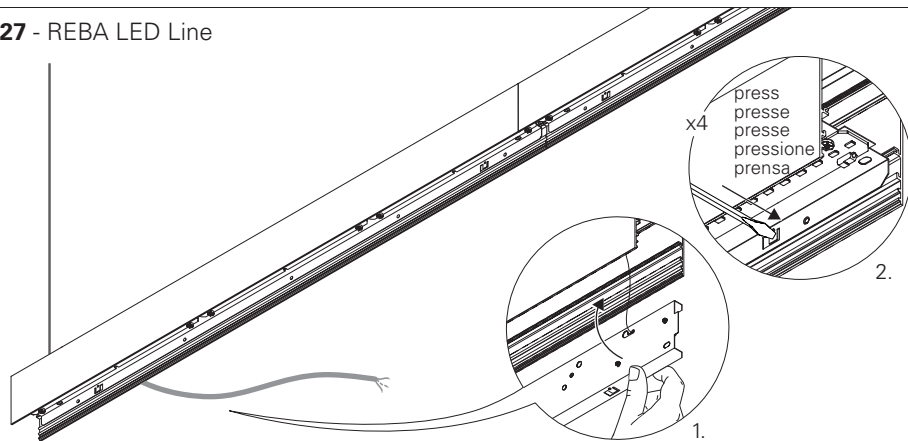

28 - REBA LED Line

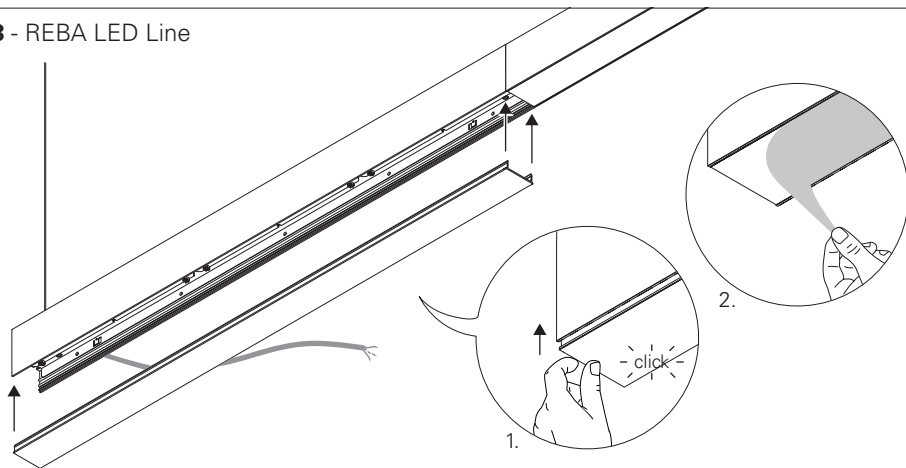

29 - REBA LED Line

BLANK PARTS OPTION
OPTION MODULE VIDE
OPTION BLINDMODUL
OPÇÃO MÓDULOS CEGOS
OPCIÓN MÓDULOS CIEGOS

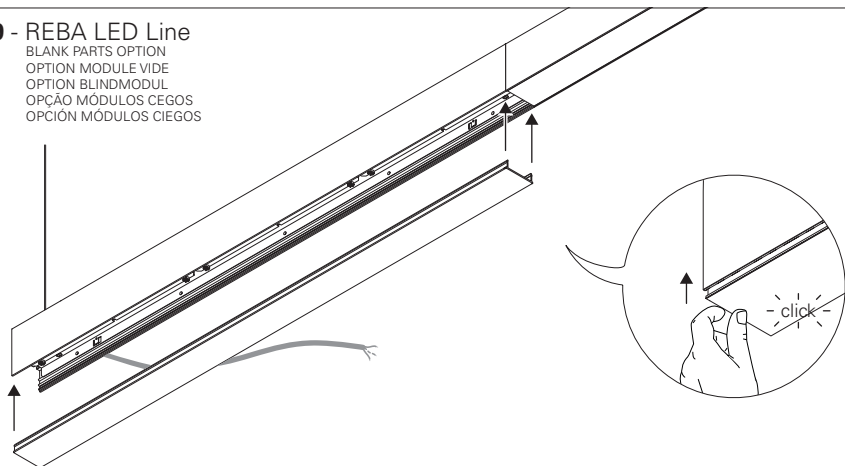

10 - REBA LED Line

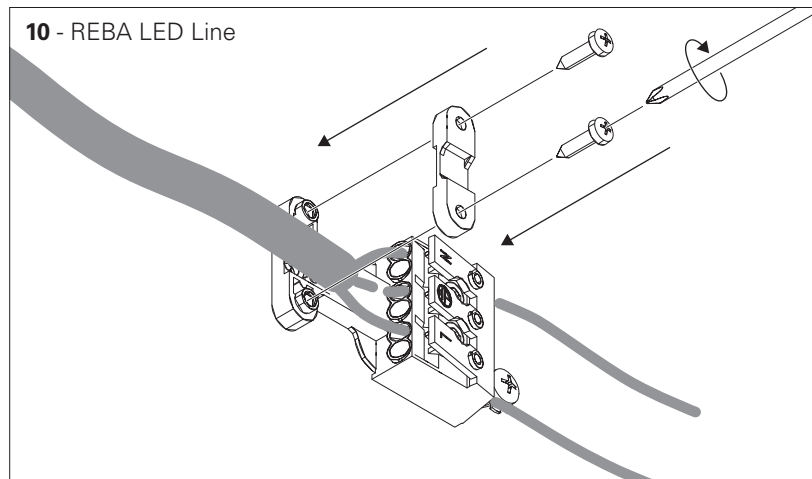

11 - REBA LED Line

CONNECTORS OPTION
OPTION CONNECTEURS
OPTION STECKER
OPÇÃO CONETORES
OPCIÓN CONECTORES

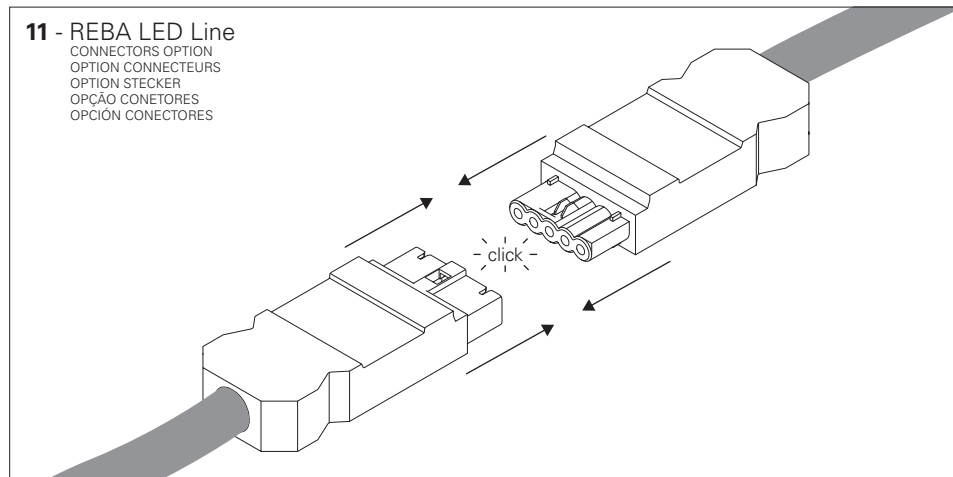

12 - REBA LED Line

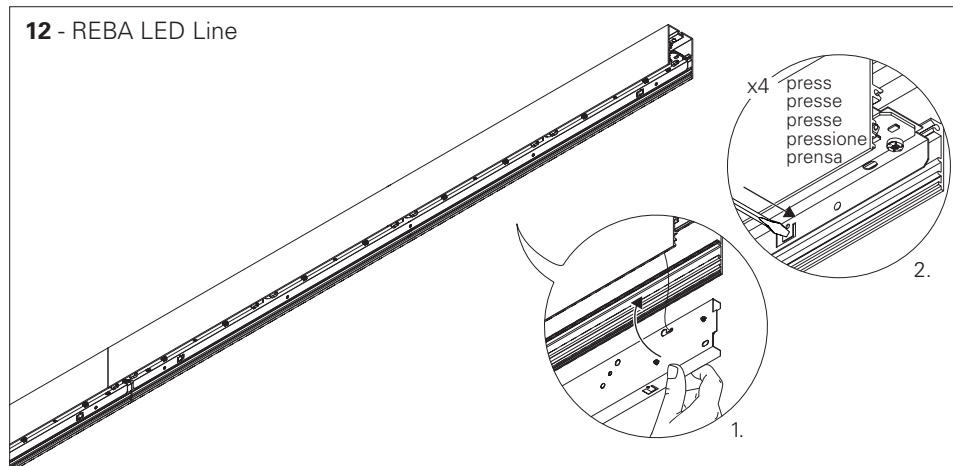

13 - REBA LED Line

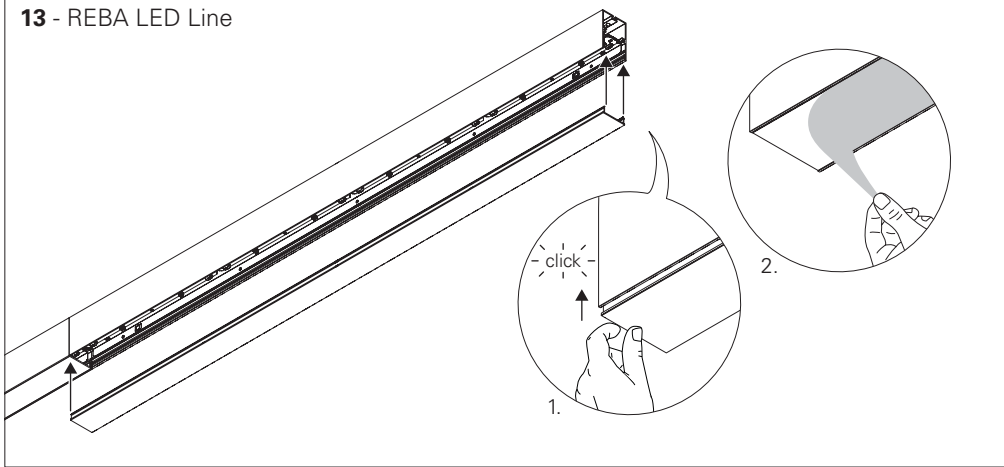

14 - REBA LED Line

BLANK PARTS OPTION
OPTION MODULE VIDE
OPTION BLINDMODUL
OPÇÃO MÓDULOS CEGOS
OPCIÓN MÓDULOS CIEGOS

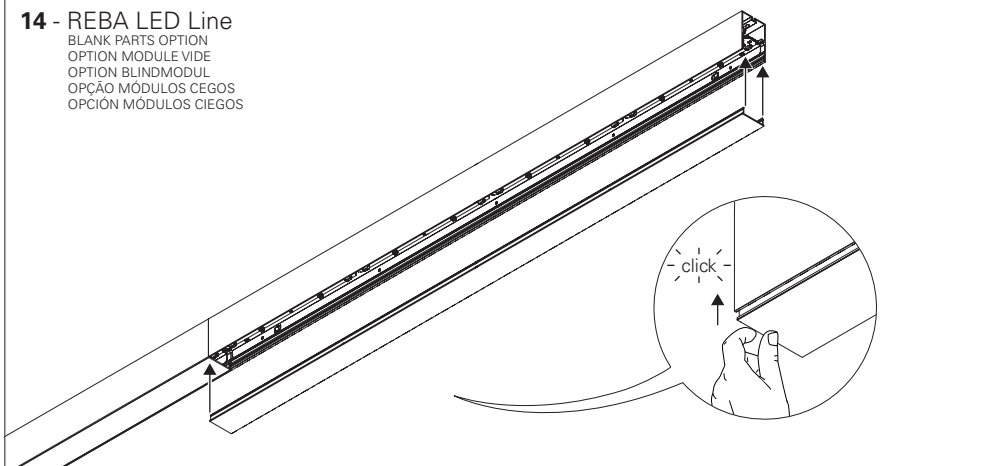

15 - REBA LED Line

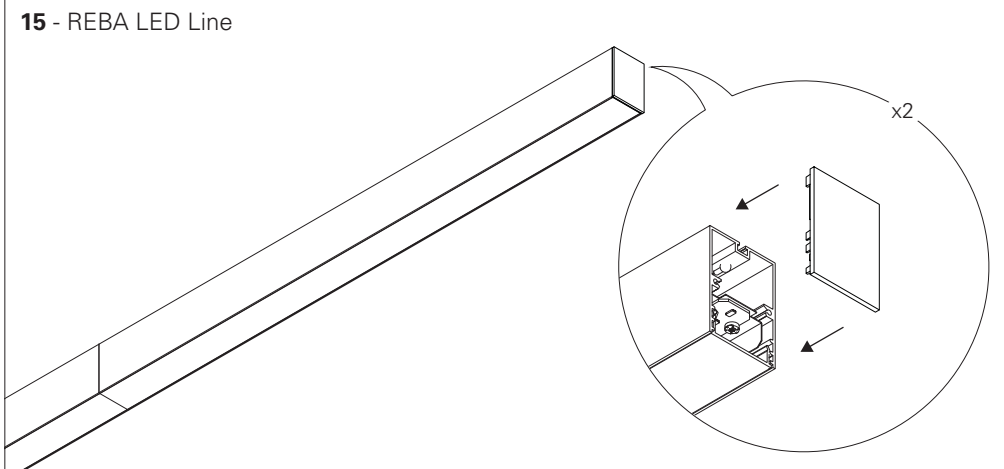

24 - REBA LED Line HF

STANDARD POWER SUPPLY
CÂBLAGE STRANDARD
STANDARD VERDRAHTUNG
ALIMENTAÇÃO ELÉCTRICA STANDARD
ELECTRIFICACIÓN ESTÁNDAR

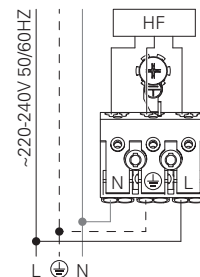

DALI

DIMMABLE POWER SUPPLY
CÂBLAGE AVEC GRADATION
DIMMBARE VERDRAHTUNG
ALIMENTAÇÃO ELÉCTRICA COM REGULAÇÃO
ELECTRIFICACIÓN CON REGULACIÓN

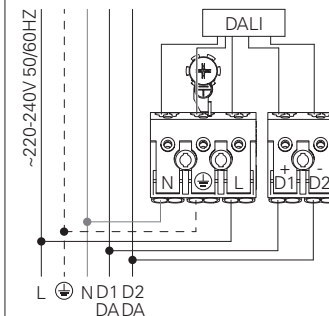

BLUE - N (NEUTRAL)
GREEN AND YELLOW - (EARTH)
BROWN - L (LIVE)
WHITE - D1+
BLACK - D2-

BLEU - N (NEUTRE)
VERT ET JAUNE - (TERRE)
MARRON - L (PHASE)
BLANC - D1+
NOIR - D2-

BLAU - N (NEUTRAL)
GRÜN UND GELB - (ERDE)
BRAUN - L (PHASE)
WEISS - D1+
SCHWARZ - D2-

AZUL - N (NEUTRO)
VERDE E AMARELO - (TERRA)
CASTANHO - L (FASE)
BRANCO - D1+
PRETO - D2-

AZUL - N (NEUTRAL)
VERDE Y AMARILLO - (TIERRA)
MARRÓN - L (FASE)
BLANCO - D1+
NEGRO - D2-

25 - REBA LED Line

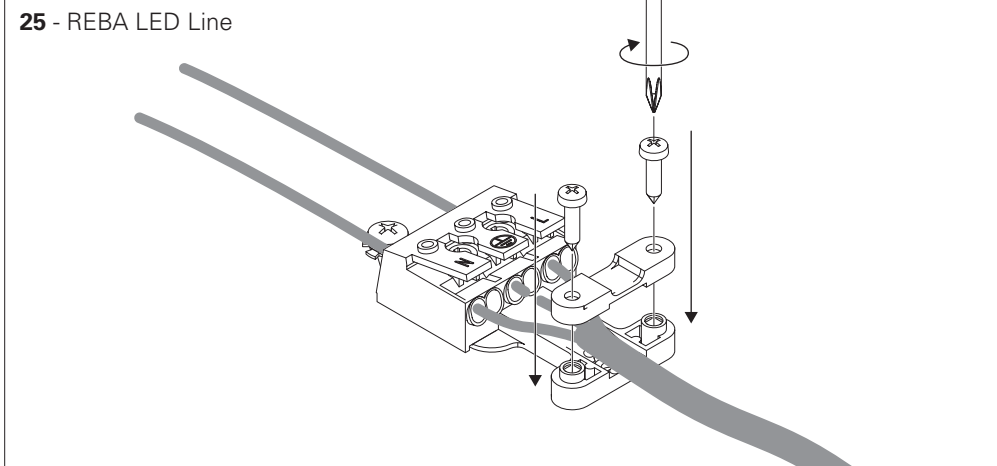

26 - REBA LED Line

CONNECTORS OPTION
OPTION CONNECTEURS
OPTION STECKER
OPÇÃO CONECTORES
OPCIÓN CONECTORES

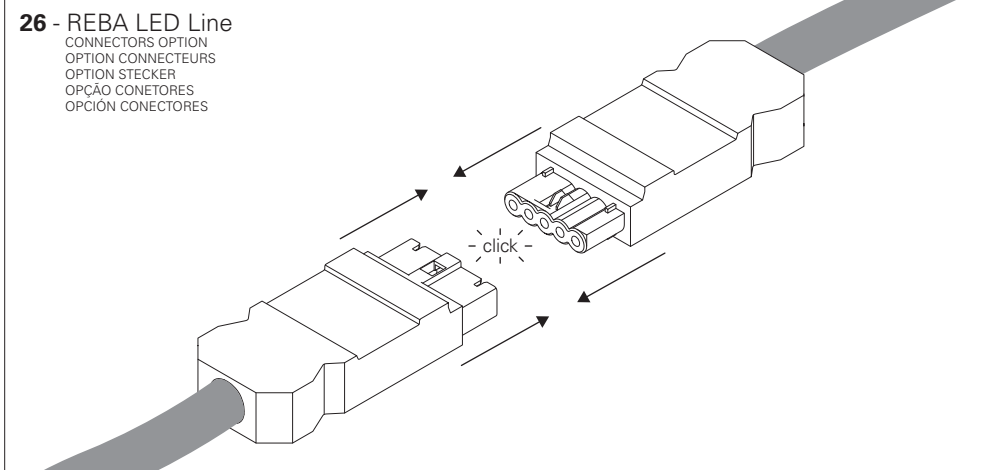

21 - REBA LED Line

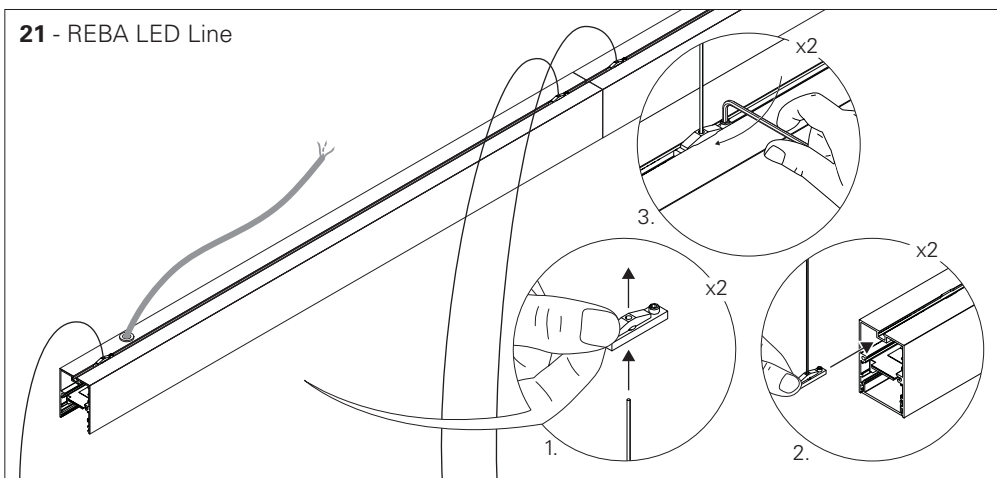

22 - REBA LED Line

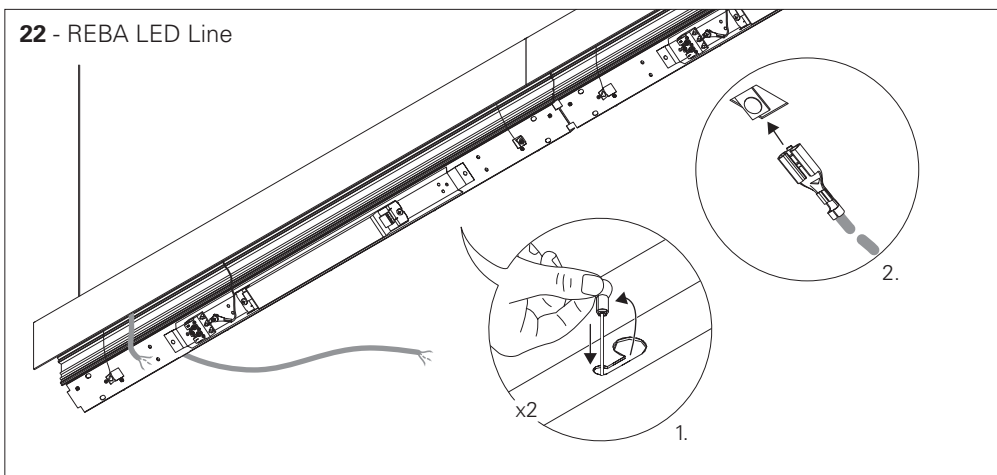

23 - REBA LED Line

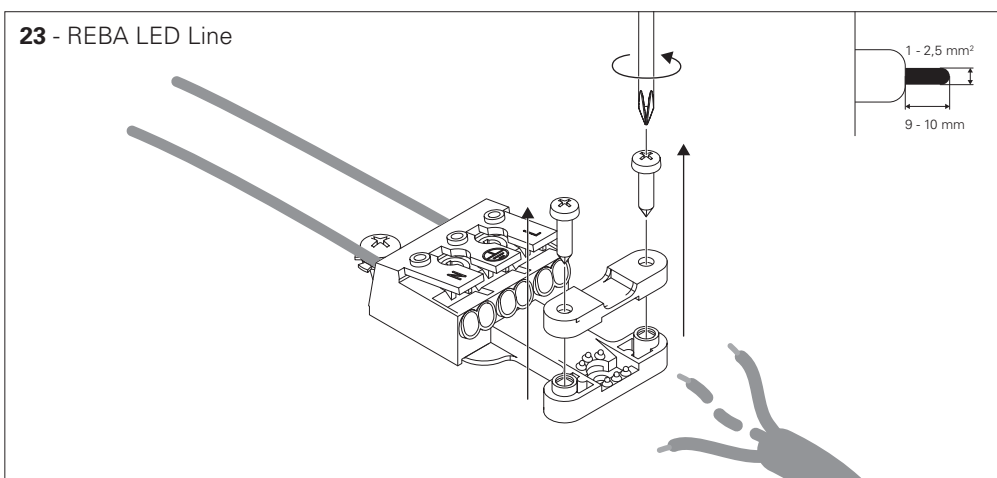

REBA LED Line



EN SUSPENDED VERSION
FR VERSION SUSPENDU
DE PENDELVERSION
PT VERSÃO SUSPensa
ES VERSIÓN SUSPENDIDO

EN Accessories
FR Accessoires
DE Zubehör
PT Acessórios
ES Accesorios

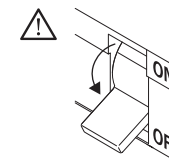
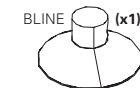

OPTIONS
 OPTIONS
 OPTIONEN
 OPÇÕES
 OPCIONES

START KIT OPTION
 OPTION KIT DÉBUT DE LIGNE
 OPTION START KIT
 OPÇÃO START KIT
 OPCION START KIT

CONNECTORS OPTION
 OPTION CONNECTEURS
 OPTION STECKER
 OPÇÃO CONETORES
 OPCION CONECTORES

BODY CONNECTOR KIT OPTION
 OPTION KIT UNION
 OPTION VERBINDUNGS KIT
 OPÇÃO KIT DE UNIÃO
 OPCION KIT DE UNIÓN

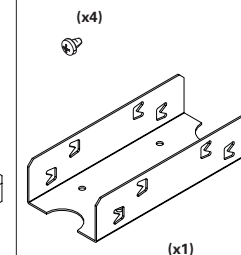
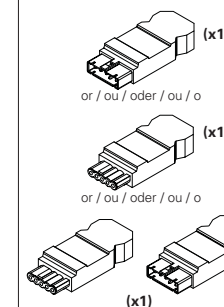
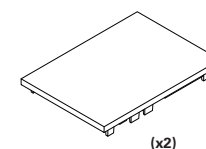

SUSPENSION
 SUSPENSION
 AUFHÄNGUNG
 SUSPENSÃO
 SUSPENSIÓN

CEILING ROSE
 PATÈRE DE SUSPENSION
 DECKENBALDACHIN
 CAIXA DE ALIMENTAÇÃO
 BASE DETECHO

CURRENT SUPPLY CABLE
 CÂBLE D'ALIMENTATION
 EINSPEISUNGSKABEL
 CABO DE ALIMENTAÇÃO
 CABLE DE ALIMENTACIÓN

Recessed or surface mounted
 Encastré ou en saillie
 Vertieft oder hervorstehen
 Encastrar ou saliente
 Empotrar o superficie

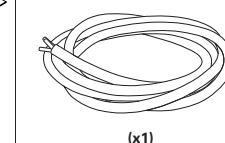
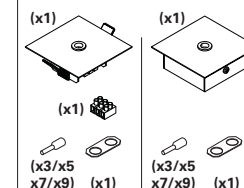
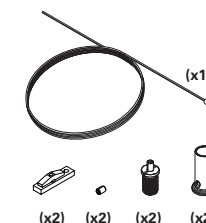

OPTIONS
 OPTIONS
 OPTIONEN
 OPÇÕES
 OPCIONS

BLANK PARTS OPTION
 OPTION MODULE VIDE
 OPTION BLINDMODUL
 OPÇÃO MÓDULOS CEGOS
 OPCION MÓDULOS CIEGOS

LIGHT CORNERS OPTION
 OPTION ANGLES LUMINEUX
 OPTION LICHTECKE
 OPÇÃO CANTOS ILUMINADOS
 OPCION ÁNGULOS ILUMINADOS

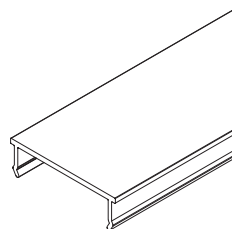

(x1) 1500/3000mm

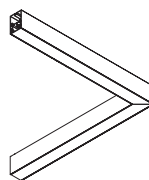

(x1)

18 - REBA LED Line

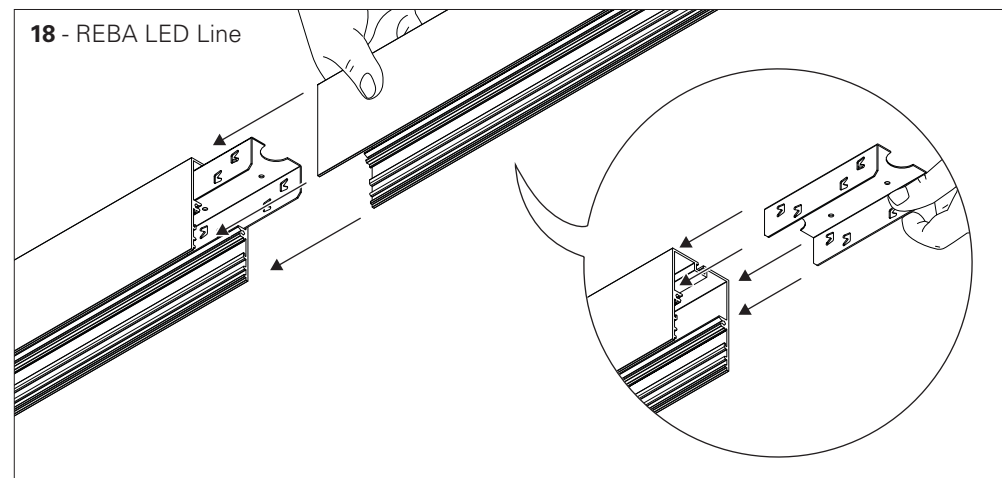

16 - REBA LED Line

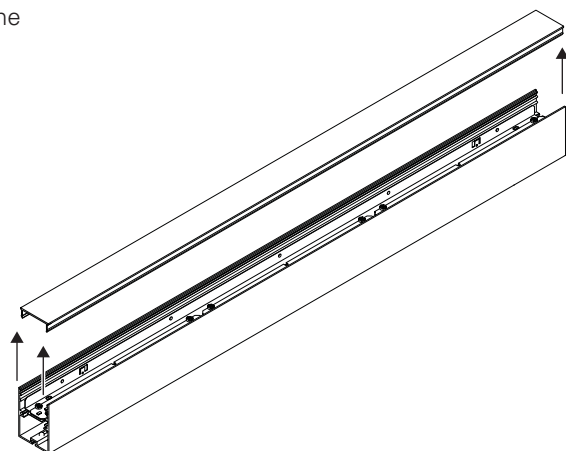

19 - REBA LED Line

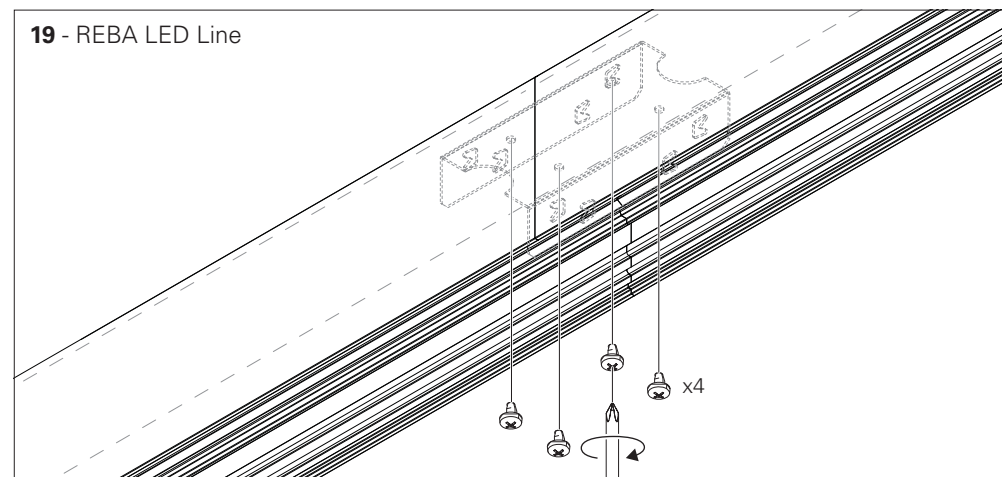

17 - REBA LED Line

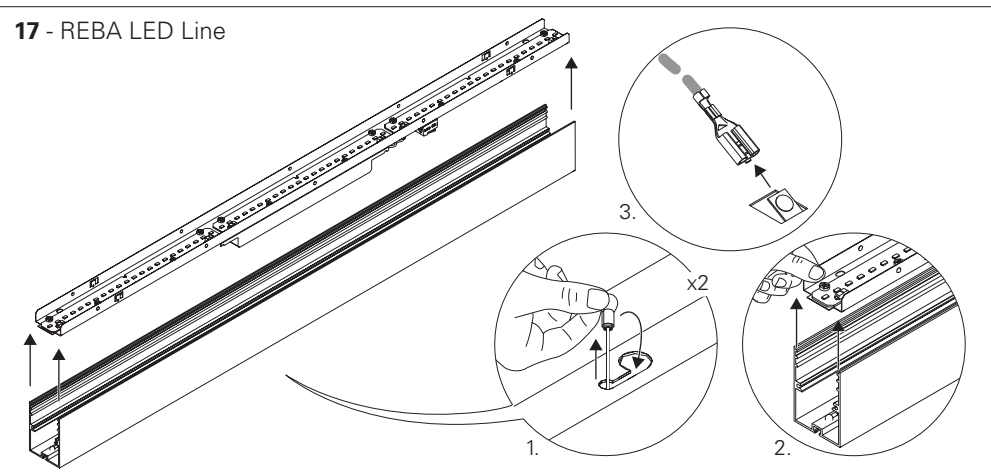

20 - REBA LED Line

