



Norms: EN 60598-1, EN 60598-2-1



PRODUCT DESCRIPTION

Areas of Application:	Commercial and Business areas, Public buildings, Housing, Offices, Hotel and Restaurant services, Art and Culture spaces.
Light Source:	LED 4000K, CRI >80, 50.000h life.
Optical System:	Diffuser: Opal polycarbonate.
Control Gear:	LED driver, 220-240VAC-50/60Hz.
Materials:	Body: Extruded aluminium.
Surface Finish:	Powder coated.

DOZ - Opal polycarbonate diffuser

LED	W	Lm	Lm/W	η(%)	AxB (mm)	Kg	HF	DSI	DALI
	22	2650	80	75	Ø400x85	3	90124.L400.E	90124.L400.G	90124.L400.H
	34	3750	78	77	Ø400x85	3	90124.L401.E	90124.L401.G	90124.L401.H
	59	8238	81	71	Ø650x85	7,5	90124.L650.E	90124.L650.G	90124.L650.H
	75	11830	104	75	Ø950x85	14	90124.L950.E	90124.L950.G	90124.L950.H

COLOUR / FINISH

Code	Description
W	Matt white (RAL 9016)
B	Black (RAL 9005)
G	Grey (RAL 9006)
U	Blue (RAL 5002)
K	Red (RAL 3020)
V	Green (RAL 6018)
T	Yellow (RAL 1021)

OPTIONS

Code	Description
3000	Colour temperature 3000K.
910700	Suspension Type "I" (x3) □ • Suspension kit for Ø400, Ø650 and Ø950mm versions.
940400	1,5 m transparent current cable 3x0,75 mm2.
940500	1,5 m transparent current cable 5x0,75 mm2.
9705	Ceiling rose (x3) □ • Ceiling rose for Ø400, Ø650 and Ø950mm versions.

DIMENSIONS

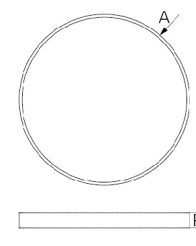

PHOTOMETRY

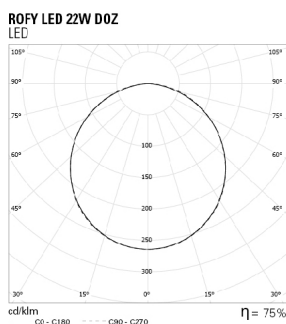

TO SPECIFY:

Surface or suspended LED luminaire with three sizes available (Ø400/Ø650/Ø950mm) and integral 3750/8238/11830 lumen light engine with round opal polycarbonate diffuser. LED driver included. Optional 3000K, white, grey, black, red, yellow, green or blue finish available - as Roxo Lighting ROFY LED.

Example code for order: 90124.L400.H (DALI) + W (COLOUR/FINISH) + 3000 + 910700 + 940500 + 9705 (OPTIONS)

We reserve the right to make technical changes without prior notice.