



LED



Norms: EN 60598-1, EN 60598-2-1



IP 65

IK 10 (170 Joules)

850°C

230V/50Hz

PRODUCT DESCRIPTION

Areas of Application: Police stations, detention centres, public spaces, psychiatric hospitals, schools.

Mounting: Ceiling surface.

Light Distribution: Direct.

Light Source: LED 4000K, CRI>80, 50.000h life (@L80, B10, Ta 25 C).

Optical System: Diffuser: 3mm polycarbonate.

Control Gear: LED driver, 220-240VAC-50/60Hz.

Materials: Body: Steel sheet.

Surface Finish: White matt powder coated.

DOZ - Opal polycarbonate diffuser

	LAMP	W	Lm	Lm/W	η(%)	AxBxC (mm)	K1	K3	kg	HF	DALI
	LED	42	6000	97	68	1350x290x66	•	•	15	906H.222.2J.F4	906H.222.2J.E4
		52	7500	100	69	1650x290x66	•	•	18	906H.227.2J.F4	906H.227.2J.E4

DETAILS

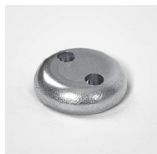

Tamper proof screws

OPTIONS

Special coating

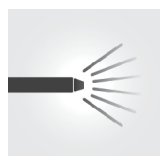

Anti-Graffiti
Anti-Sticker

Order code
under request
under request

Colour temperature



3000K
Tunable white

Order code
3000
T000

Example code for order: 906H.222.2J.E4 (DALI) + 3000 + 926000 + K3 (OPTIONS)

We reserve the right to make technical changes without prior notice.
Electrical/Optical data are subjected to a tolerance of +/-10%.

Light and presence sensor



Option supplied under request.

Security screwdriver bit



Security screwdriver bit

Order code
926000

Emergency unit



Emergency unit 3 hours
Emergency unit 1 hour

Order code
K3
K1

• Test function by telecommand signal.

PHOTOMETRY

DIMENSIONS

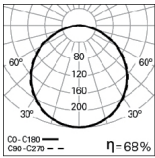

ZLP LED 42W
DOZ 4000K

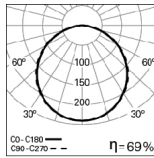

ZLP LED 52W
DOZ 4000K

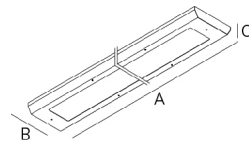

TO SPECIFY:

Luminária anti-vandalismo em LED, IP65, para aplicação de superfície. Aro com difusor em policarbonato opalino de 3 mm e parafusos anti-vandalismo. Junta de estanquicidade em poliuretano. Projetado para resistir a impacto mecânico severo (IK10, 170 Joules). Versão standard com LED 4000K, CRI>80 e 50000h de vida útil (@L80, B10, Ta 25 C). Opção de driver LED com regulação de fluxo DALI. Versão em 3000K, revestimento anti-graffiti e anti-sticker como opção. Sensor de luminosidade e presença e Kit de emergência de 1 ou 3 horas como acessórios – como Roxo Lighting ZLP LED

We reserve the right to make technical changes without prior notice. Electrical/Optical data are subjected to a tolerance of +/-10%.