

**LED**

Norms: EN 60598-1, EN 60598-2-2



IK 06

**PRODUCT DESCRIPTION**

**Areas of Application:** Offices and Meeting rooms, Kitchen, Hospital, Restrooms, Schools, Corridors and Reception areas.

**Mounting:** Ceiling recessed.

**Light Distribution:** Direct.

**Light Source:** LED 4000K, CRI>80, 65.000h life (@L80, B10, Ta 25 C).

**Control Gear:** LED driver, 220-240VAC-50/60Hz.

**Materials:** Body: Steel sheet.  
Diffuser: Opal polycarbonate.

**Surface Finish:** Powder coated in white matt.

**Fixing system:** Lay-in version for exposed "T" grids 15/24mm.

DAM - Microprismatic diffuser

LED	UGR	W	Lm	Lm/W	η(%)	AxBxC (mm)	K1	K3	Kg	HF	DALI
	≤19	47	6440	107	78	595x595x100	•	•	5,2	9Z6F.409.6V.F4	9Z6F.409.6V.E4
	≤19	47	6440	106	77	1195x295x100	•	•	5,0	9Z6F.218.6V.F4	9Z6F.218.6V.E4

DOZ - Opal polycarbonate diffuser

LED	UGR	W	Lm	Lm/W	η(%)	AxBxC (mm)	K1	K3	Kg	HF	DALI
	≤22	47	6440	106	77	595x595x100	•	•	5,2	9Z6F.409.2J.F4	9Z6F.409.2J.E4
	≤22	47	6440	104	76	1195x295x100	•	•	5,0	9Z6F.218.2J.F4	9Z6F.218.2J.E4

**DIMENSIONS**

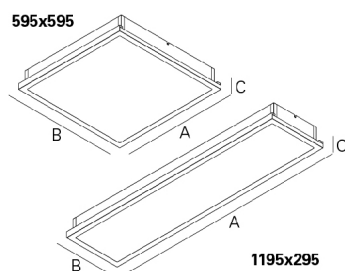

Example code for order: 9Z6F.409.6V.E4 (DALI) +3000 + k3 + 955000 (OPTIONS)

We reserve the right to make technical changes without prior notice.  
Electrical/Optical data are subjected to a tolerance of +/-10%.

**OPTIONS**

**Colour temperature**

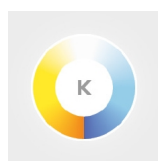

3000K

Order code  
**3000**

**Safety cable**



Steel safety cable

Order code  
**955000**

**IP (Ingress protection)**



IP20/65 version  
Option supplied under request.

Order code

**Emergency unit**



Emergency unit 3 hours  
Emergency unit 1 hour

Order code  
**K3**  
**K1**

• Test function by telecommand signal.

**Low power option**



This option can be supplied on request

**PHOTOMETRY**

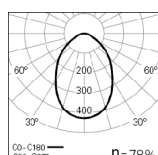

**bLED 47W DAM**  
(595x595mm) 4000K

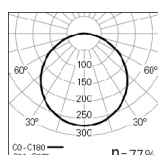

**bLED 47W DOZ**  
(595x595mm) 4000K

**FIXING SYSTEMS**

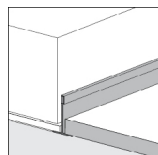

Lay-in version for  
exposed "T" grids  
15/24mm.

**TO SPECIFY:**

Recessed IP20/40 LED luminaire for modular ceilings. Microprismatic or opal polycarbonate diffuser. Standard version with 4000K, CRI>80, total luminous flux of 6440 lm and 65.000h lifetime (@L80, B10, Ta 25 C). Suitable for lay-in version without brackets. Optional DALI dimmable driver, IP20/65 3000K, steel safety cable and 1 or 3 hours emergency unit. – as Indelague bLED.

We reserve the right to make technical changes without prior notice.  
Electrical/Optical data are subjected to a tolerance of +/-10%.